

377775E

377800E

820125N

LEGEND

AV - Air Valve	MH - Manhole
BH - Borehole	MKR - Marker
BOL - Bollard	OSBM - O.S. Benchmark
BT - British Telecom Cover	OHW - Overhead Wires
CL - Cill Level	P - Post
COV - Cover(unknown service)	PM - Parking Meter
COL - Column	PYN - Elec. Pylon
CT - Cable Telecom Cover	RE - Rodding Eye
D - Drain	RL - Ridge Level
EC - Electricity Cover	RS - Road Sign
EL - Eaves Level	SC - Stop Cock
EP - Electricity Pole	SV - Stop Valve
ER - Earth Rod	T - Toby
FH - Fire Hydrant	TCL - Tree Canopy Level
G - Gully	TPIT - Trial Pit
GAS - Gas Cover	TL - Traffic Lights
GT - Gate	TP - Telegraph Pole
IC - Inspection Cover	TV - Cable T.V. Cover
IL - Invert Level	VP - Vent Pipe
LB - Lighting Bollard	W - Water Cover
LL - Lintel Level	WHL - Wall Head Level
LP - Lamp Post	WL - Water Level
	WM - Water Meter

NOTES:

- This drawing is to be read in conjunction with all other drawings and specifications.
- This drawing must not be copied in whole or in part without prior written consent of Cameron + Ross Ltd.

SURVEY NOTES:

- All survey levels are related to Ordnance Survey using GPS.
- Whilst every effort to locate all major service covers (ie manhole positions) it should be noted that this may not be possible in all cases due to ground conditions or local obstructions.



SURVEY STATIONS

Station	Easting	Northing	Height
STN1	377785.740	820114.872	59.870
STN2	377782.433	820124.582	59.698

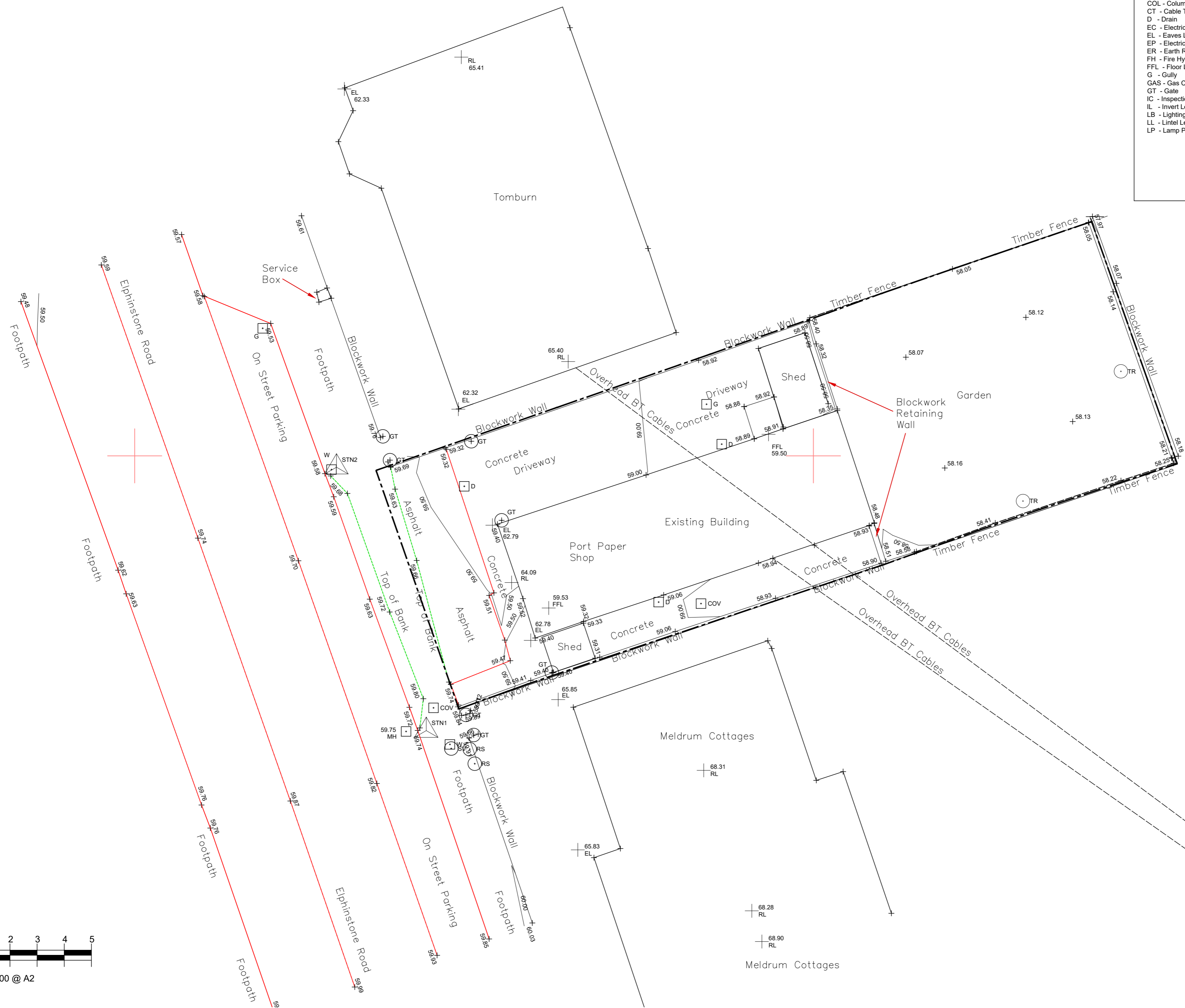
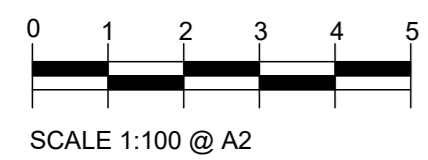

Issue	Revision	Initial	Date

Cameron + Ross
 CIVIL + STRUCTURAL ENGINEERING
 Forbes House | 15 Victoria Street | Aberdeen | AB10 1XB
 1:01224 642 460 | www.cameronross.co.uk
 Mulberry House | 39-41 Harbour Road | Inverness | IV1 1UF
 1:01462 570 100 | www.cameronross.co.uk

Client:
 HM Singh Enterprises

Project:
 Proposed Replacement Shop
 Elphinstone Road
 Port Elphinstone, Inverurie

Drawing Title:
 Topographical Survey

Status:
 Information

Scale: 1:100 @ A2 **Date:** 02/08/22
By: DII **Checked:** JRA **Approved:** DII

Dwg. No.: 220747-000-CAM-DR-G-001 **Rev.:** -