

GENERAL NOTES

- (c) 2019 Sopthem Limited t/a Inspire Architects
- All works proposed shall be conducted in accordance with the related H&S and CDM regulations. Where doubt arises over any aspect of safety, consult Inspire Architects.
- Should any discrepancy be found on this drawing or related project information then the matter should be brought to the attention of Inspire Architects for resolution as soon as possible.
- This drawing may be based on a measured survey or Ordnance Survey information. Do not scale from this drawing unless for planning purposes.
- All dimensions are in millimetres unless otherwise stated. Do not scale from this drawing. All information and layouts detailed on this drawing are subject to site dimension checks.
- Copyright: All Inspire Architects drawings are the property and copyright of Sopthem Limited and are not to be used for any purpose without prior written agreement.

- Site Boundary
- Ownership Boundary

Existing Site Plan Legend:

- EP Electricity pole
- BT Telecoms unit

Existing Footprint 212m²



1 Site Location Plan
1 : 1250

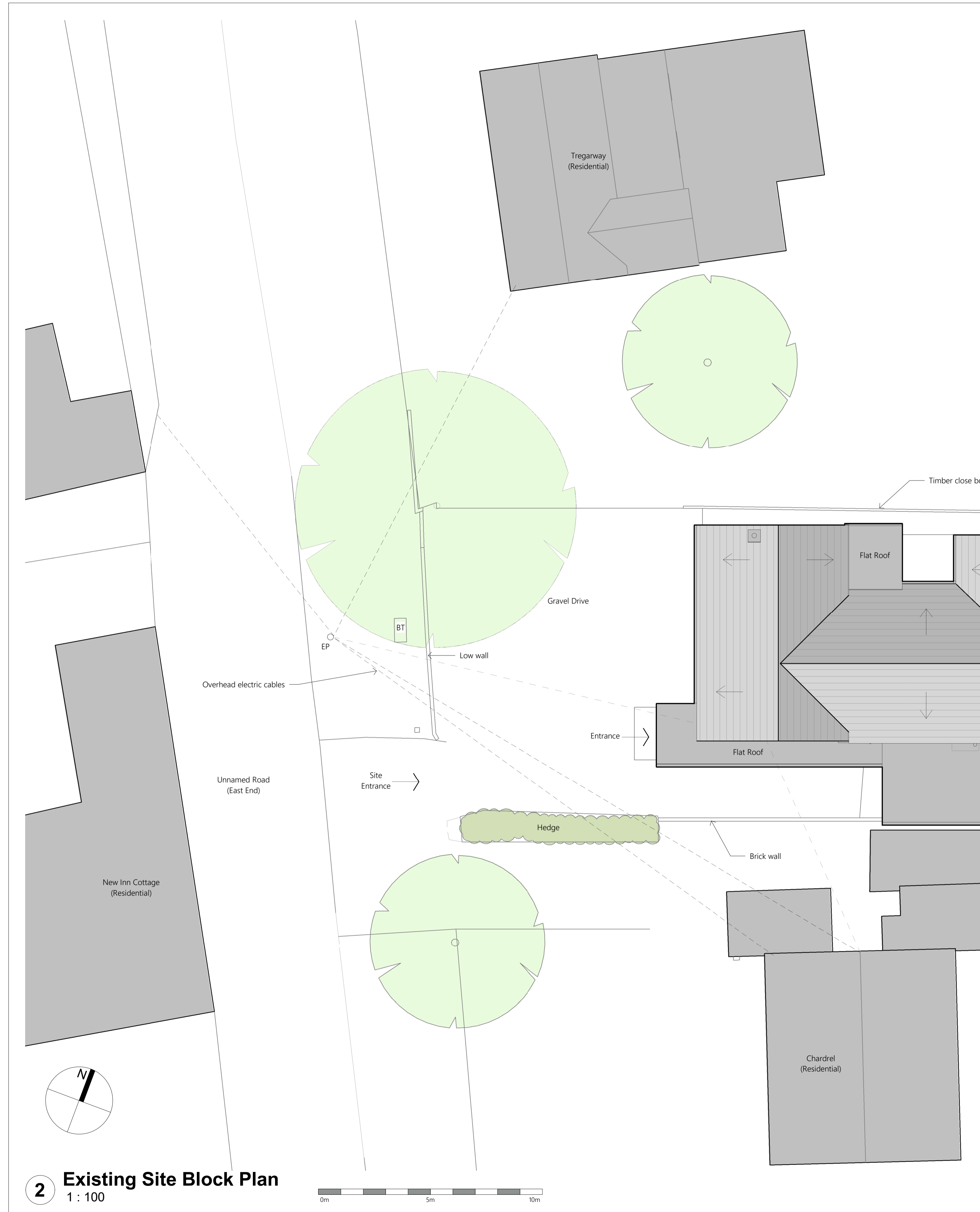

2 Existing Site Block Plan
1 : 100

Revision	Drawn	Checked	Date
P2	DY	NC	14.12.20
P1	DY	NC	10.12.20



PROJECT NAME
 Lynd Hill, East End, Whitney
 OX29 6PZ

CLIENT
 Mr & Mrs Wheeler

SHEET NAME
 Location & Existing Site Plan

STATUS
 Planning

SHEET SIZE
 A1 As indicated @ A1

REVISION DATE
 14.12.20 P2

PROJECT NUMBER
 1923.01

DRAWING NUMBER
 0100