

REPRODUCING THESE DRAWINGS BY PRINTING OR COPYING MAY LEAD TO ERRORS. PLEASE REFER TO SCALE BAR. DO NOT SCALE OFF THESE DRAWINGS FOR CONSTRUCTION PURPOSES. IF ANY DISCREPANCIES ARE FOUND, PLEASE CONTACT WESTERN DESIGN ARCHITECTS IMMEDIATELY.

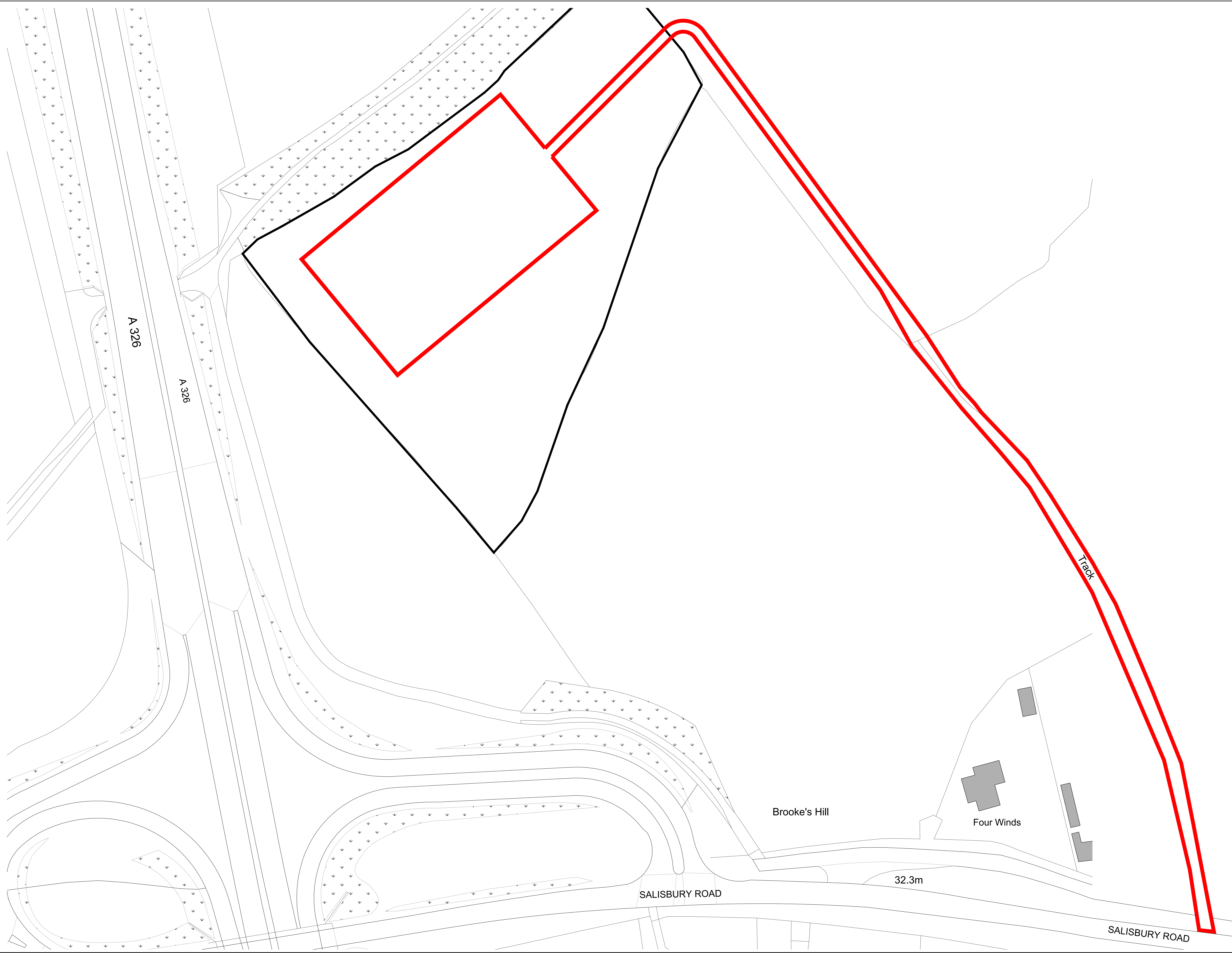
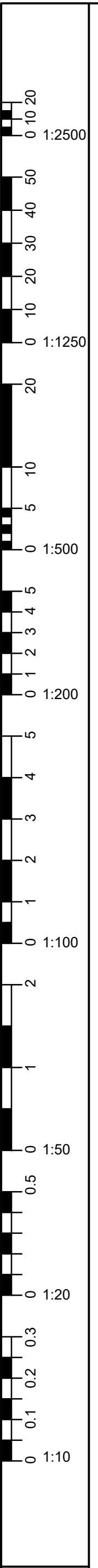

DESIGNERS RISK ASSESSMENT - HEALTH AND SAFETY
 THE CONSTRUCTION (DESIGN AND MANAGEMENT) REGULATIONS 2015

A design and risk assessment Drawing (CDM01) should form part of our drawing package. If you have not received this from us by post, email or by collection please contact us for a copy before moving forward with the project.

- NOTES FEASIBILITY SKETCHES**
- Please note: this sketch is based on limited information and subject to the following list of constraints, reports and exercises that should be completed as soon as possible to confirm the validity of this feasibility (this list is not exhaustive):
- 1) Site Ownership
 - 2) Topographical survey
 - 3) Tree constraints plan by qualified consultant
 - 4) Local and utility searches
 - 5) Local policies and constraints, e.g. flood zones, SSSI, conservation areas etc.
 - 6) Ecology
 - 7) Ground Contamination

- NOTES PLANNING**
1. Planning drawings are only to be used for planning purposes & no reliance on compliance with Building Regulations should be assumed.
 2. With regard to Fire Safety Design all layout details and indicated construction materials are subject confirmation by a specialist fire consultant prior to construction. Material choices are for planning purposes only and, for performance details subject to confirmation by a Specialist Fire Consultant (Fire system technical detailing should also be non-combustible A1 or A2 (read and agreed with the consultant)).



4	Rev for submission to Salisbury Hill	MT	MT	11.05.2022
3	Added to site, back sheet	MT	MT	29.05.2022

REV: REVISION DETAILS BY: CHD DATE



Western Design Architects
 12 The Granary, Hinton Business Park, Tarnet Hinton, Dorset, DT11 8LP
 T: 01208 800073 E: info@westerndesign.co.uk

CLIENT
 Roger & Michael Street & Maureen Hutchinson

PROJECT
 Brooks Hill Farm

DRAWING TITLE
 Existing Site Plan

DRAWN BY: MT RECHECKED BY: MW DATE: 11.05.2022

SCALE: 1:500@A0 JOB NO: 2122152

DRAWING NO: 02 REVISION: B

PLANNING

THIS DRAWING IS COPYRIGHT © Western Design Ltd 2022