

Area analysis

GIA m2

GF: 75 m2

Materials:

Roof: natural slate 30 degree pitch  
Walls: red brickwork

Parking:

2 x 2.8 x 5.0m designated spaces per dwelling



G1 Gravel - self binding porous gravel driveway with cellweb stabiliser system

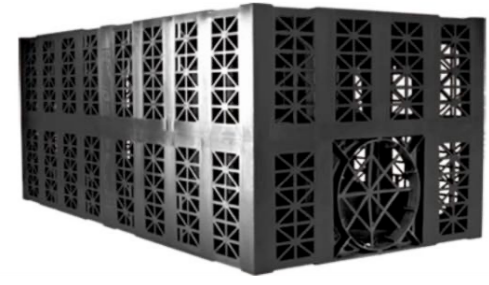

A1: Below ground attenuation system

Urbanscape Green Roof System

Urbanscape is an innovative, lightweight and easy to install system with high water retention capacity designed specifically for green roofs on residential, non-residential and industrial buildings in urban areas.

Urbanscape Green Roof is a complete system, which consists of a Root Membrane, Drainage System with buffer, Green Roll Substrate (made of Knauf Insulation's unique, patented and specially needed virgin Rock Mineral Wool) - and a Sedum mix vegetation layer.

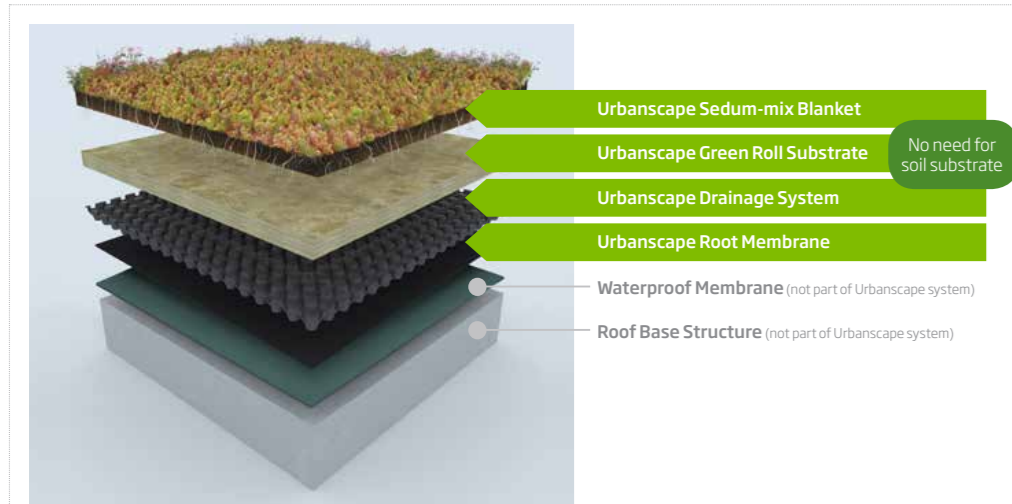

Types of roofs

Urbanscape Green Roof System can be installed on any type of roof construction on timber, steel, or concrete deck, inverted roof construction or any other type of material used on roofs. The green roof elements are the same in all cases, only the demands on the insulation and the position of waterproof membrane change.

Applications

Urbanscape is light enough to be installed in all these applications.

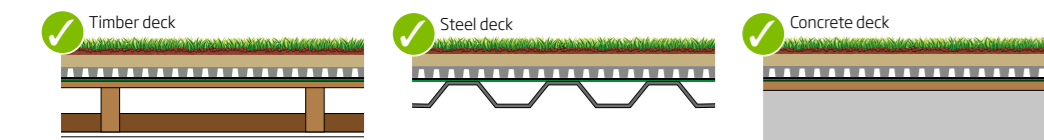

PROPOSED ROOF & SITE PLAN

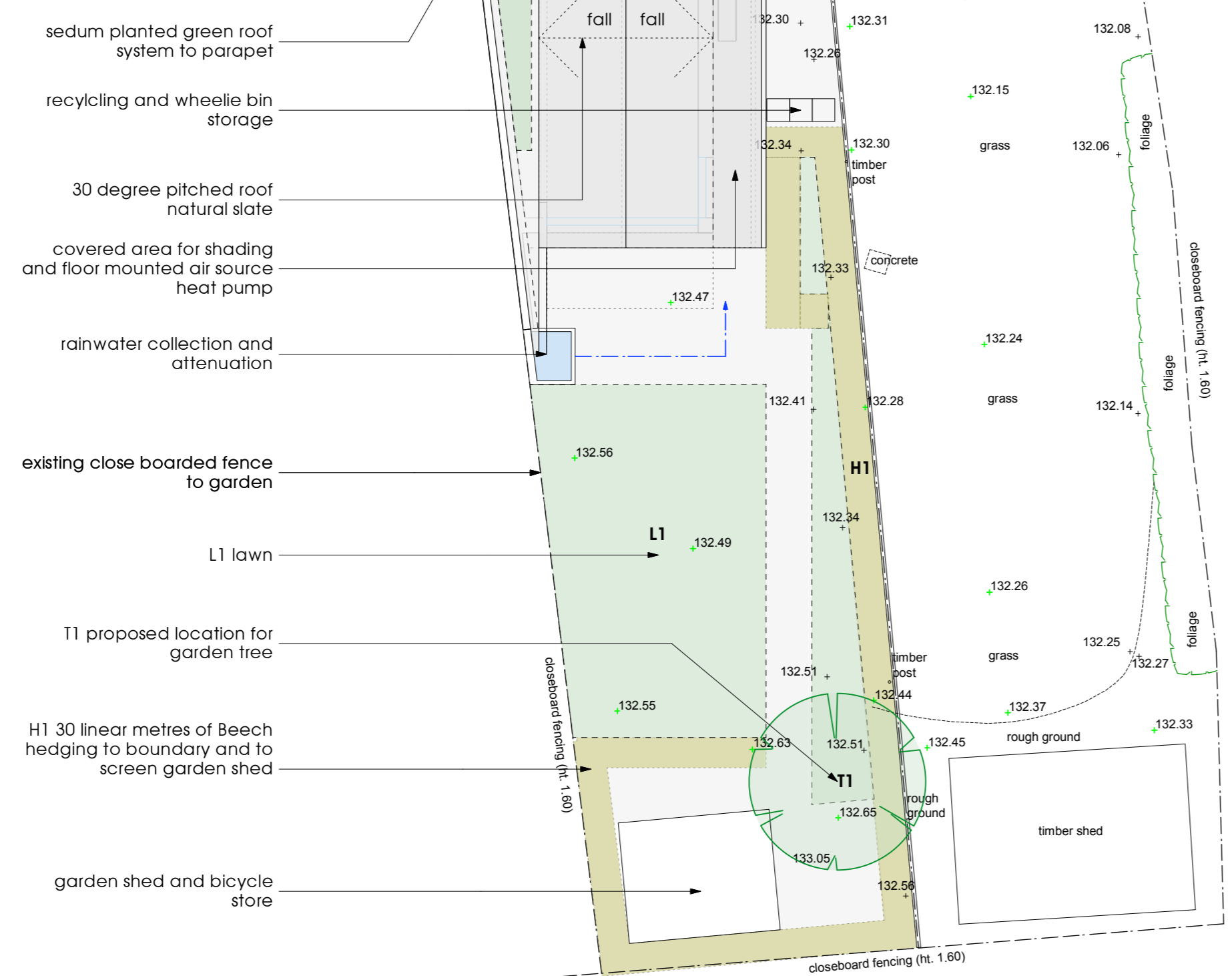

- sedum planted green roof system to parapet
- recycling and wheellie bin storage
- 30 degree pitched roof natural slate
- covered area for shading and floor mounted air source heat pump
- rainwater collection and attenuation
- existing close boarded fence to garden
- L1 lawn
- T1 proposed location for garden tree
- H1 30 linear metres of Beech hedging to boundary and to screen garden shed
- garden shed and bicycle store

Landscape schedule:

- H1: New species rich hedge  
Mix: 60 - 90 cm (21 pots)  
Crataegus Monogyna (Hazel)  
Acer campestre (Field Maple)  
Viburnum opulus (Guelder Rose)  
Viburnum lantana (Wayfaring Tree)  
Euonymus europaea (Spindle)  
Density: 5 per m

- L1: Lawn  
General purpose seed mix, perennial ryegrass, tall fescue, red fescues and browntop

- T1: small garden tree  
Sorbus aucuparia (Rowan)

- T2: small garden tree  
Sorbus aucuparia (Rowan)

- T3: Betula pendula (Silver Birch)



T1 & T2



T3

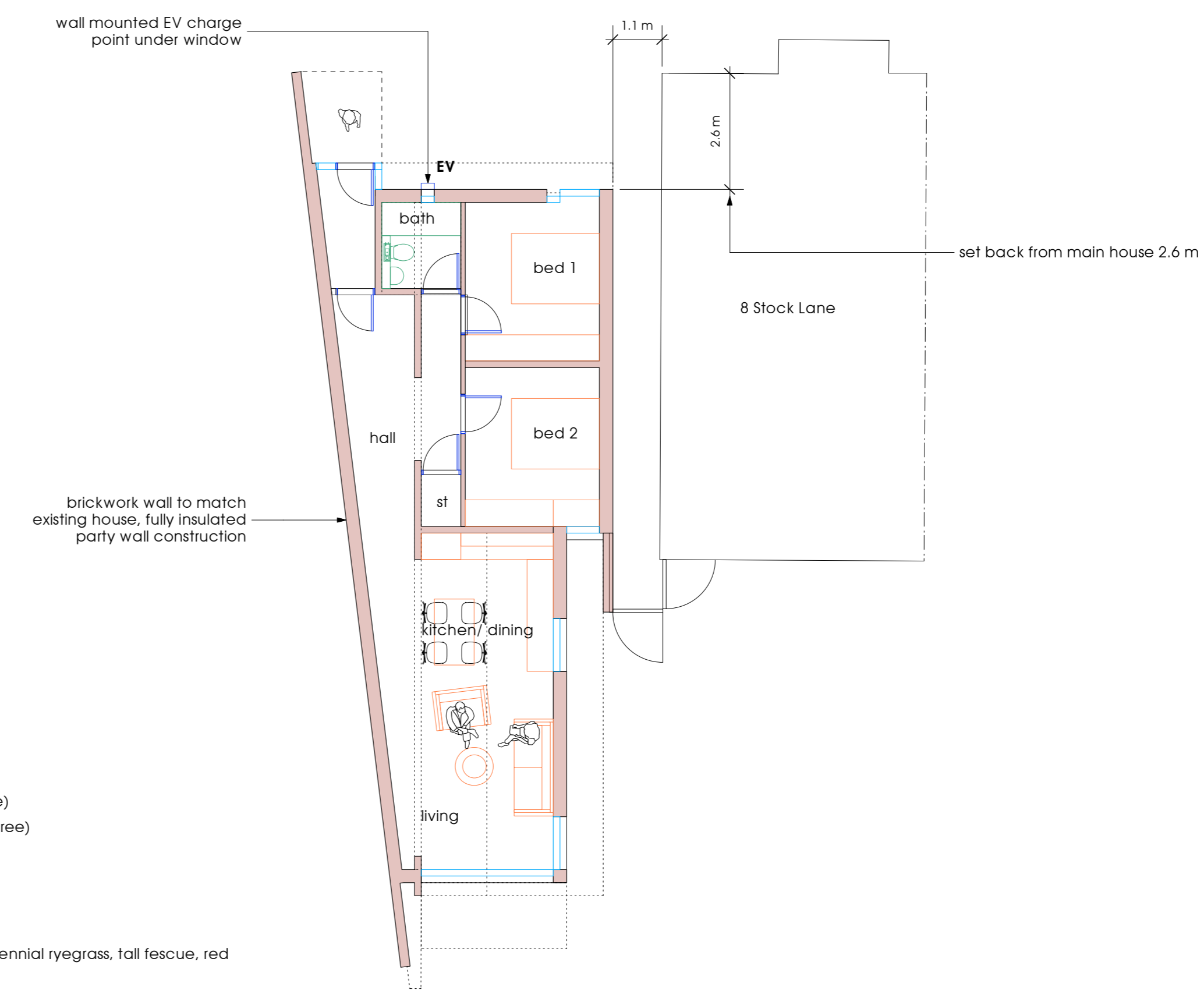

PROPOSED GROUND FLOOR PLAN

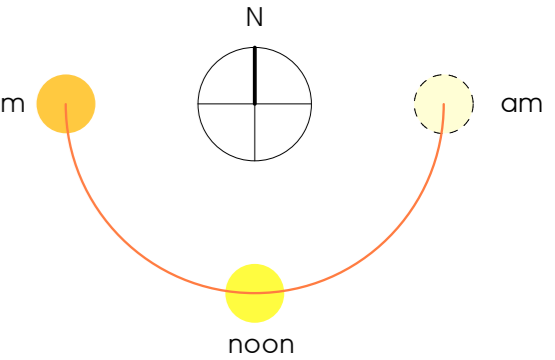

NEW DWELLING

8 STOCK LANE, WHADDON, MK17 0LS

Peter Hudec

Drawn by: - Checked by: - Scaled by: - e Copyright GA

Title: PROPOSED SITE & GF PLAN

Scale: 1:100 @ A1 Date: 20 JULY 2022

Project No: 21-22

Stage Drawing No:

3-051

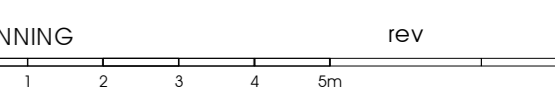

GRINDLEY ARCHITECTS

7 Lissel Road Simpson Milton Keynes MK6 3AX  
t - 01908 668919  
e - info@grindleyarchitects.co.uk  
RIBA Chartered Practice  
www.grindleyarchitects.co.uk

