

Section B-B

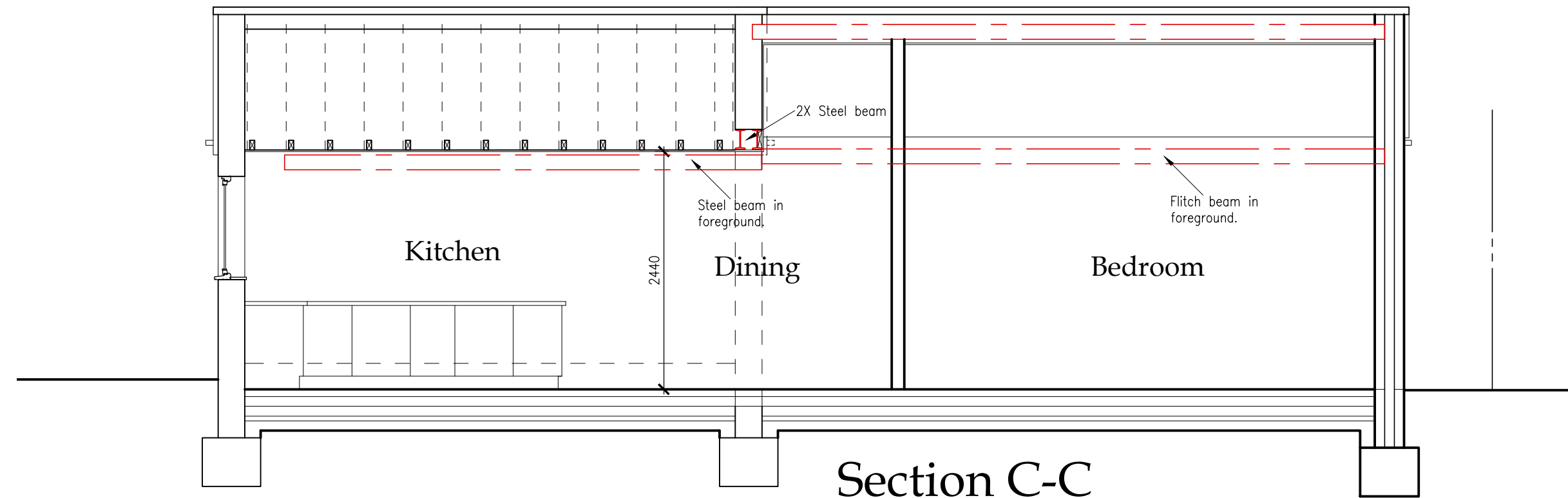

Section C-C

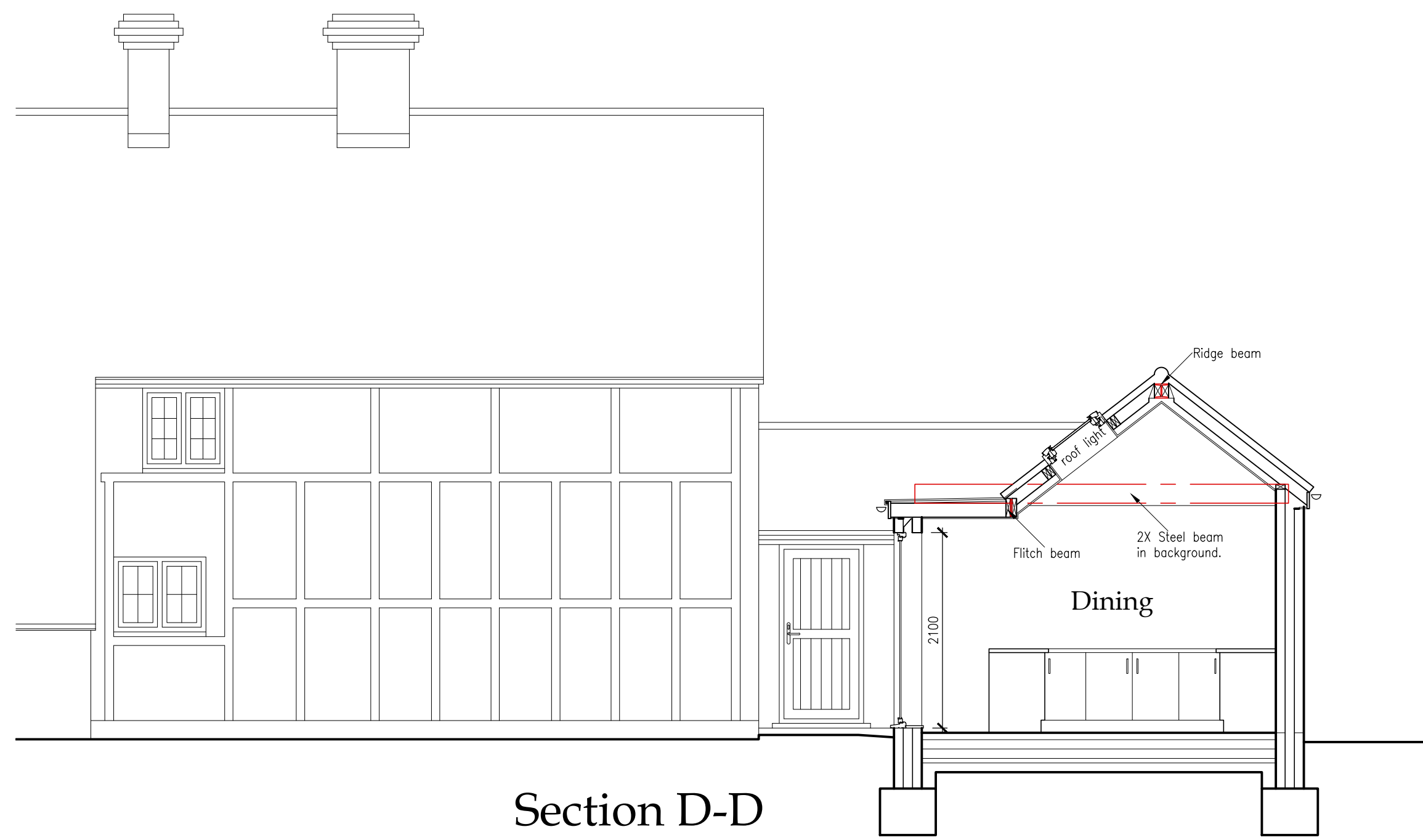

Section D-D



Section E-E

all dimensions to be checked on site as work commences and any discrepancies or omissions reported immediately.

client Mr. & Mrs P. Payne,  
Whitney Box Cottage,  
Church Street,  
Maids Moreton, MK18 1QE.

job title: Proposed Single Storey Front and Rear Extension.

dwg title: Proposed Sections.

dwg. no: 2022042-PL-012 drawn by: PG scales: 1:50 @ A1

revision suffix: - status: **Planning** date: May 2022

Rev.	Description	Date
-	-	-
-	-	-
-	-	-

**KINGSWOOD DESIGN RESIDENTIAL LTD**

ARCHITECTURAL AND DEVELOPMENT CONSULTANTS

P.O. Box 2211,  
Buckingham,  
MK18 9DA.



Tel: 01582 476404

C.A.B.E

VAT Reg. No. 338 0209 20

www.kdr.org.uk  
enquiries@kdr.org.uk