

**EXISTING SOUTH ELEVATION**

Scale: 1:100



**EXISTING EAST ELEVATION**

Scale: 1:100

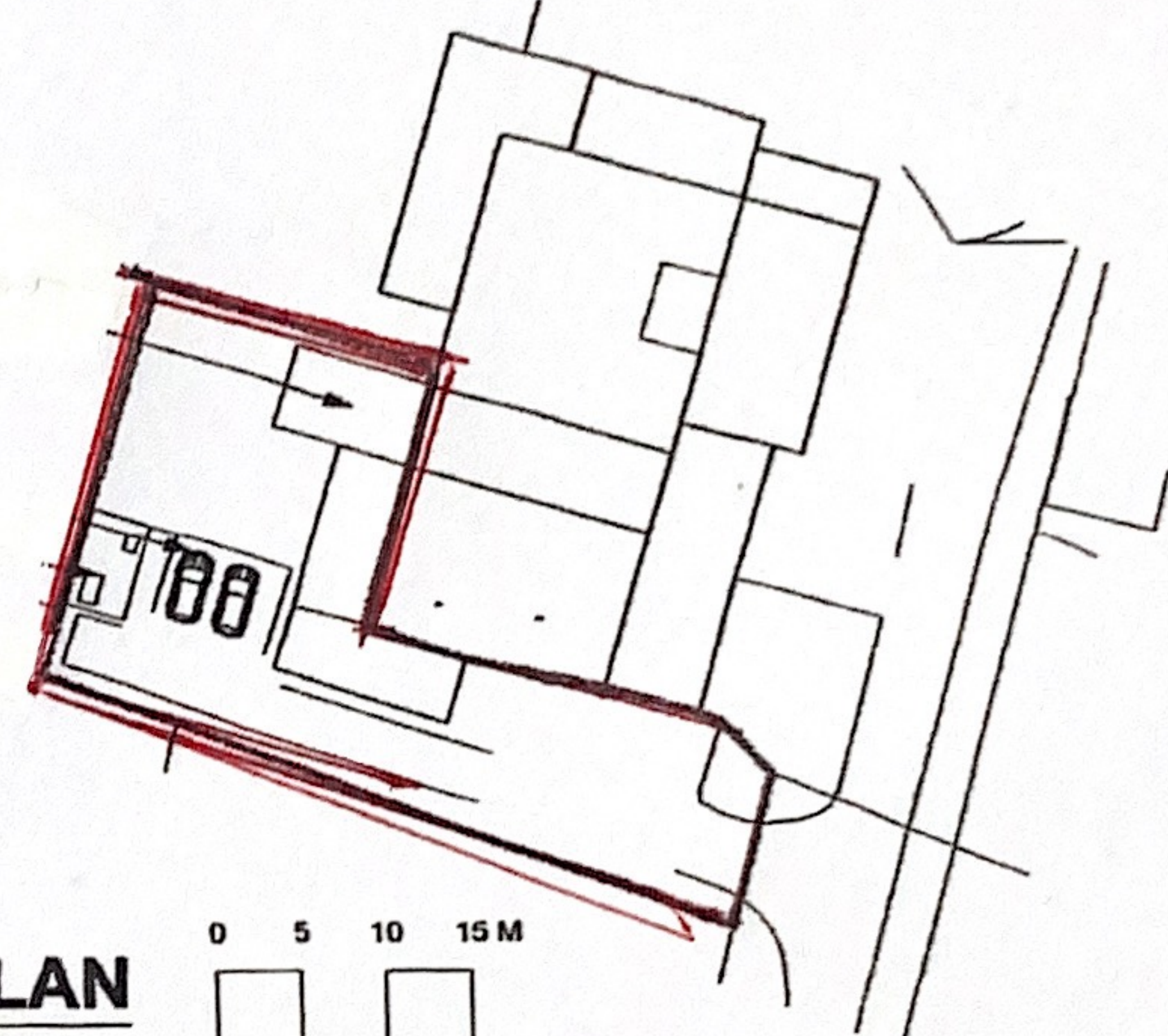
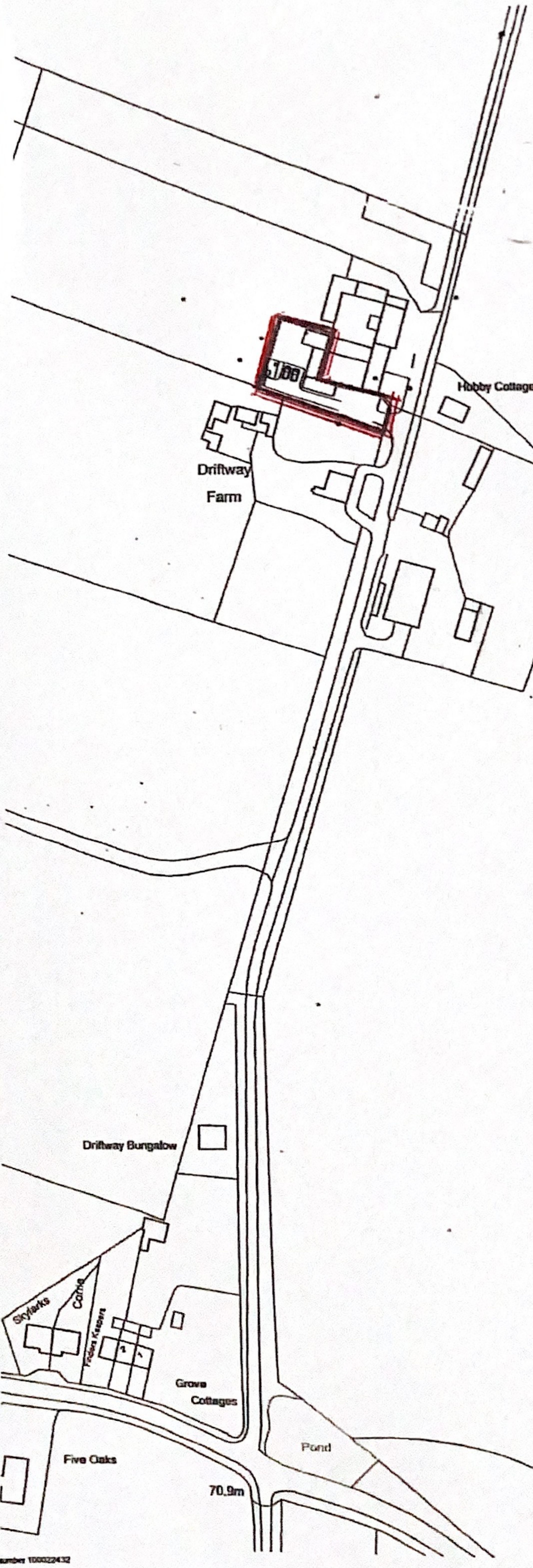

**SITE PLAN**

Scale: 1:500

B	Oil tank/boiler added	29.04.19
A	Car parking added	04.03.19

**MIKE LEE ARCHITECTURAL SERVICES**  
 10 Shipden Avenue, Cromer, Norfolk, NR27 9BD  
 Telephone: 01263 510396  
 Mobile: 07765 148 064  
 Email: mike.ra.lee@gmail.com

Project Paddock Cottage, Drift Cottage Farm, Felbrigg Proposed Extension to Dwelling For J Neethling	
Existing Floor Plans & Elevations	
Date December 2018	
Scale As Indicated @A1	Drawing ref. 2018/320 01B

**I PLAN**

