

GENERAL NOTES:

THE COPYRIGHT OF THIS DRAWING AND THE INFORMATION DEPICTED REMAINS WITH THE DESIGNER.

This drawing shall not be scaled except for planning purposes.

All dimensions shall be checked on site prior to commencing the works or preparing specialist's drawings, with any discrepancies reported to the Designer immediately for clarification.

This drawing to be read in conjunction with all relevant drawings, documents and supporting information prepared by the Designer's, other Consultants and specialists.

All materials and workmanship shall conform to the relevant British Standards or Codes of Practice.

The Designer takes no responsibility for the contractor/client changing any of the building materials or changing the design of the structure in any way from what is specified or shown on these drawings.

All dimensions are in millimetres unless noted otherwise.

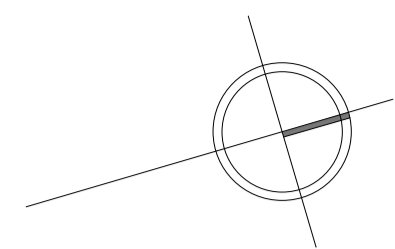

boundary

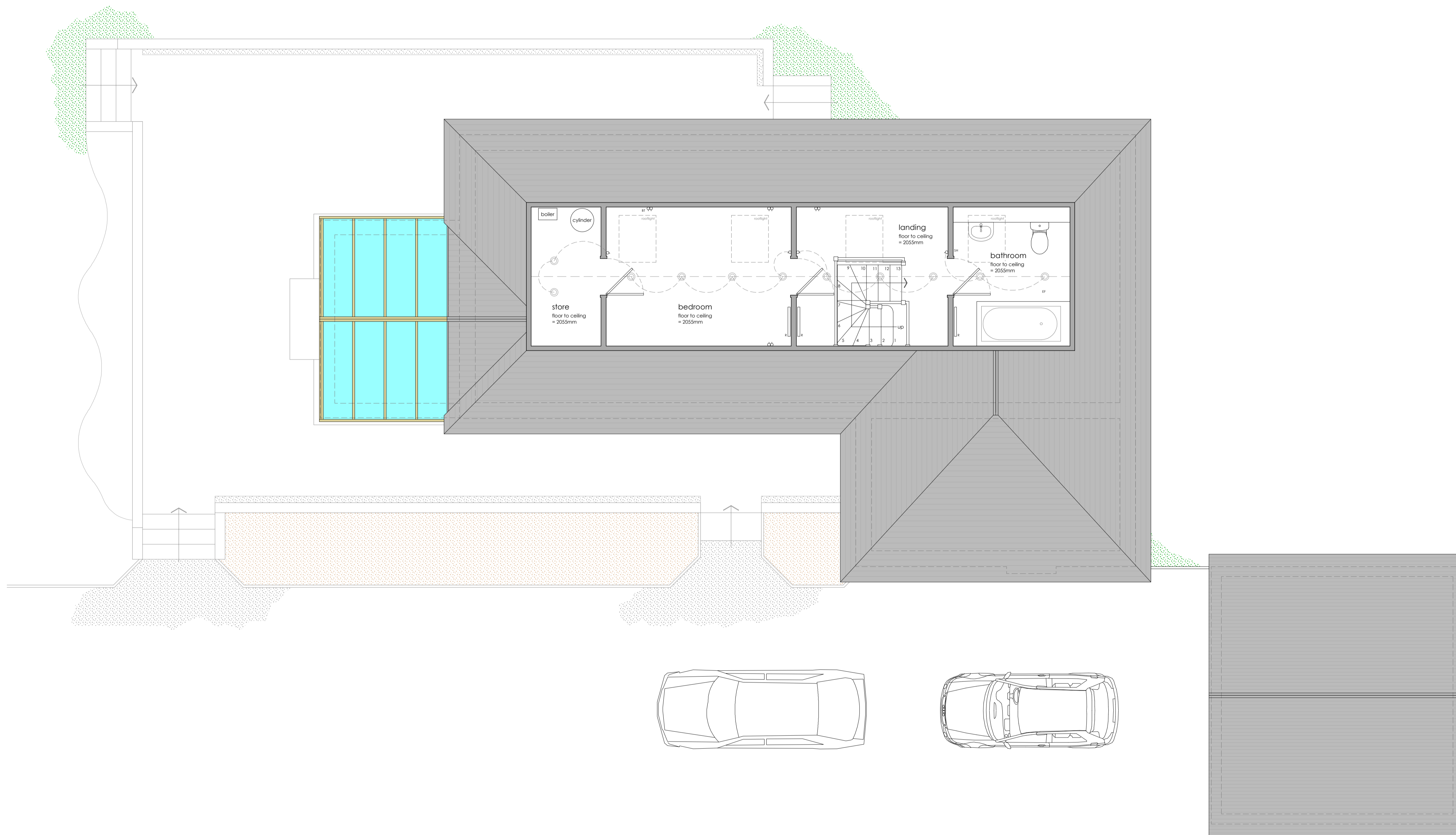

The Lawsons, Shenstone, DY10 4BZ

PROJECT

EXISTING/CURRENT FIRST FLOOR PLAN

DRAWING

1:50 @ A1

SCALE SIZE

Rev	Description	By	Date	Rev	Description	By	Date

CW21/LDC110 **Lawful Development Certificate - Existing Use**
PROJECT AND DRAWING NO. STATUS
Mr Carl Webber
CLIENT

54 Woodfield Terrace
Kidderminster
DY11 6TU
tel 07414627980

WHITING
ARCHITECTURE