

MEADOW BANK

MP

Paddock  
(CPH-03/066/0029)

DUCK LAKE

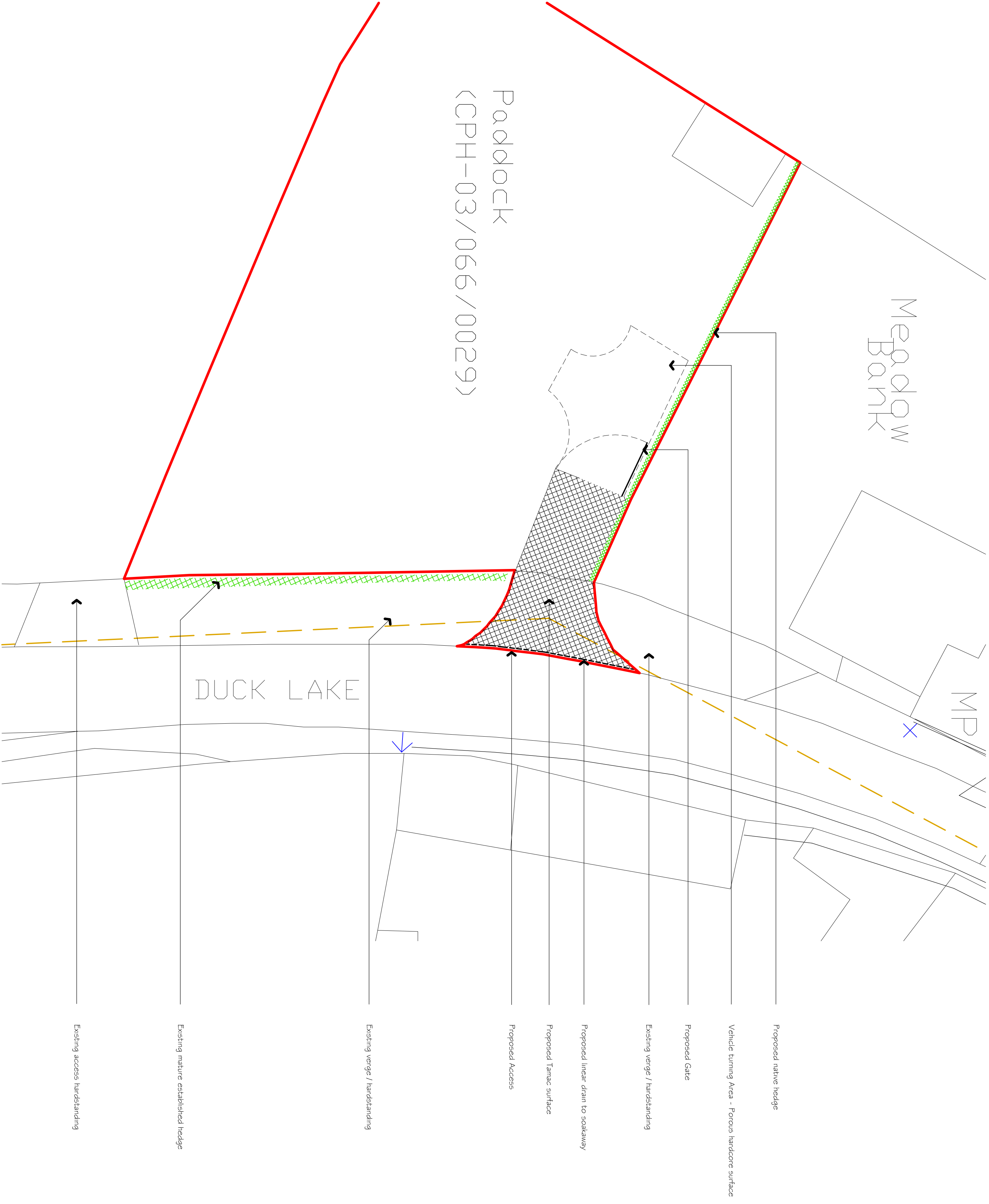

- Proposed native hedge
- Vehicle turning Area - Porous hardcore surface
- Proposed Gate
- Existing verge / handstanding
- Proposed linear drain to soakaway
- Proposed Tamac surface
- Proposed Access
- Existing verge / handstanding
- Existing mature established hedge
- Existing access handstanding

## PLANNING

Planning and Building Regulations Design Consultants  
Architectural Technologists  
Local Authorities Planning Agent Group Member  
Local Authorities Building Control Partner Member  
Planning Portal Professional Status  
Landmark and Planning Member  
Planning Appeal Consultants

[www.cadmonkies.co.uk](http://www.cadmonkies.co.uk)  
[cadmonkies@btconnect.com](mailto:cadmonkies@btconnect.com)  
01280 - 70 44 44



Head Office : The Beethams, 19 Westminster Court,  
BRACKLEY, Northants, NN13 7ED  
London Offices : Studio 82, Heathrow Road,  
Thornton Heath, London, SW14 8JQ  
Cadmonkies Studio 82 Castle Yard,  
Richmond, LONDON, TW10 6TF

**CLIENT:**  
Mrs E Tyson  
**ADDRESS:**  
Paddock (CPH-03/066/0029)  
Duck Lake, MAIDS MORTON, MK18 1RF  
**CONTACT:**  
Mrs E Tyson  
**SITE:**  
Paddock (CPH-03/066/0029)  
Duck Lake,  
MAIDS MORTON, MK18 1RF

**SCHEME:**  
Proposed Paddock Access with  
External Works.

**DRAWING TITLE:**  
Location, Block and Site  
Plan

**DATE:** December 2021  
**SCALE:** 1:200  
**DRAWN:** david henrius  
**REV:**

**DRAWING No:**

P/21/364/004