

③ Floor Plan Drawing

Summer House
Windy Ridge, Hale, SP6 2NW
Scale 1:100
September 2022

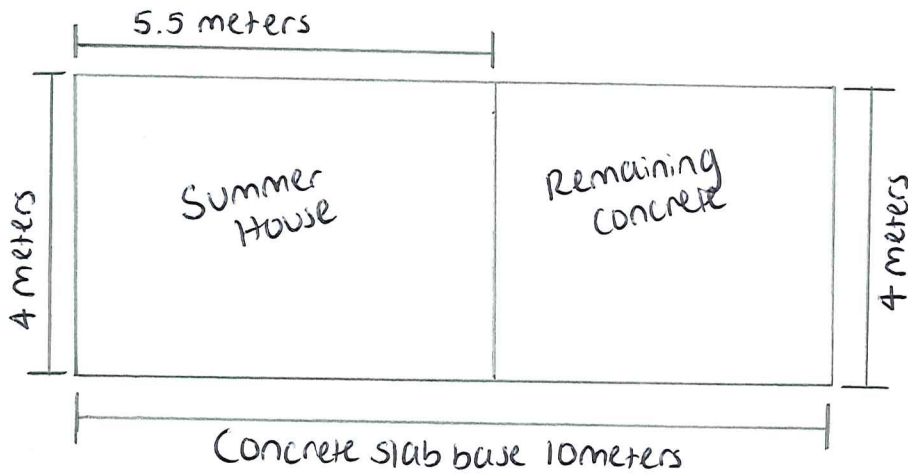
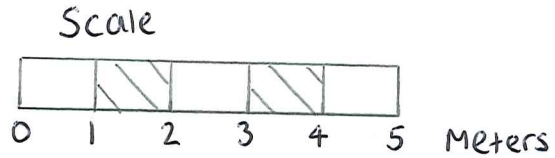

- Concrete slab base will be a maximum of 10 meters by 4 meters to replace existing concrete base and extend into west side of the garden for the Summer House. Please see attached aerial picture within application
- Remaining concrete will be used to put a hot tub on when finances allow
- Existing wire fencing will be replaced with timber post and rail to match the fencing surrounding the remainder of the property
- Summer house will be 1 meter in from West Fence Boundary and tight to the South Fence Boundary.