

This document references the following file:-

Reference Name	Status	Revision
PC-XX-XX-M3-Designer-0001_5746		P01.1

Revisions	Date	Drawn /	Chk'd
P01 First Issue	21/06/22		AO/MG
P02 PLANNING	25/08/22		AO/MG

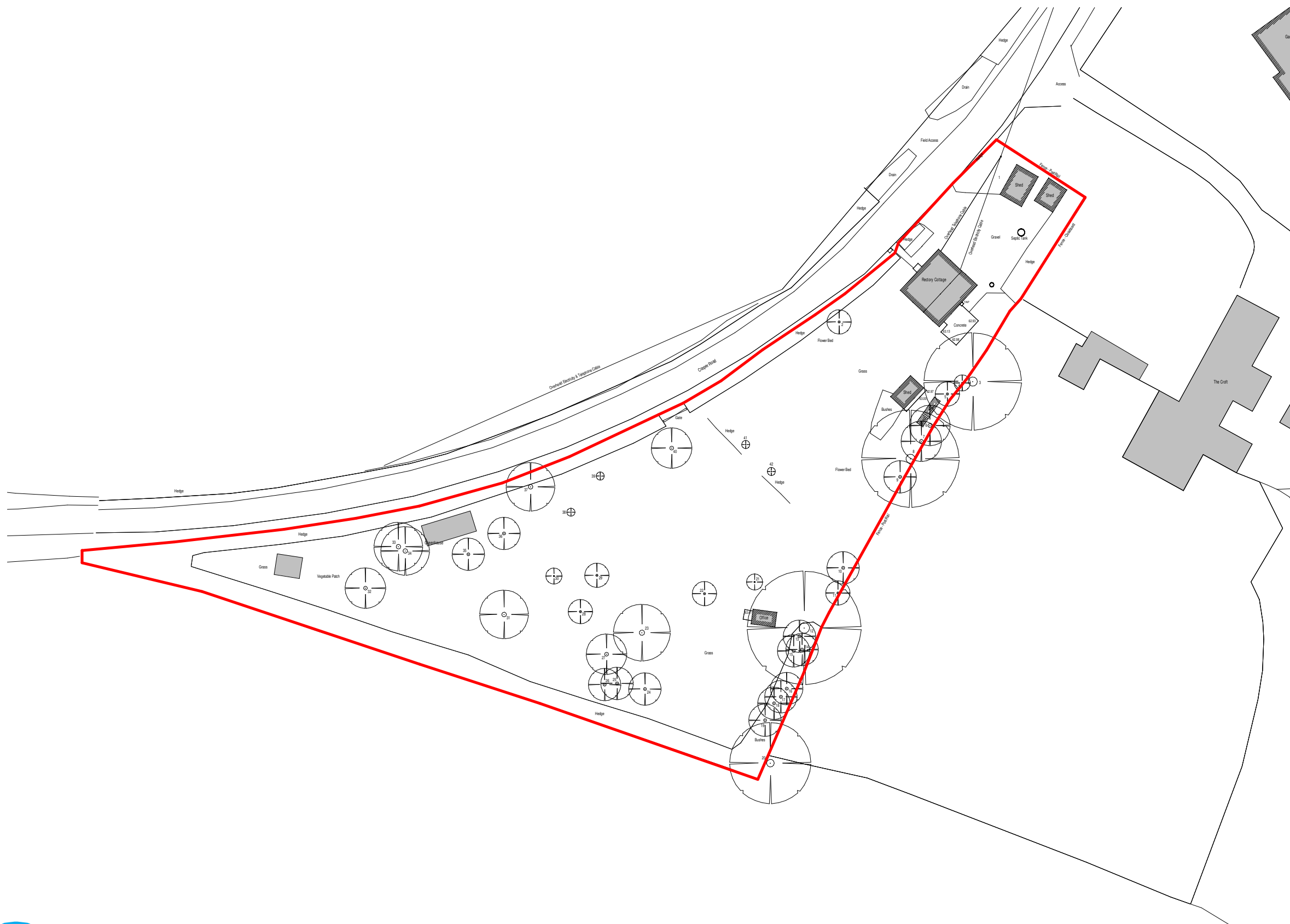

Client

Sam Jackson

Project

Proposed demolition and redevelopment of Rectory Cottage Cooper Rd Gosbeck IP69SN

Title

Block Plan as Existing

Project N^o Drawing N^o Revision

5746 - 0101 P02

Scale - unless otherwise stated Issued For

1 : 500 @ A3 PLANNING

BS 1192 Ref. Status

PC-Designer-0101



Block Plan as Existing

1 : 500

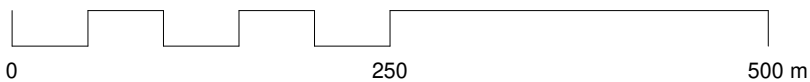

The Old Steelyard
Poplar Lane
Sproughton
Ipswich
IP8 3HL
t: 01473 689 532

www.klharchitects.com