

WINGFIELD BARNS +
ST ANDREW CHURCH
CAR PARK.

EXISTING CAR PARK FOR WINGFIELD BARNS + ST ANDREW CHURCH. CHURCH ROAD, WINGFIELD IP21 5RA.		
DATE: 8.8.2012	SCALE: 1:200 @ A3 No: 001	DRAWN: LUKE HEPSON.

0 2 4 6 8 10 M.
SCALE 1:200 @ A3.

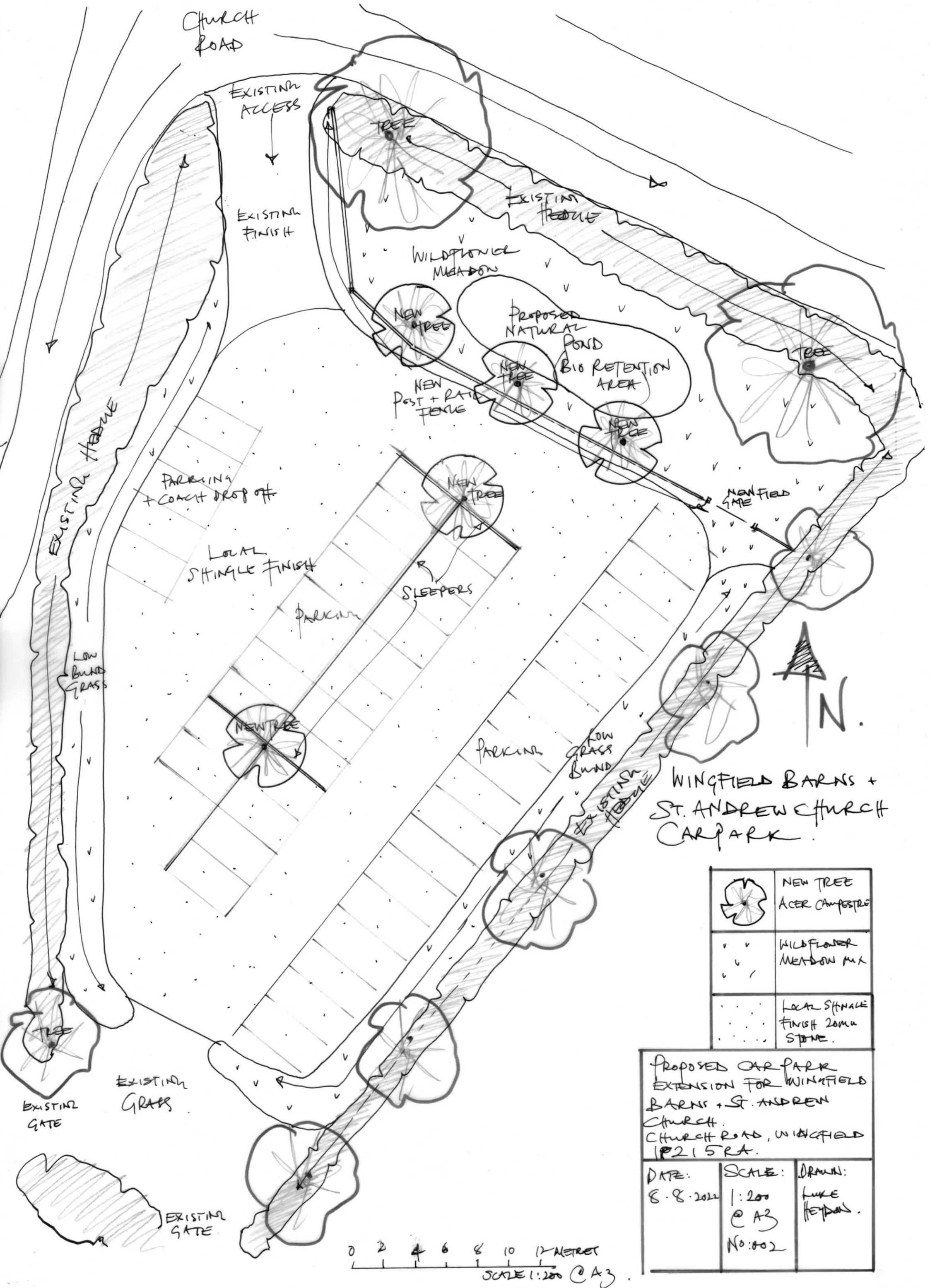

Church Road

EXISTING ACCESS

EXISTING FINISH

TREE

EXISTING TREE

WILDFLOWER MEADOW

NEW TREE

PROPOSED NATURAL POND

BIO RETENTION AREA

NEW POST + RAIL FENCE

NEW TREE

NEW TREE

TREE

PARKING + COACH DROP OFF

LOCAL SHINGLE FINISH

SLEEPERS

NEW FIELD GATE



WINGFIELD BARNS + ST. ANDREW CHURCH CARPARK

	NEW TREE ACER CAMPESTRE
∨ ∨ ∨	WILDFLOWER MEADOW MIX
∴ ∴ ∴ ∴ ∴	LOCAL SHINGLE FINISH 20mm STONE.

PROPOSED CAR PARK EXTENSION FOR WINGFIELD BARNS + ST. ANDREW CHURCH.
CHURCH ROAD, WINGFIELD IP21 5RA.

DATE: 8.8.2012	SCALE: 1:200 @ A3 No:002	DRAWN: LUKE HEPBURN.
-------------------	-----------------------------------	-------------------------

0 2 4 6 8 10 12 METRES
SCALE 1:200 @ A3

EXISTING GATE

EXISTING GRASS

EXISTING GATE

PARKING

LOW GRASS BUND

EXISTING TREE

EXISTING MEADOW

LOW BUND GRASS

PARKING

WINGFIELD BARNES + ST. ANDREW CHURCH CAR PARK.

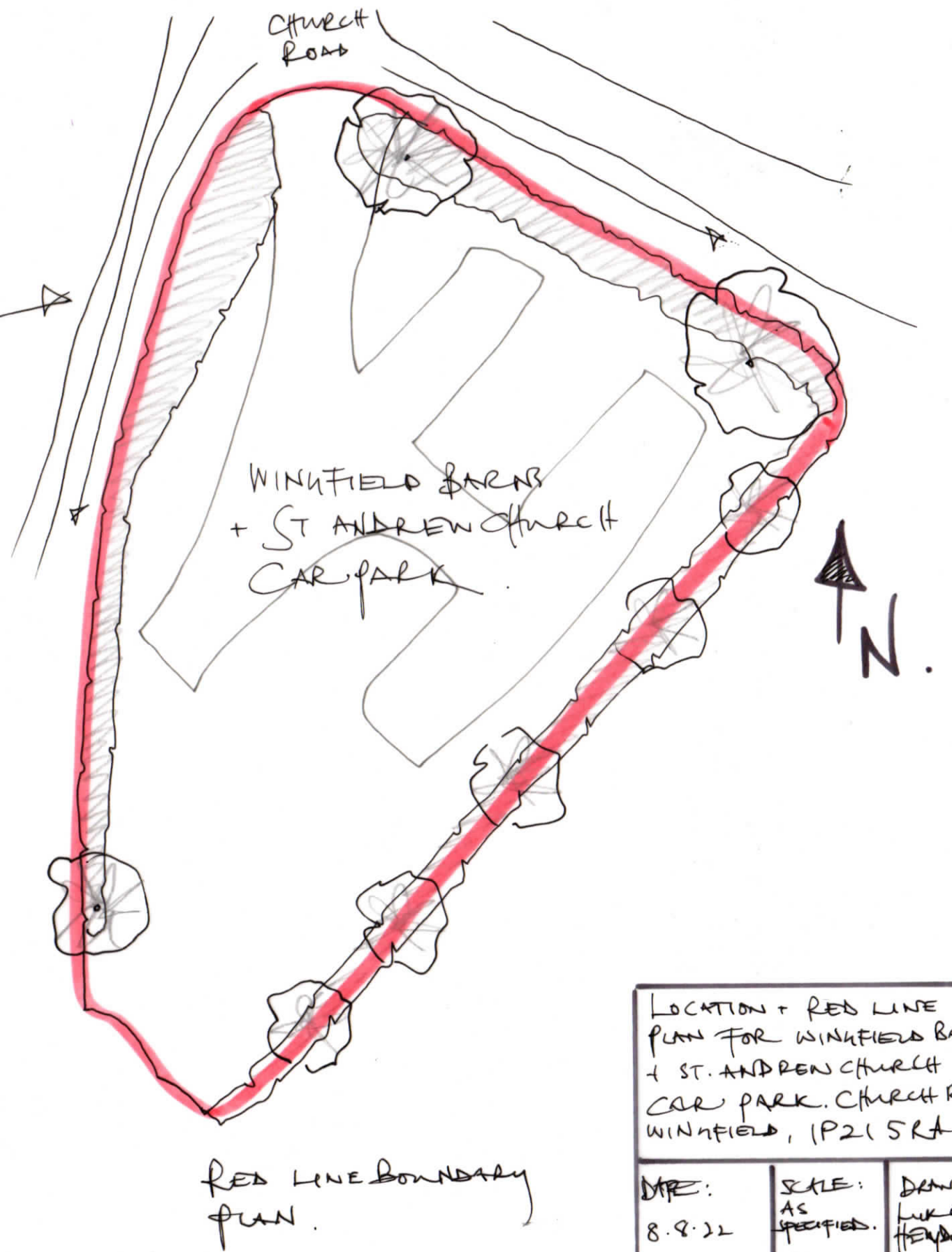
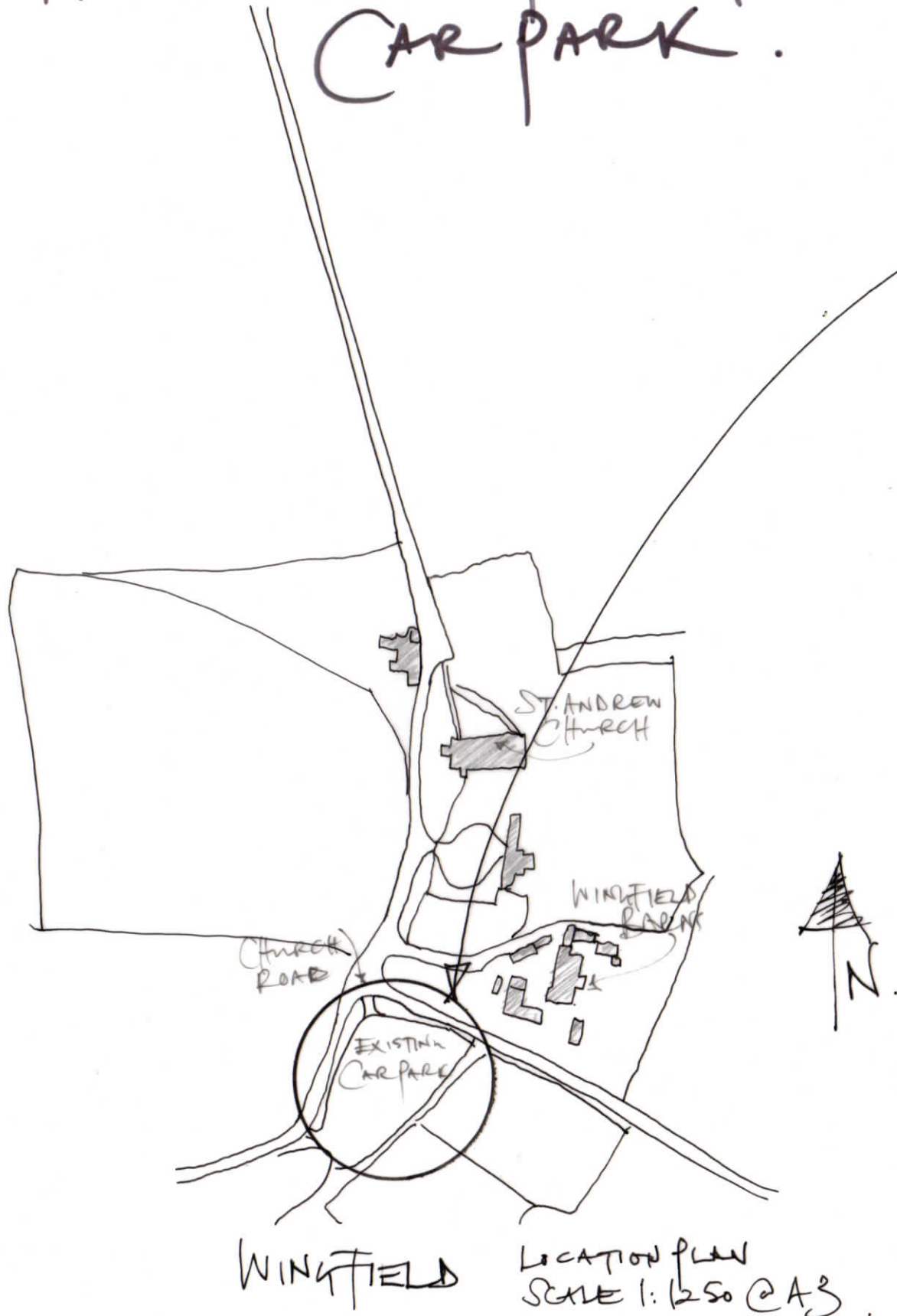

LOCATION + RED LINE PLAN FOR WINGFIELD BARNES + ST. ANDREW CHURCH CAR PARK. CHURCH ROAD WINGFIELD, IP21 5RA.		
DATE: 8.8.22	SCALE: AS SPECIFIED. NF:013	DRAWN LUKE HENDON