

This drawing is to be read in conjunction with all other contract drawings and specifications

Do not scale from this drawing. All dimensions are in millimetres and all levels are in metres unless noted otherwise. All existing dimensions are approximate and must be checked on site prior to fabrication and construction. If any information is unclear or ambiguous seek the advice of the Contract Administrator before proceeding.

The Contractor is to ensure that the works comply with all current Building Regulations, British and European Standards and all other relevant legislation. For Contractor Designed Works this drawing represents design intent only subject to development by the Contractor in accordance with the requirements of the contract.

The contractor is to review and observe all recommendations of the Asbestos Refurbishment Survey Report. The contractor must alert the Contractor Administrator to any asbestos discovered during the course of the works and agree an appropriate course of action before proceeding.
© Solihull Metropolitan Borough Council 2016

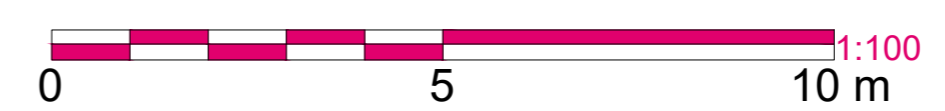
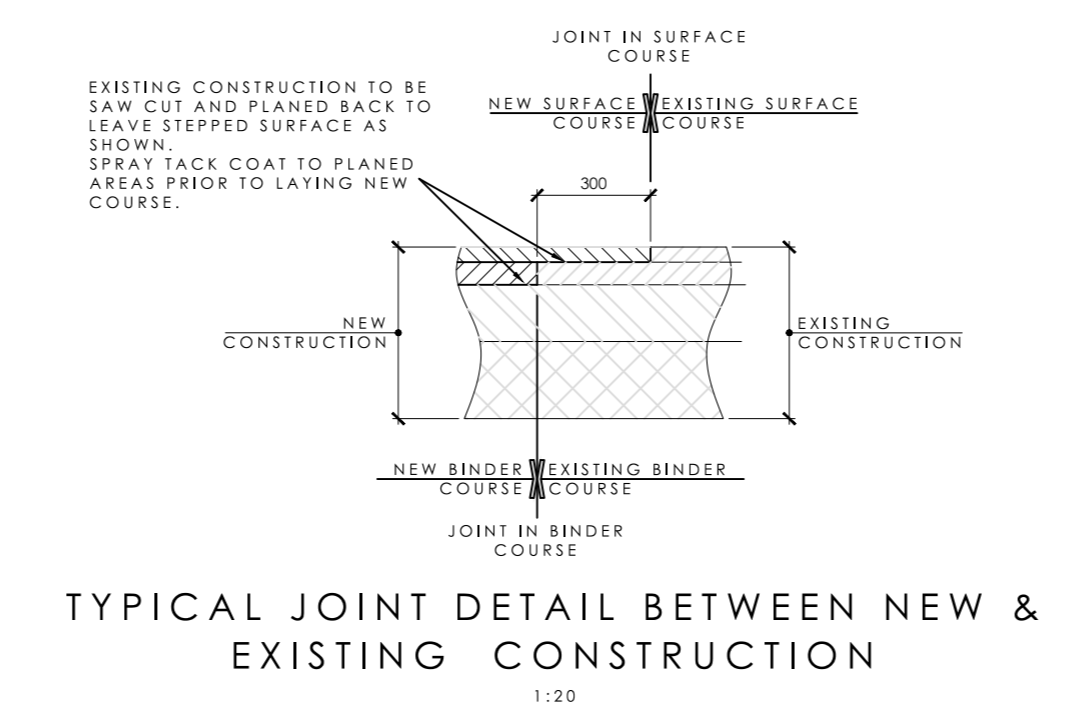
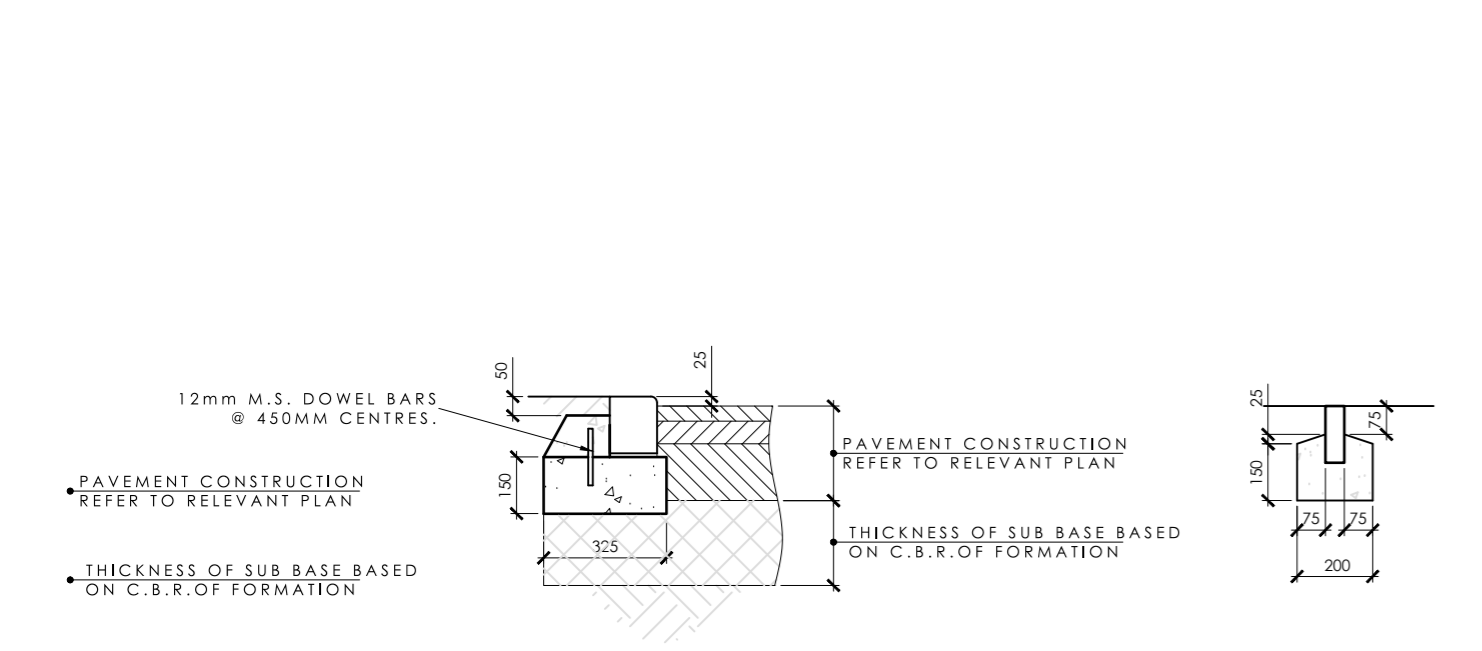
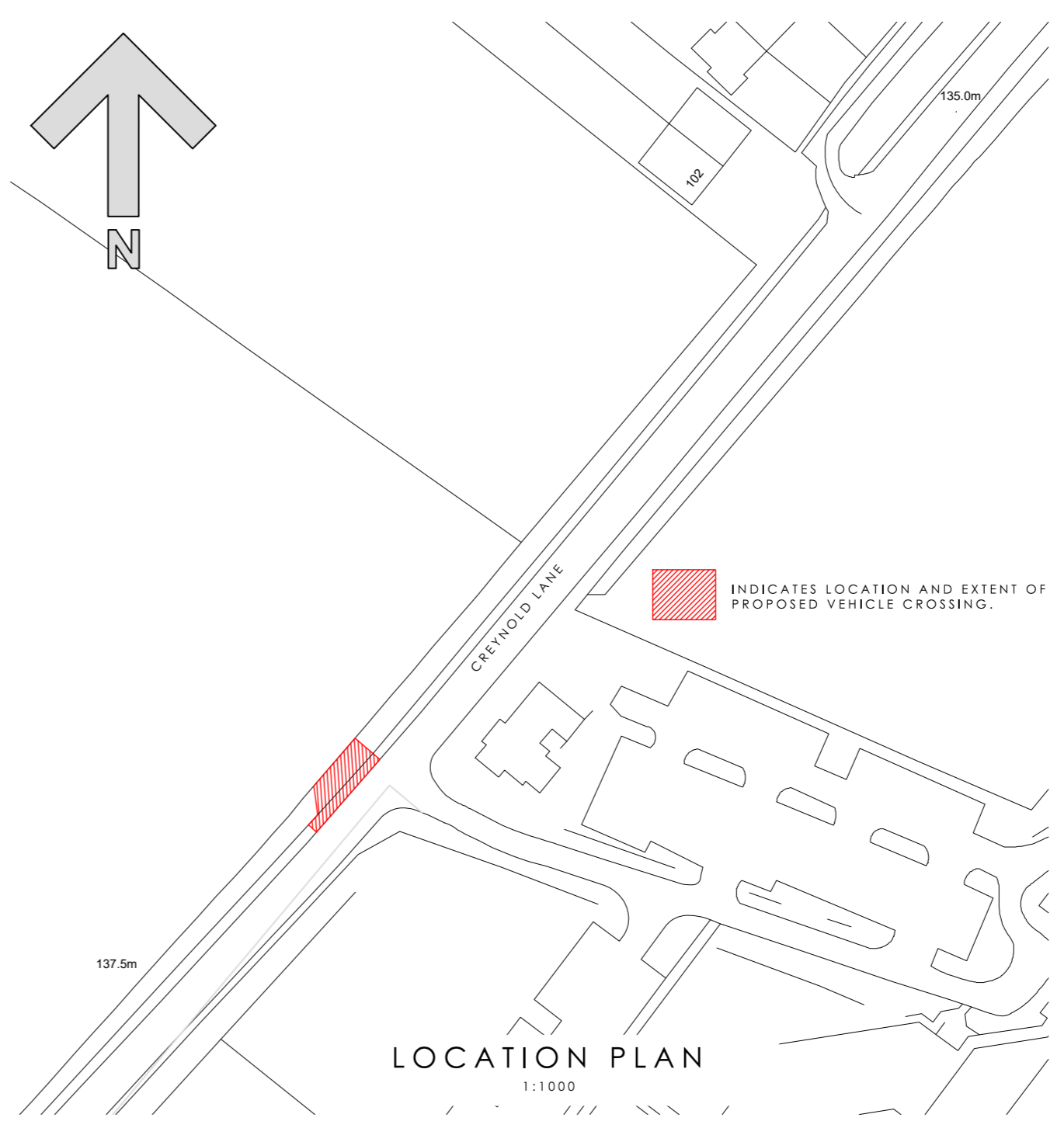
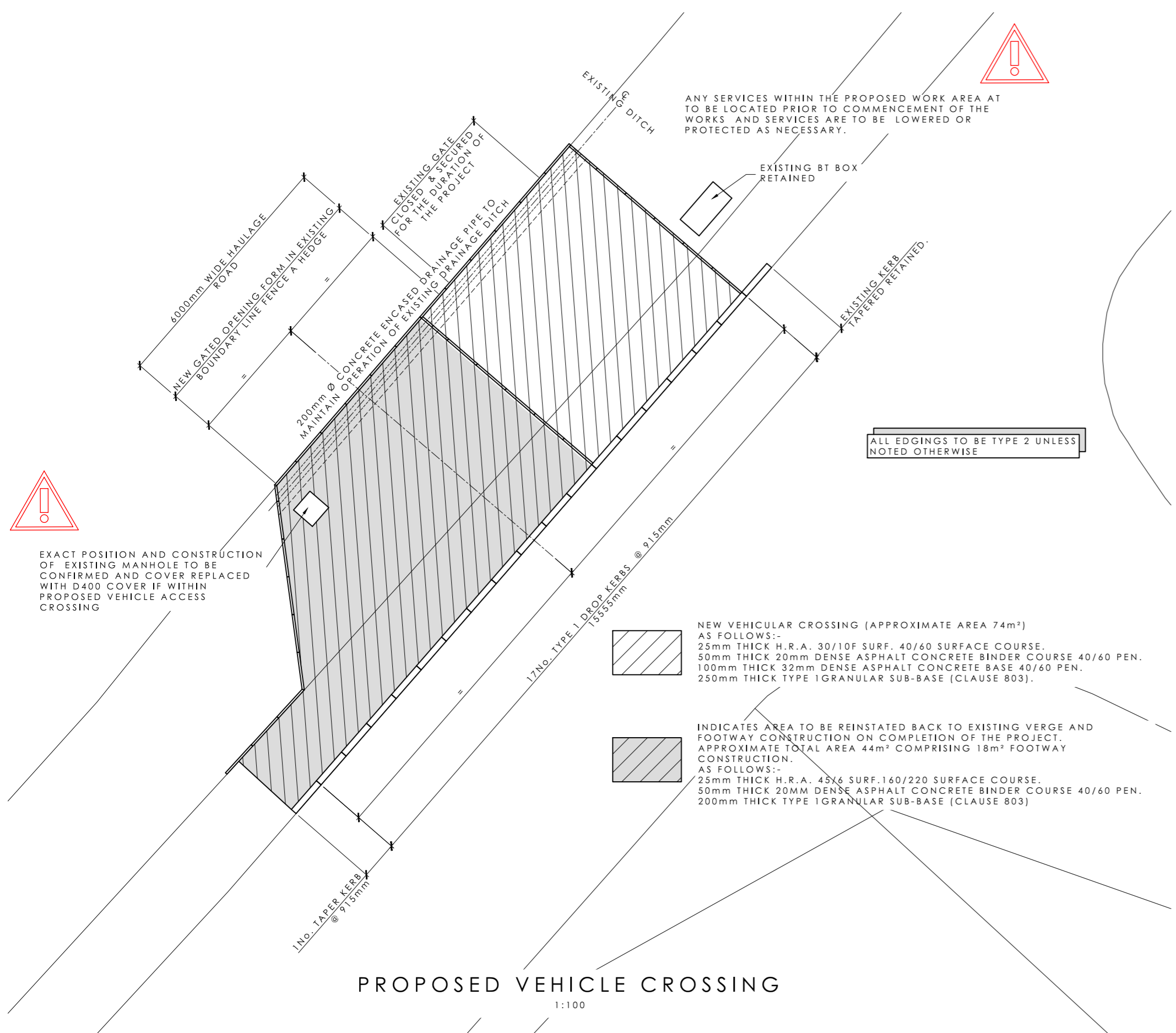

Rev	Description	Date
-----	-------------	------



Council House, Manor Square, Solihull, West Midlands B91 3QR
www.buildingdesignstudio.co.uk
Tel. 0121 704 6454

CLIENT
SAST

PROJECT
CHESWICK GREEN PRIMARY SCHOOL

TITLE
PROPOSED VEHICLE CROSSING PLANNING LOCATION

DRAWN BY WSP	CHECKED BY N/A	DATE Aug 2022
PROJECT NUMBER 17011	SCALE REF. TO DRG	PAPER SIZE A2
DRAWING NUMBER 17011-BDS-XX-XX-DR-C-6012		STATUS REV S3 P01

PURPOSE OF ISSUE
APPROVAL