

Drainage Strategy - Scale (1:100)

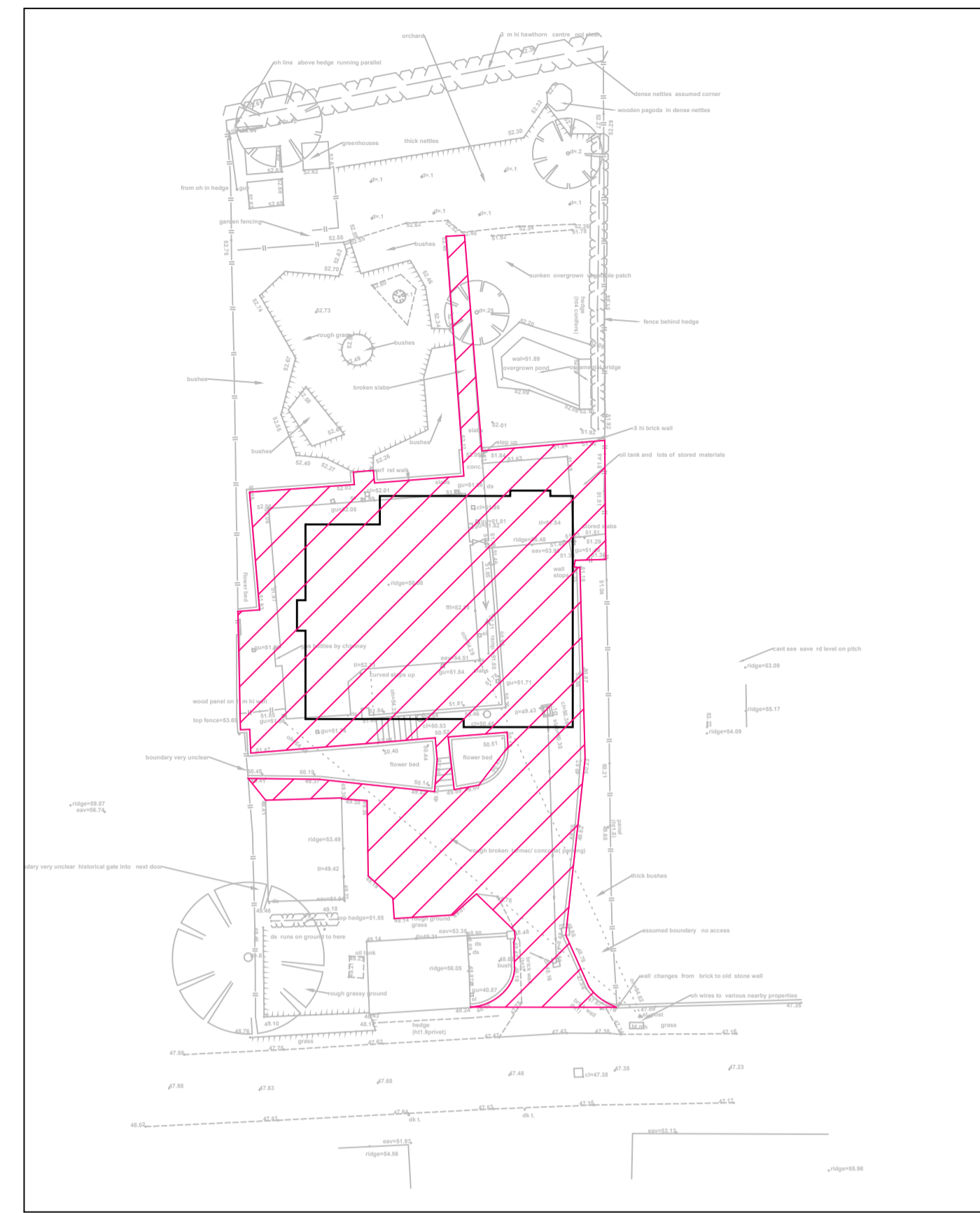

Existing Impermeable Area Plan = 701m² - Scale (NTS)

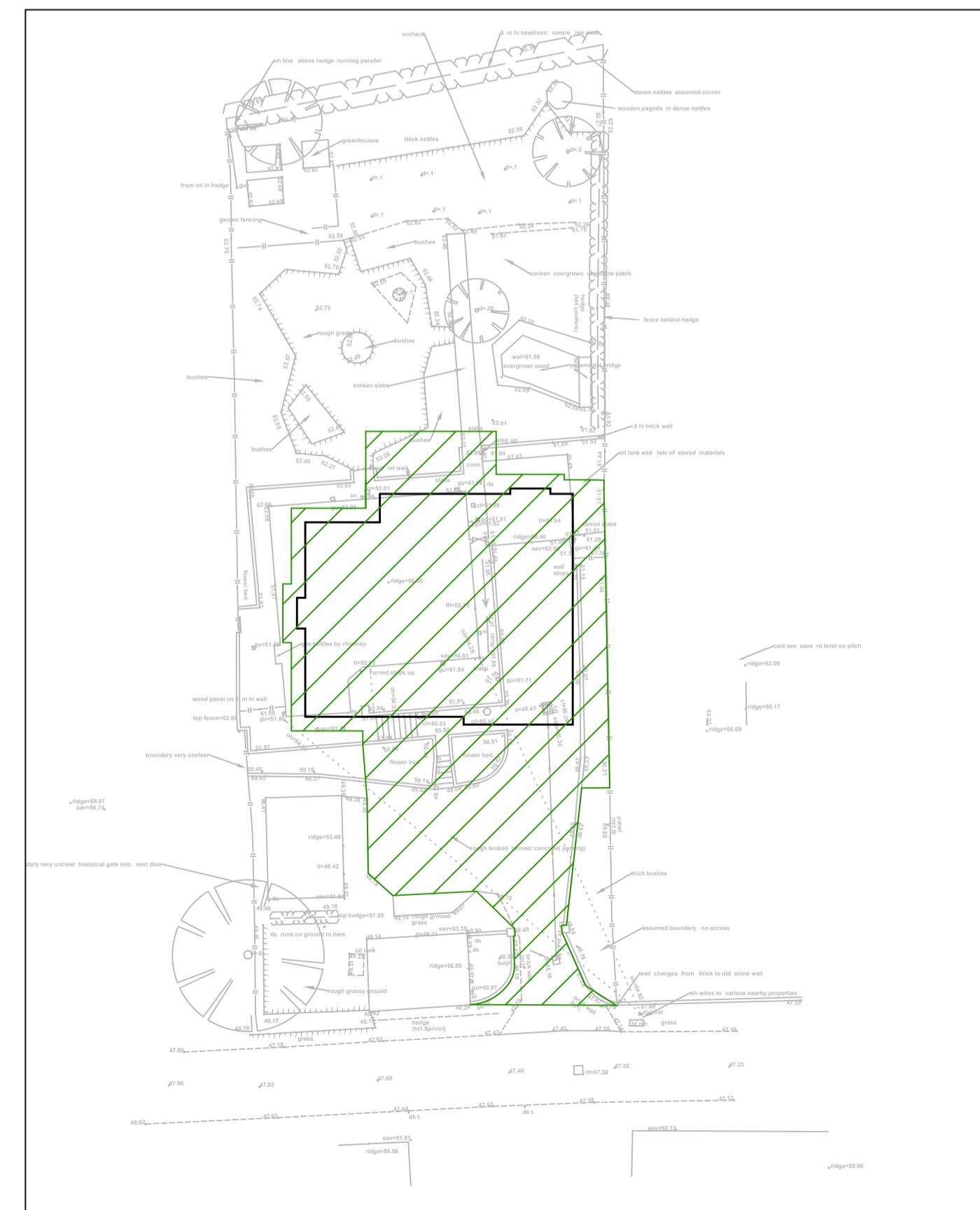

Proposed Impermeable Area Plan = 645m² - Scale (NTS)

This drawing is copyright of Topping Engineers LTD and must not be copied or reproduced in anyway without written consent.
DO NOT SCALE OFF THIS DRAWING

- Notes:**
1. This drawing is to be read in conjunction with all relevant architect's and engineer's drawings.
 2. It is assumed that all works will be carried out by a competent contractor working, where appropriate, to an approved method statement.

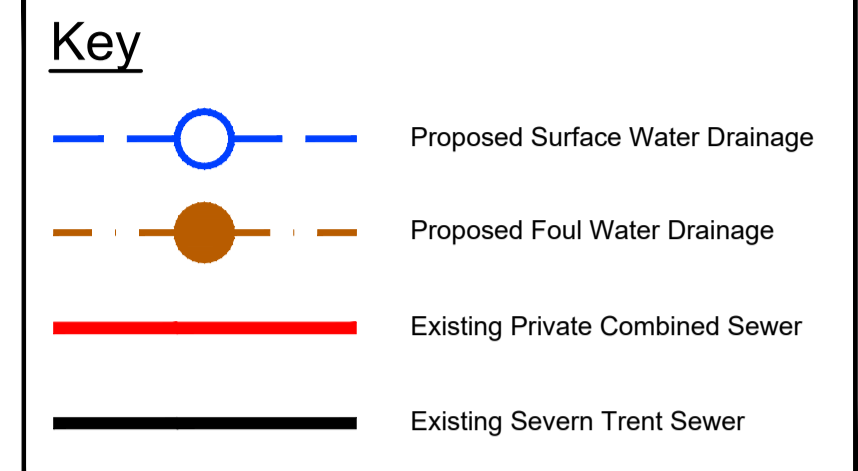

Drainage Strategy

The site is located within flood zone 1 with a low risk of flooding from rivers or the sea and is less than 1 hectare, therefore a site-specific flood risk assessment should not be required.

NPPF guidelines require that surface water arising from a developed site should as far as practicable be managed in a sustainable manner to mimic the surface water flows arising from the site prior to development.

The Existing impermeable area of the site is 701m², which discharges into the Severn Trent Sewer running down Top Street, Askham and has an existing surface water run off rate of 9.7l/s for the 1 in 1 year storm. Therefore, we propose a 30% reduction from existing run off rates, for the 1in100 year + 30% climate change from the site to be restricted to 6.8l/s.

Surface Water:

The proposed impermeable area is 645m² + 10% urban creep = 710m². Based on a flow restriction of 6.8l/s and modelling using Micro Drainage software the attenuation requirement for a peak return period of 1 in 100year plus 30% climate change is **22.4m³**.

This will be provided by Cellular Storage 7m x 8m x 0.4m=22.4m³. **This site will be restricted using a 57mm orifice plate control device.**

Surface water will connect into an existing combined private sewer which connects into a Severn Trent sewer running down Top Street, Askham.

Foul Water:

Foul water will connect into an existing combined private sewer which connects into a Severn Trent sewer running down Top Street, Askham.

P1	FIRST REVISION	14.04.22	JS
No.	Revision	Date	Drwn
Status	Preliminary		
<p>Alre House 12 Victoria Avenue Harrogate HG1 1ED t: 01423 522 295 Unit 223 Ducie House Ducie Street Manchester M1 2JW t: 0161 806 1701 www.topping-engineers.com</p>			
Client	Jonathan Allbones		
Project	Top Street Askham		
Drawing title	Drainage Strategy		
Drawn	JS	Chkd	RT
Date	April 2022	Scale	As Shown @ A1
Contract No.	22098	Drig No.	DR-C-0100
Revision	P1		