

NOTES

Do not scale from this drawing.

Layout and levels are taken from topographical survey any discrepancies are to be reported to the Architect.

This drawing is solely for the use of obtaining Planning Permission.

This drawing is to be read in conjunction with all related drawings. All dimensions must be checked and verified on site before commencing any work or producing shop drawings. The originator should be notified immediately of any discrepancy.

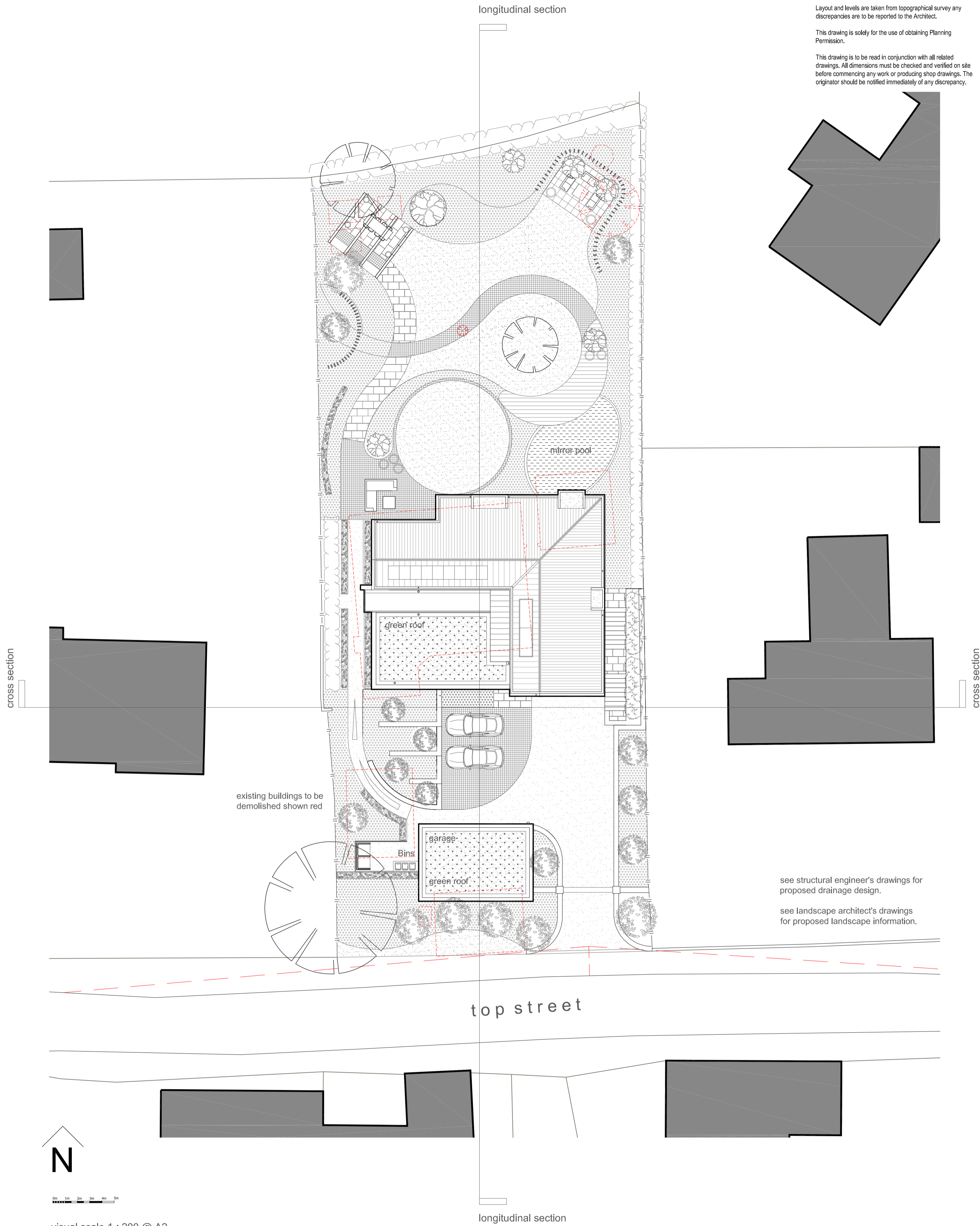

existing buildings to be demolished shown red

see structural engineer's drawings for proposed drainage design.

see landscape architect's drawings for proposed landscape information.

visual scale 1 : 200 @ A2

site plan as proposed. ( roof plan )

NOTES

Do not scale from this drawing.

This drawing is solely for the use of obtaining Planning Permission.

This drawing is to be used for planning purposes only.

This drawing is the sole copyright of nj-ARCHITECTS LTD. Reproduction in any form is forbidden unless permission is obtained in writing.

Do not scale from this drawing, use figured dimensions only. All cutting out dimensions to be checked on site by contractor before work commences. Any discrepancies on site should be brought to the attention of nj-ARCHITECTS LTD.

Work and materials must comply with the current building regulations and codes of practice. All materials are to be installed in strict accordance with the recommendations of the manufacturers and comply with current British standards.

Read in conjunction with all other consultants/specialists information.

rev:	date:	drawn:	checked:	re-numbered:	description:
A	09.08.22	jszn	njs		
status:	PL planning submission				

client:	Jonathan Allbones				
project:	New House				
location:	Top Street, Askham, Newark, NG22 0RP				
drawing title:	Site Plan As Proposed ( roof plan )				
date:	13/01/22	drawn:	jszn	scale @A2:	varies
file reference:	TOPST- NJA - XX - ZZ - DR - A				
drawing number:	104	revision:	A		

**nj-ARCHITECTS**

10 Castle Yard, Hkey, LS29 9DT  
 T: 01943 608311  
 E: info@nj-architects.co.uk  
 W: www.nj-architects.co.uk

**RIBA** Chartered Practice