

Wilson Street

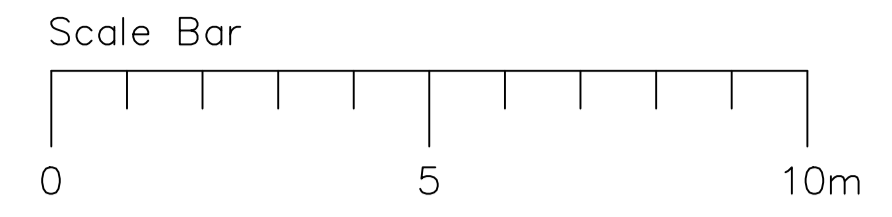

All Dimensions Shall be Checked on Site by the Contractor Prior to Commencement of Work on Site. Do Not Scale. If in Doubt Ask.

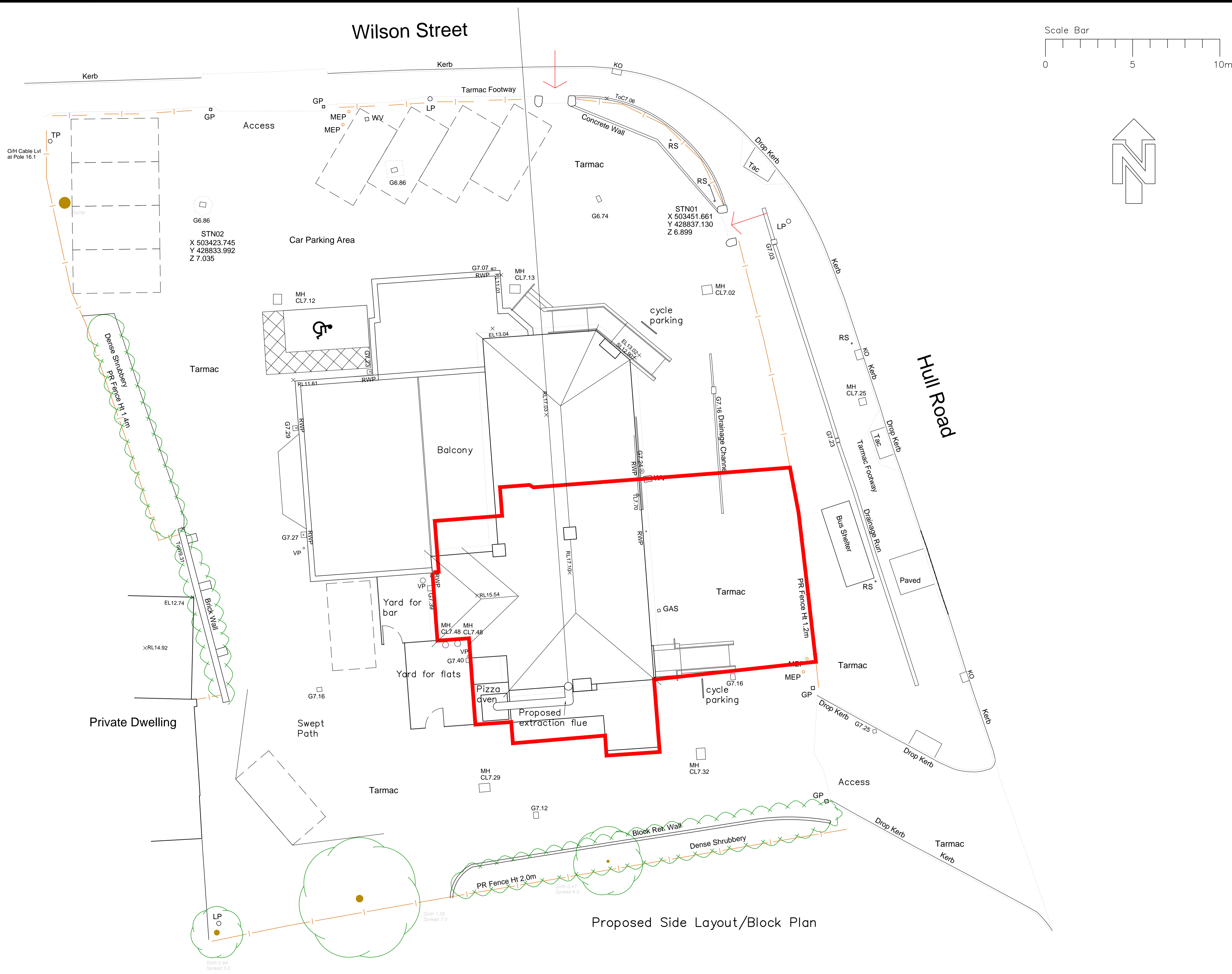
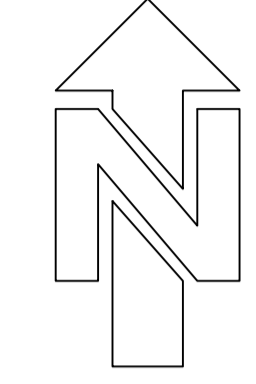

Proposed Side Layout/Block Plan

| Revisions | Date |
|---|-------|
| Robert Farrow (Design) Ltd Architecture : Planning : Construction Topographical Surveys Millar House, 32 Northgate, Hessle, East Riding of Yorkshire, HU13 9AA Tel : 01482 640699 E-mail: rfd@farrow.karoo.co.uk | |
| Client: Mr D Parker | |
| Title: Proposed Site Layout The Red Lion 13 Wilson Street, Anlaby East Riding of Yorkshire HU10 7AN | |
| Scale | 1:100 |
| Drawn by | R |
| Drg no. | 1 |
| Date | Aug22 |
| Contract no. | 22064 |

Scale correct when printed at A1