

This drawing is COPYRIGHT. It must not be reproduced or disclosed to third parties without our prior permission. Do not scale from this drawing, or, interrogate and use electronic information.

Any discrepancies should be reported immediately.

Any surveyed information incorporated within this drawing cannot be guaranteed as accurate unless confirmed by a fixed dimension. All dimensions are in millimetres unless noted otherwise.

LANDSCAPING KEY

- Existing foliage to be retained
- Existing grass to be retained
- Existing tree to be retained
- Proposed crushed stone access track
- Proposed gorse and broom planting
- Proposed hedge planting
- Proposed Permacrib retaining wall

BIODIVERSITY ENHANCEMENT KEY

- Schwegler 2FR bat tube
- Schwegler 1B bird nest box

LANDSCAPING SPECIFICATION

Native Hedge Planting:
 5 plants per linear metre, staggered row:
 Malus sylvestris
 Cornus sanguinea
 Sambucus nigra
 Acer campestre
 Crataegus monogyna
 Corylus avellana
 Ilex aquifolium
 Sorbus aucuparia
 Betula pendula
 Taxus baccata

Habitat Management Plan
 1. Any losses of young plants must be replaced within a 12 month period.
 2. Cutting regimes no more than every 3-5 years between December to February.
 3. Hand machinery used to trim excess vegetation.
 4. Maximum growth in height = 5m.
 5. Plants to be monitored every 3 months for the first three years.
 6. Following establishment, plants to be monitored yearly to assess level of growth.

Native Hedge Planting
 1. Hedge to be topped 400mm deep
 2. 'Trench' to be cultivated to 600mm deep (turning soil and ameliorants into base of trench)
 3. Trench to be ameliorated
 4. Planting into trench of transplants at 5 no. per linear metre
 5. Complete mulch cover, in a strip 750mm wide x 75mm deep



Example of a Permacrib retaining wall

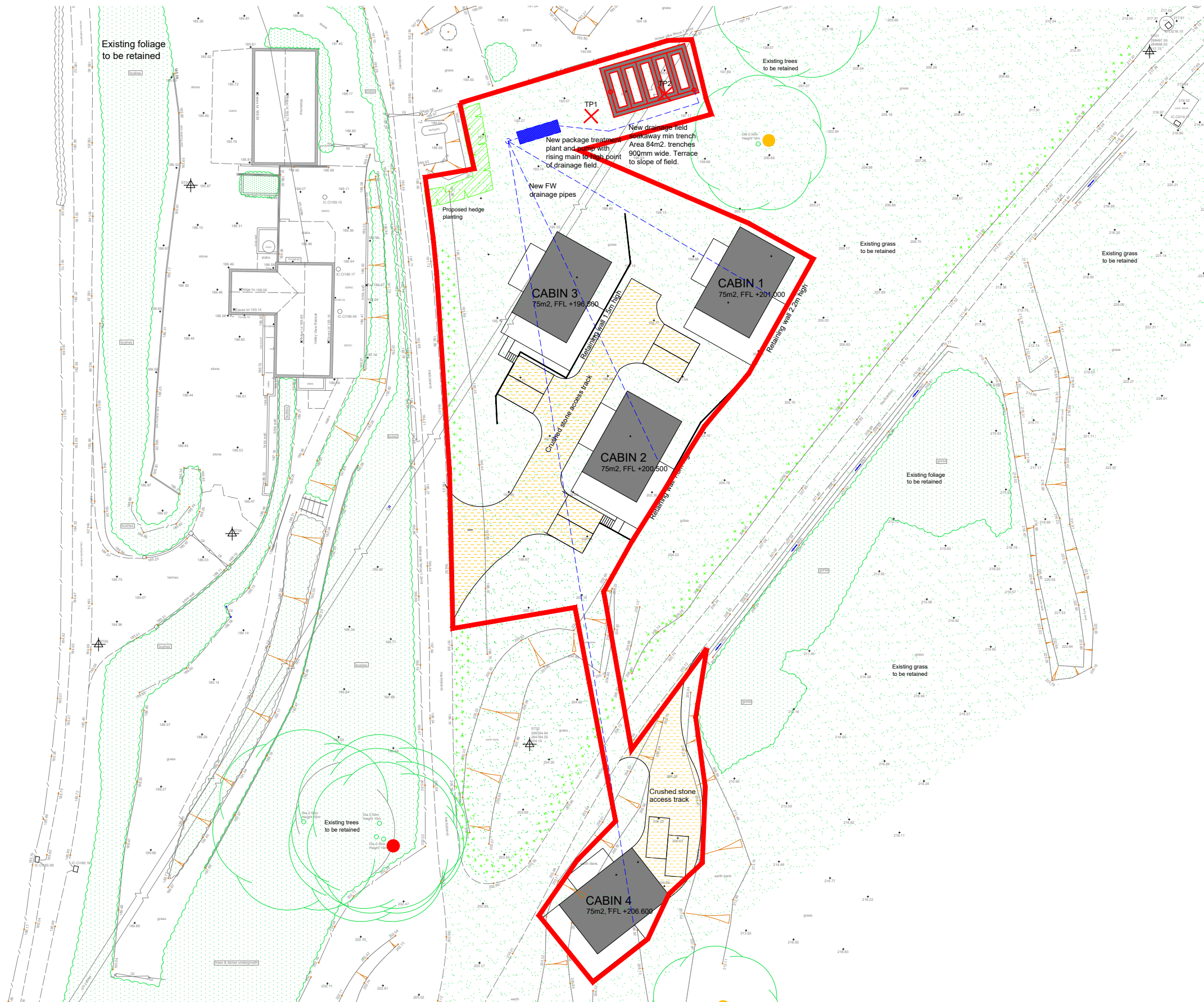

HUGHES

ARCHITECTS

Head Office
 29 Broad Street
 Newtown
 Powys
 SY16 2BQ
 t - 01686 610311
 w - www.hughesarchitects.co.uk

Rev D - Scale checked and red line boundary added 04.08.22 - GSP
 Rev C - Cabin sizes amended to match plans as per planning comment 25.07.22 - GSP
 Rev B - Drainage field and parking amended 01.06.22 - GSP
 Rev A - Removal of planting following ecologist comments 15.03.22 - GSP

Project Additional Holiday Cabins at Valley View Retreat, Dolwen Llanidloes, Powys, SY18 6LH	
Drawing Status Stage 3a: Planning	Drawing Title Proposed Block Plan
Scale 1:500@A3	Date 31.01.22
Drawn by NB	Checked RRL
Drawing No WI25 3a.3.003	Rev D