

Notes
All dimensions must be checked on site & not scaled from this drawing

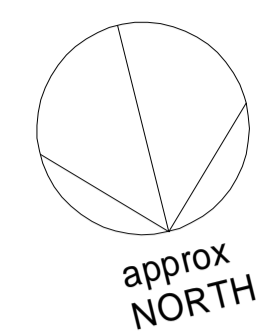

Two number proprietary roof windows close coupled 660wide x 978long to admit more day-light.

Two number proprietary roof windows close coupled 660wide x 978long to admit more day-light.

existing roofs to be re-laid in imitation concrete Stonesfield slate in diminishing courses - proposed new pitched roofs to matching finishes

Boundary fence under

Boundary fence under

A

A

B

B

C

C

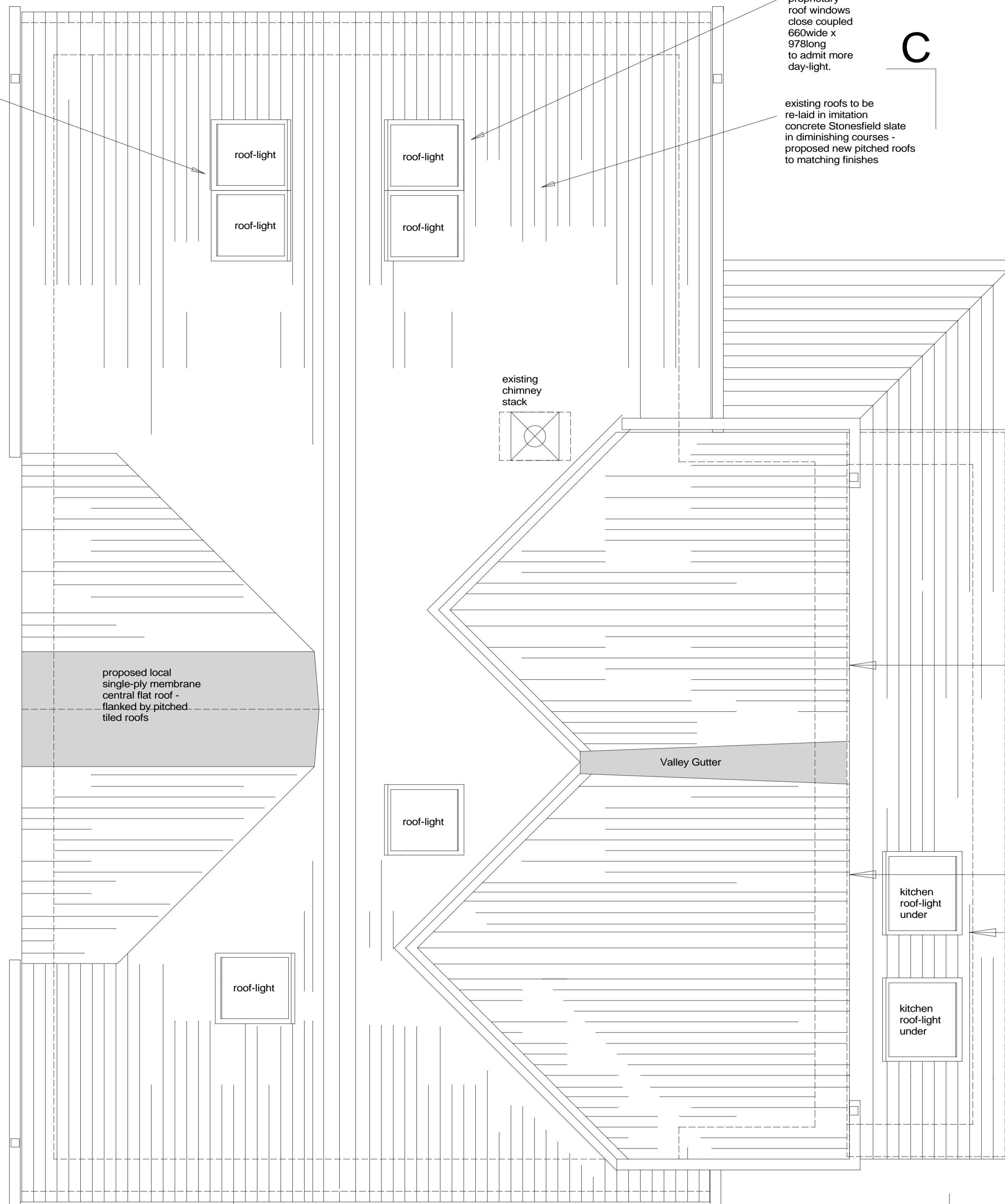

ROOF PLAN



proposed local single-ply membrane central flat roof - flanked by pitched tiled roofs

Valley Gutter

existing chimney stack

roof-light
roof-light

roof-light
roof-light

roof-light

roof-light

gable roof dormer above proposed extended bathroom

gable roof dormer above proposed extended bedroom

mono-pitch roof above extended kitchen & new WC

kitchen roof-light under

kitchen roof-light under

Square section pvc-u rainwater goods

revised NMA submission to WODC Planners - omitting new s/steel log-burner external flue	16.09.22	sw	P9
Non-material Amendment Planning shown hatched	15.08.22	mn	P8
To WODC Building Regs - 20.05.22			
Additional Building Regulation notes added following meeting with S.engineer.	13.05.22	mn	P7
kitchen roof lights added	10.01.22	sw	P6
To WODC for Full planning - 19.11.21			
revised dormer roof plan shown	18.11.21	mn	P5
pre-app amendments	03.11.21	mn	P4
to WODC for planning pre-app advice 24.9.21			
amendments from HC call 23.9.21	24.09.21	mn	P3
amendments ref tele-discussion 20.9.21	21.09.21	mn	P2
first issue	03.08.21	mn	P1
Revisions	Date	by	Rev

Client
Hannah & Alex Crowe
'Cambo', Peaks Lane, Stonesfield

Project
ALTERATIONS & EXTENSIONS to
Cambo, Peaks Lane, Stonesfield
Oxford OX29 8PY

Roof Plan as Proposed

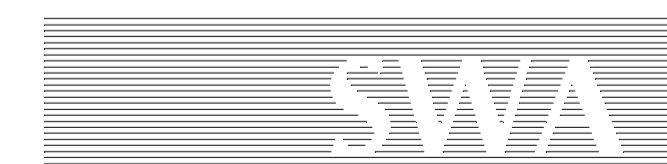

STANHOPE WILKINSON ASSOCIATES ARCHITECTS
2 Swinford Farm Eynsham Oxford OX29 4BL
Tel: (01865)883222
E-mail: office@swa-architects.co.uk

Scales 1:25 @ A1	Date 25.08.2021	by MN
1:50 @ A3		

Job No. 21420	Drawing No. 310	Rev. P9
---------------	-----------------	---------