

client **Mr & Mrs M Lowen**
 project Proposed extension to;
 Ennor House, Station Road,
 Worstead. NR28 9RX.
 drawing **Location Plan**

date **Sept '22** scale **1:1250 @ A4**

ref. **22 - 0626 - 01 -**

32 Bluebell Road, Mulbarton, Norfolk. NR14 8BN.
M: 07494 251386 E: ian.norris.ad@gmail.com

IAN NORRIS (MCIAI)

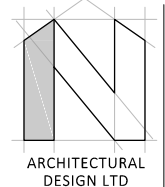

ARCHITECTURAL
DESIGN LTD