

First Floor Plan

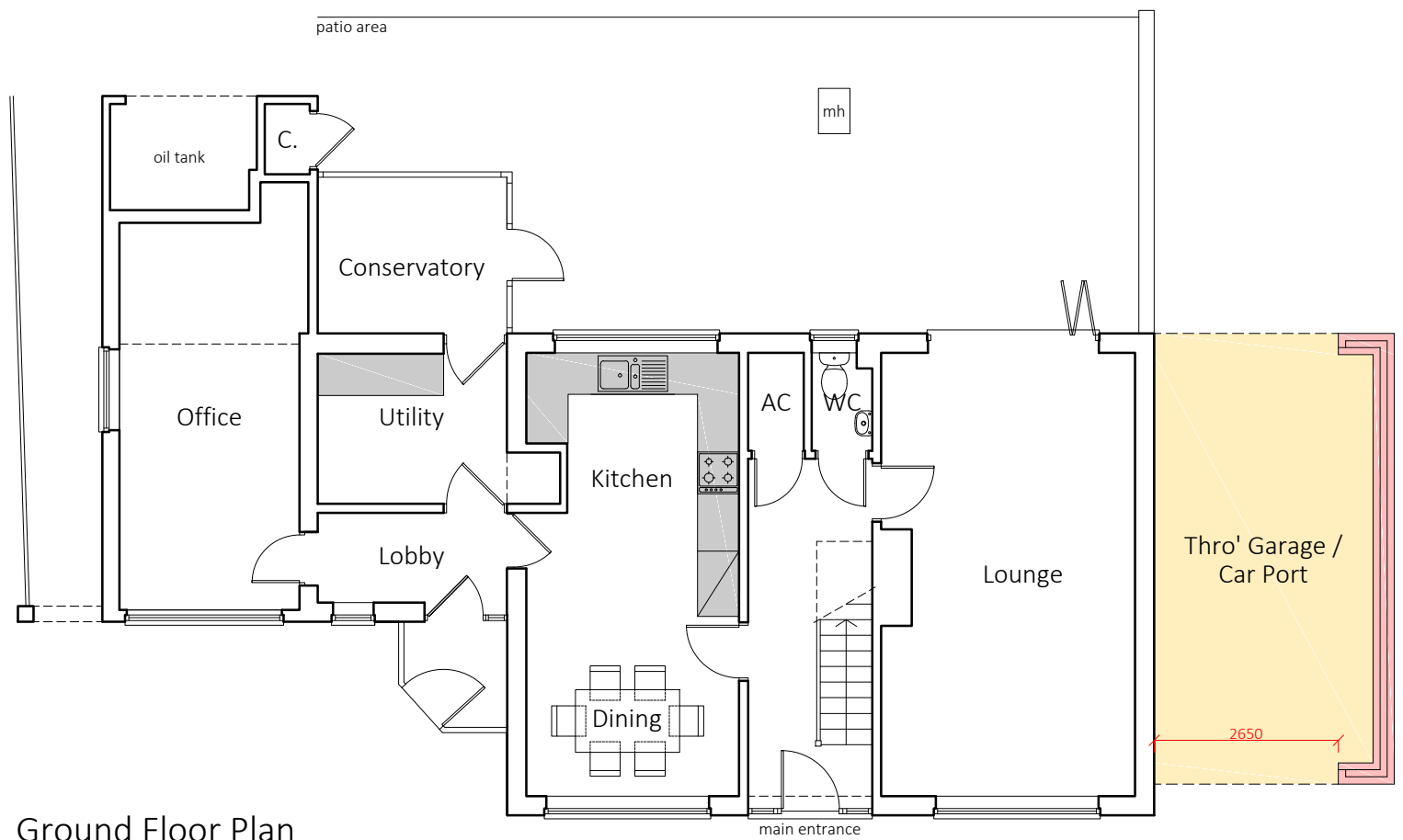

Ground Floor Plan

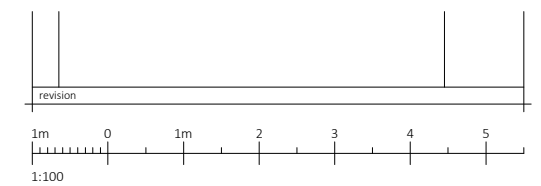

revision
 1m 0 1m 2 3 4 5
 1:100
 client: Mr & Mrs M Lowen
 project: Proposed extension to; Ennor House, Station Road, Worstead. NR28 9RX.
 drawing: Proposed Floor Plans
 date: Feb '22 scale: 1:100 @ A3
 ref: 22 - 0626 - 12 -
 32 Bluebell Road, Mulbarton, Norfolk. NR14 8BN.
 M: 07494 251386 E: ian.norris.ad@gmail.com
 ARCHITECTURAL DESIGN LTD