

DO NOT SCALE
 REPORT ERRORS AND OMISSIONS
 CHECK ALL DIMENSIONS BEFORE FABRICATION

REVISION		DRAWN	CHKD	DATE
A	Design change to clients request. Discussion had with Planner on site about change	TP	TP	Apr 2022
B	Dimension added to parking	TP	TP	May 2022
C	Secure sheds and bin store locations added	TP	TP	July 2022

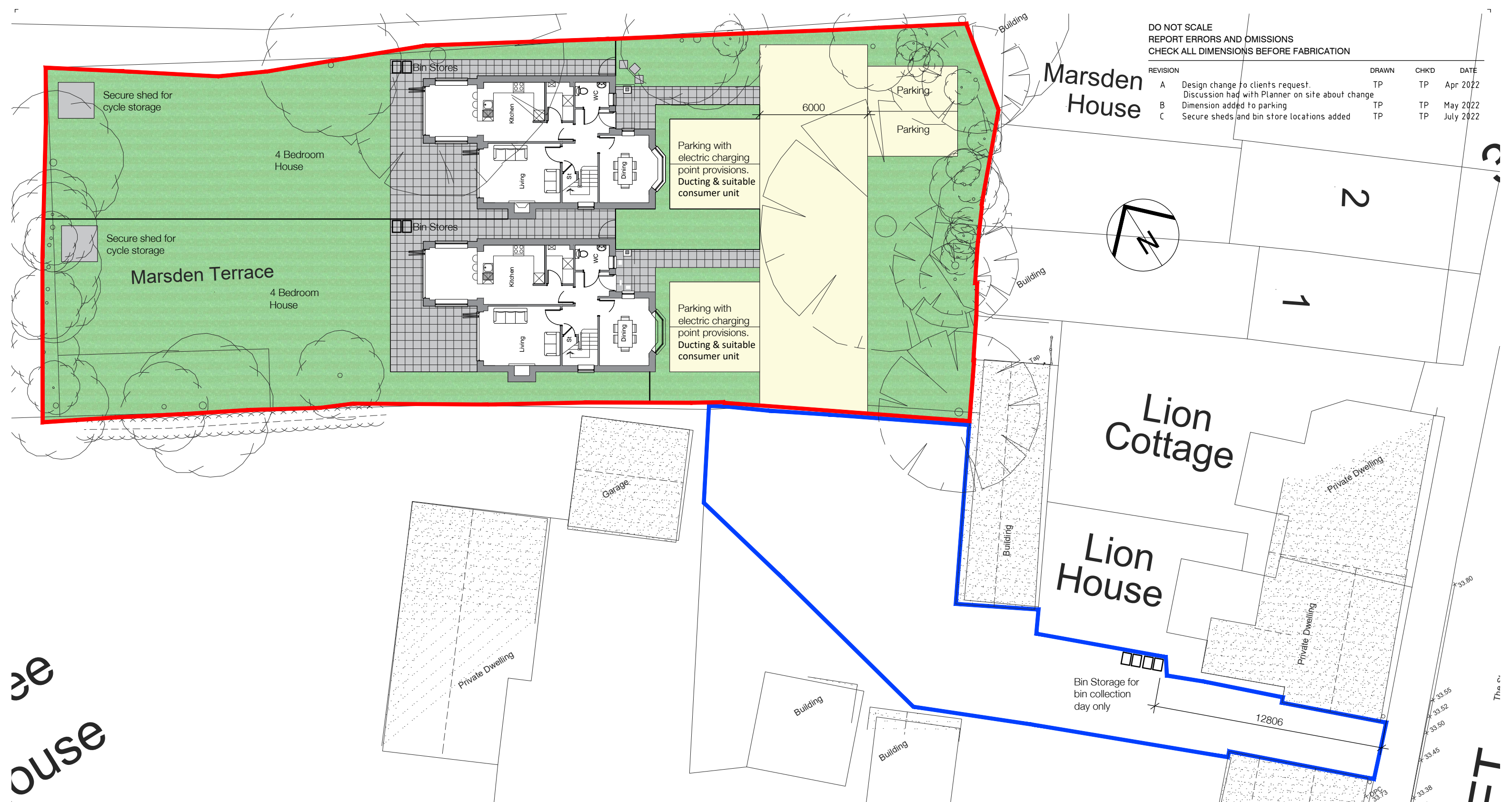

PLANNING APPLICATION



CONTRACT	Rear of Lion House The Street, Rickinghall Diss, Norfolk, IP22 1DY		
DATE	December 2021		
DRAWN	TP		
CHECKED	TP		
TITLE	Proposed Site Plan		
DRAWING No	21074_PL01		
REVISION	C		

TMP Architecture Ltd
 48 Hawthorn Avenue Rainham Essex RM13 9AT
 T 07860 298842 E tonyp@tmparchitecture.co.uk