

- KEY**
- SITE BOUNDARY
 - INDICATIVE FOUL WATER SEWER
 - INDICATIVE SURFACE WATER SEWER
 - INDICATIVE PERMEABLE PAVING (30% VOIDS)
 - ATTENUATION BASIN WITH 3m MAINTENANCE STRIP
 - SURFACE WATER CONTROL CHAMBER
 - INDICATIVE SURFACE WATER PUMP STATION
 - INDICATIVE FOUL WATER PUMP STATION
 - INDICATIVE FOUL WATER RISING MAIN
 - EXISTING ANGLIAN WATER FOUL WATER SEWER
 - ANGLIAN WATER SEWER EASEMENT
 - INDICATIVE HEADWALL
 - EXISTING WATERCOURSE
 - INDICATIVE ATTENUATION TANK

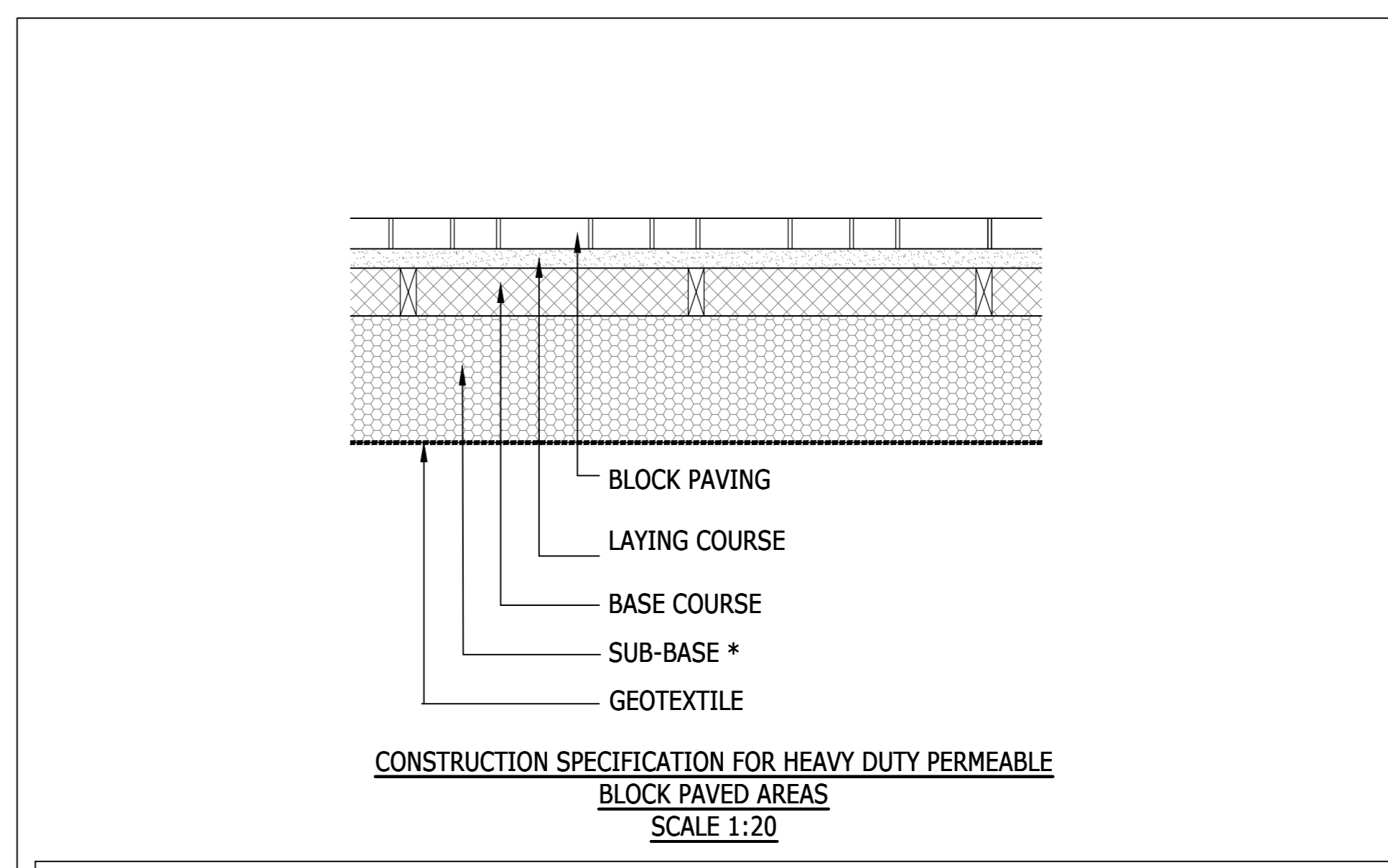
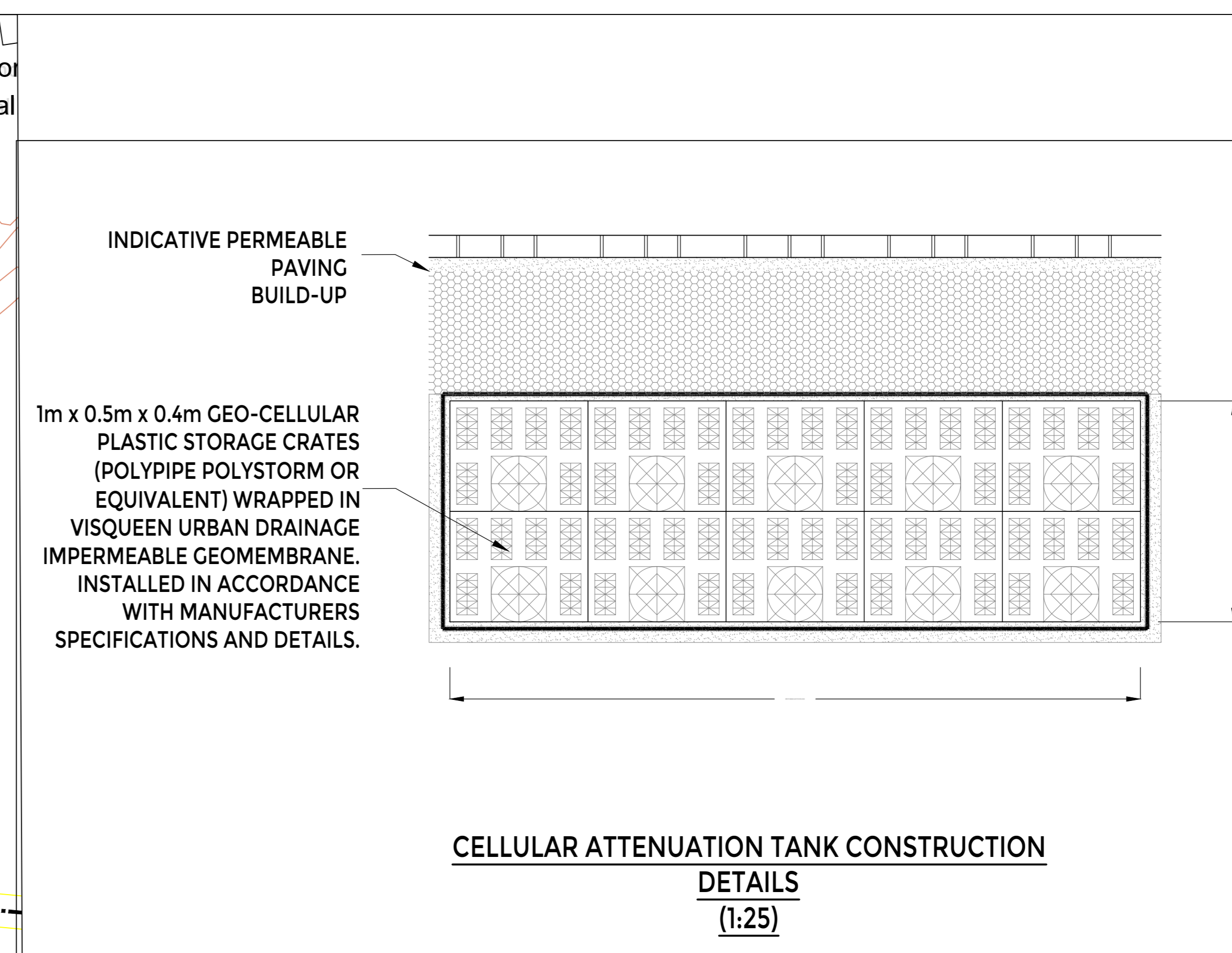
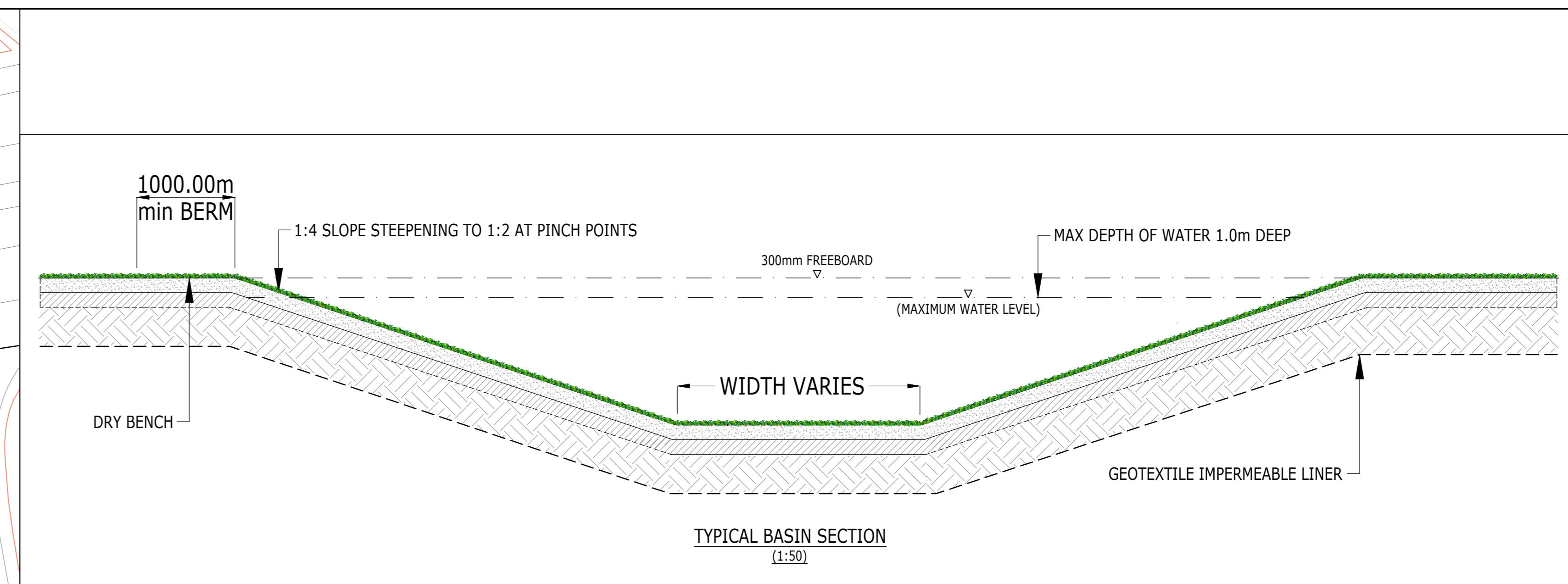
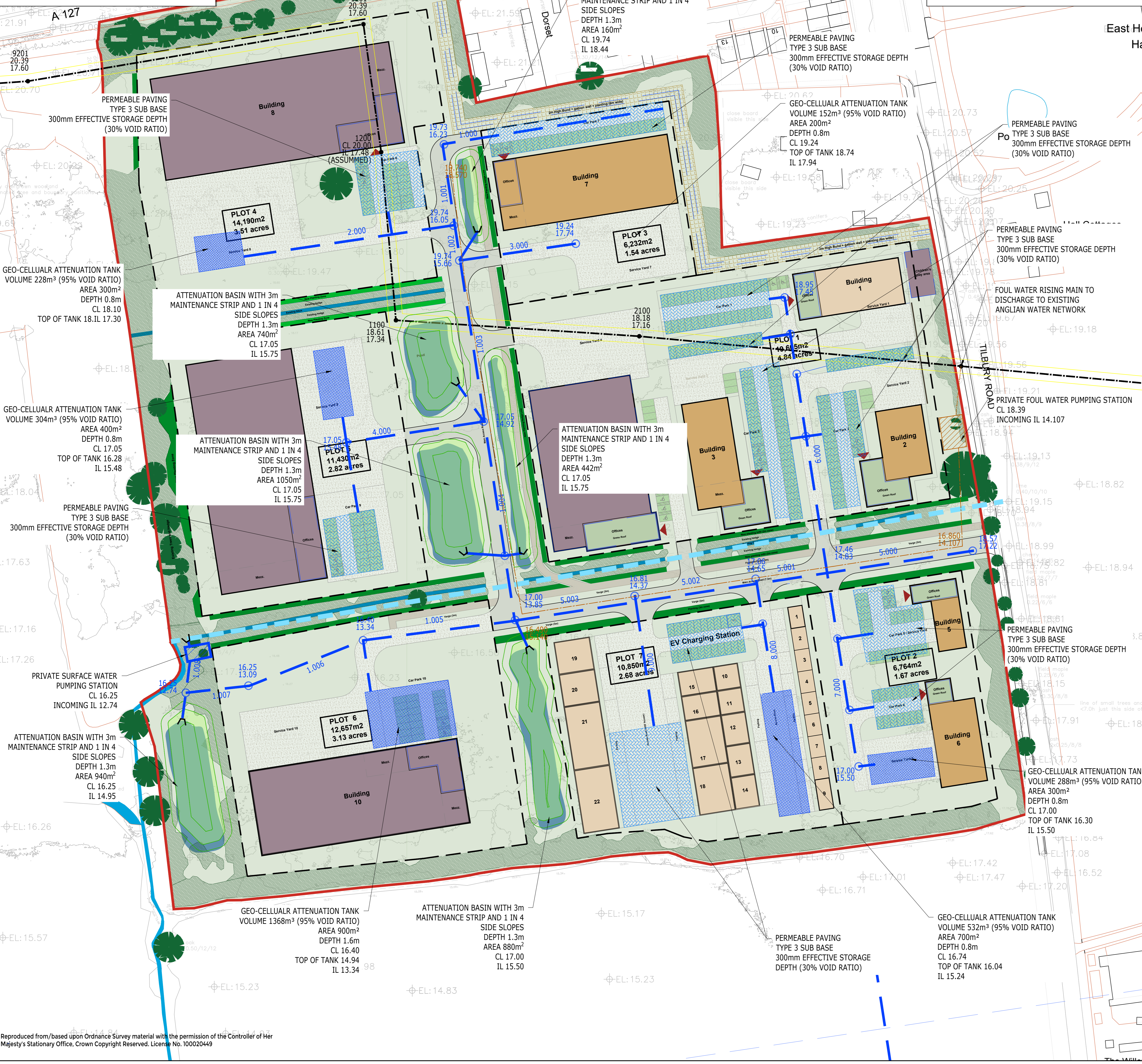

PERMEABLE PAVING NOTES

LIGHT DUTY: SHOULD ONLY BE USED FOR SINGULAR OR DOUBLE DRIVES SERVING 1 OR 2 PLOTS - NOT SUITABLE FOR AREAS WHICH WILL BE SUBJECT TO CONSTRUCTION TRAFFIC OR POTENTIAL LOADING FROM HEAVY GOODS VEHICLES inc. DELIVERY, PALETTEHANDLING, REFUSE COLLECTION AND FIRE RESCUE VEHICLES

HEAVY DUTY: TO BE USED FOR ALL SHARED DRIVES, PARKING COURTS AND PRIVATE ACCESS ROADS

* THE FORMATION OF THE PERMEABLE PAVING SUB-BASE MUST NOT EXCEED A GRADIENT OF 1/40.

FOR STEEPER GRADIENTS, USE MAXIMUM GRADIENT OF 1/40 FOR FORMATION, APPLYING VERTICAL STEPS AS NECESSARY, BUT ENSURING MINIMUM SUB-BASE THICKNESS IS ALWAYS ACHIEVED.

PERMEABLE PAVING CONSTRUCTION SPECIFIED ABOVE IS SUITABLE FOR CBR VALUES OF BETWEEN 2% & 5%. FOR CBR VALUES OUTSIDE OF THIS RANGE, REFER BACK TO THE ENGINEER FOR CLARIFICATION.

ALL MATERIAL SPECIFICATION AND WORKMANSHIP OF PERMEABLE PAVING CONSTRUCTION TO BE STRICTLY IN ACCORDANCE WITH RECOMMENDATIONS BY MARSHALLS.

- NOTES:**
1. THIS DRAWING IS TO BE READ IN CONJUNCTION WITH THE RELEVANT SPECIFICATION AND ALL OTHER RELATED DRAWINGS ISSUED BY THE ENGINEER.
 2. DO NOT SCALE FROM THIS DRAWING. WORK FROM FIGURED DIMENSIONS ONLY.
 3. ALL DIMENSIONS SHOWN ON THIS DRAWING ARE IN METRES UNLESS OTHERWISE STATED. ALL GROUND LEVELS ARE IN METRES ABOVE ORDNANCE DATUM (AOD).
 4. ALL DIMENSIONS, LEVELS AND SURVEY GRID CO-ORDINATES ARE TO BE CHECKED ON SITE AND THE ENGINEER NOTIFIED IMMEDIATELY OF ANY DISCREPANCIES PRIOR TO THE COMMENCEMENT OF THE WORKS. LEVELS ARE SUBJECT TO DETAILED EARTHWORKS AND LEVELS DESIGN.
 5. THIS DRAWING HAS BEEN BASED ON DRAWING No. NWA-0503-A20-007 PRODUCED BY NICHOLAS WEBB ARCHITECTS.
 6. EXISTING DRAINAGE AND UTILITIES TO BE CONFIRMED IN-SITU BY THE CONTRACTOR, PRIOR TO STARTING WORKS. EXISTING DRAINAGE SHOWN INDICATIVELY.
 7. THE DRAINAGE STRATEGY IS INDICATIVE ONLY, TO DEMONSTRATE DESIGN INTENT AND REQUIREMENTS. DESIGN SUBJECT TO CHANGE AND DESIGN TEAM COORDINATION.
 8. LOCATIONS OF EXISTING SEWERS HAVE BEEN TRANSCRIBED FROM ANGLIAN WATER SEWER RECORDS AND ARE TO BE CONFIRMED BY AN IN-SITU SURVEY.
 9. PROPOSED SURFACE WATER DRAINAGE SYSTEM HAS BEEN DESIGNED UP TO THE 1 IN 100 YEAR RAINFALL EVENT + 40% FOR CLIMATE CHANGE.
 10. PROPOSED DISCHARGE RATE OF 31.80 L/S BASED ON MEAN ANNUAL GREENFIELD RUNOFF RATE (QBAR).
 11. PROPOSED SURFACE WATER PONDS TO BE DESIGNED (AT DETAILED DESIGN STAGE) AS PERMANENT WATER FEATURES IN COORDINATION WITH LANDSCAPE ARCHITECT.
 12. PROPOSED FOUL WATER CONNECTION TO ANGLIAN WATER SEWERS TO BE CONFIRMED AT DETAILED DESIGN STAGE VIA SECTION 106 (WATER ACT) APPLICATION.

DRAFT
 FOR INFORMATION ONLY

Rev	Description	Dwn	Chk	App	Date
ARDENT CONSULTING ENGINEERS					
Suite 207 One Aile Street London E1 8DE					
Tel: 020 7680 4088 Fax: 020 7488 3736					
Web: www.ardent-ce.co.uk E-mail: enquiries@ardent-ce.co.uk					
Client MM PROPERTIES (LONDON) LIMITED					
Project Title: BROADFIELDS, EAST HORNDON, BRENTWOOD					
Drawing Title: INDICATIVE SURFACE & FOUL WATER DRAINAGE STRATEGY					
At Scale	Date	Designed by			
1:1000	26.09.2021	FH			
Drawn by	Checked by	Approved by			
FH	CC	BC			
Drawing Number	Rev				
2008543-001	-				

Reproduced from/based upon Ordnance Survey material with the permission of the Controller of Her Majesty's Stationary Office, Crown Copyright Reserved. Licence No. 100020449