

- EXCAVATE THE TRENCH TO THE REQUIRED DEPTH ENSURING THAT THE PLAN AREA IS SLIGHTLY GREATER THAN THAT OF THE INFILTRATION UNITS.
- LAY 100mm BED OF COARSE SAND, LEVEL AND COMPACT.
- LAY THE PERMEABLE GEOMEMBRANE OVER THE BASE AND UP THE SIDE OF THE TRENCH.
- LAY THE STORAGE CELLS AND FIX TOGETHER USING THE CLIPS AND SHEAR CONNECTORS IN ACCORDANCE WITH THE MANUFACTURERS RECOMMENDATIONS.
- WRAP THE PERMEABLE GEOMEMBRANE AROUND THE CELLS AND LAP OVER TO PREVENT INFILTRATION OF SILT INTO THE UNITS.
- LAY 100mm OF COARSE SAND BETWEEN THE TRENCH WALLS AND THE STORAGE CELLS AND COMPACT.
- LAY 100mm BED OF COARSE SAND OVER THE GEOTEXTILE AND COMPACT. BACKFILL WITH GRANULAR SUB-BASE MATERIAL.

SOAKAWAY STORAGE CELL DETAIL (1:20)

GENERAL NOTES:

- COPYRIGHT IN THIS DOCUMENT BELONGS TO LARK ARCHITECTS LTD & ALL RIGHTS IN IT ARE RESERVED BY THE OWNER.
- NO PART OF THIS DRAWING MAY BE COPIED, TRANSFERRED, OR MADE AVAILABLE TO USERS OTHER THAN THE ORIGINAL RECIPIENT, INCLUDING ELECTRONICALLY, WITHOUT PRIOR PERMISSION FROM LARK ARCHITECTS LIMITED.
- THIS DRAWING IS TO BE READ IN CONJUNCTION WITH ALL RELEVANT ARCHITECTS & ENGINEERS DRAWINGS & SPECIFICATIONS.
- ALL DIMENSIONS ARE SHOWN IN MILLIMETRES.
- ONLY FOR HAND COPIES OF DRAWINGS SHOULD BE REFERRED TO FOR CONSTRUCTION USE. THE USE OF AUTOCAD DRAWINGS/ISSUES IS UNACCEPTABLE ENTIRELY AT THE DEVELOPER'S RISK AND ALL DIMENSIONS AND SETTING OUT MUST BE CHECKED IN CONJUNCTION WITH THE ARCHITECT AND ENGINEERS CONSTRUCTION DRAWINGS. ALL DRAWINGS SHOULD BE CONFIRMED AS LATEST ISSUE ON THE DOCUMENT ISSUE SHEET PRIOR TO COMMENCEMENT OF WORKS AND SHOULD BE USED ONLY FOR THEIR DEFINED DRAWING STATUS. ANY DISCREPANCIES BETWEEN THE ARCHITECT AND ENGINEERS DRAWINGS ARE TO BE IMMEDIATELY NOTIFIED TO ALL PARTIES.
- ALL EXISTING DRAINAGE INVERT LEVELS AT POINTS OF CONNECTION TO BE CONFIRMED PRIOR TO CONSTRUCTION.
- MANHOLES, SEWERS ETC AND ANY OTHER PART OF THE WORKS INTENDED FOR ADOPTION UNDER A SECTION 104 AGREEMENT OR GULLIES ETC INTENDED FOR ADOPTION AS HIGHWAY DRAINAGE ARE TO BE CONSTRUCTED IN ACCORDANCE WITH THE W.V.A. SPECIFICATION 'SEWERS FOR ADOPTION' (6th EDITION), AND TO THE APPROVAL OF YORKSHIRE WATER.
- UN ADOPTED FFW AND SW DRAINAGE IS TO BE CONSTRUCTED IN ACCORDANCE WITH THE BUILDING REGULATIONS, BS 8001 AND RELEVANT AGREEMENT CERTIFICATES.
- DRAINS ARE TO BE CONSTRUCTED USING FLEXIBLY JOINTED VITRIFIED CLAY PIPES TO BS 6500 AND BS 2494, BEDDED AND BACKFILLED IN ACCORDANCE WITH THE MANUFACTURERS INSTRUCTIONS AND THE SPECIFICATIONS. BACKFILLING OF DRAIN TRENCHES ADJACENT TO DWELLINGS OR OTHER STRUCTURES TO BE IN ACCORDANCE WITH BS 8001-FIG 9.
- ACCESS FITTINGS AND INSPECTION CHAMBERS LESS THAN 1.2m DEEP ARE TO BE CLAYWARE OR PREFORMED POLYPROPYLENE AS APPROPRIATE TO THE NUMBER OF CONNECTIONS. POLYPROPYLENE CHAMBERS CAN BE USED UP TO 3m DEEP BUT REQUIRE MAX 300mm OAM REDUCED COVER TO PREVENT MAN ENTRY. MANHOLE CHAMBERS ARE TO BE OF PRECAST CONCRETE CONSTRUCTION WITH 150mm INSITU CONCRETE SURROUND. INSPECTION CHAMBER SIZES ARE TO BE IN ACCORDANCE WITH TABLE 9 OF BS 8001.
- COVER LEVELS INDICATED ON THE DRAWING ARE NOMINAL AND MAY BE ADJUSTED TO SUIT FINISHED FOUND LEVELS AS NECESSARY. INSPECTION CHAMBER COVERS SHOULD BE GRADE FLOES.
- WHERE DRAINS PASS THROUGH FOUNDATIONS OR OTHER ROAD STRUCTURES, A LABEL OR SLEEVE IS TO BE USED AND PROVISION FOR FLEXIBILITY IS TO BE MADE WITH 'ROCKER PIPES'.
- ANY EXISTING LAND DRAINS DEVIATED BY SITE OPERATIONS SHOULD BE DIVERTED AROUND ANY PROPERTIES AND RECONNECTED TO THE EXISTING LAND DRAINAGE SYSTEM VIA A SILT TRAP.
- GULLIES SITUATED ACCESSIBLE TO WHEELED VEHICLES TO BE OF A SUITABLE CONSTRUCTION (E.G. HEPPWORTH CODE 194 GULLY POT WITH INSITU CONCRETE BED AND SURROUND, FITTED WITH DRAINAGE CASTINGS CODE T061 GRATING AND FRAME).
- DRAINS WITHIN AREAS OF 'MADE GROUND' TO BE CONSTRUCTED BY FIRST MAKING UP THE AREA TO APPROXIMATE FINISHED LEVEL AND THEN EXCAVATING THROUGH THE FILL MATERIAL INTO UNDISTURBED GROUND. THE DRAIN TRENCH IS THEN TO BE BACKFILLED TO FORMATION LEVEL USING SUITABLE GRANULAR FILL MATERIAL, WELL COMPACTED IN LAYERS NOT EXCEEDING 225mm.
- PRIVATE DRAINAGE CONNECTIONS TO ADOPTABLE SEWERS TO BE VIA 45° JUNCTIONS AND NOT SADDLES. CONCRETE PROTECTION TO PIPES REQUIRED WHERE DEPTH OF PIPE FROM GROUND LEVEL TO BARELL LESS THAN 0.5m.
- MANHOLE COVERS SHALL HAVE A CLEAR OPENING OF 600mm AND SHALL BE CLASS D400 TO BS EN 124 WITH 150mm DEEP FRAMES IN HIGHWAYS. STANDARDS REQUIREMENTS ADDENDUM TO THE MECHANICAL AND ELECTRICAL SPECIFICATION AND KITEMARKED.
- MANHOLE COVERS SHALL HAVE A CLEAR OPENING OF 600mm AND SHALL BE CLASS D400 TO BS EN 124 WITH 150mm DEEP FRAMES IN HIGHWAYS. SULPHATE RESISTANT CEMENT (C20/DC2) AND PRECAST CONCRETE PRODUCTS MUST BE USED OR A LABORATORY REPORT PROVIDED PROVING THAT SUCH PRECAUTIONS ARE NOT NECESSARY.
- THE ADOPTABLE SEWERS SHOULD BE A MINIMUM OF 1m AND MANHOLES 0.5m FROM KERB FACES AND SERVICE MARGINS.
- 'SEWERS MUST HAVE 5 METRES CLEARANCE FROM TREES AND HEDGES (PLEASE ALSO REFER TO FIGURE 2.3.1 ON PAGE 33 IN 'SEWERS FOR ADOPTION' 6TH EDITION FOR RESTRICTIONS ON TREE PLANTING ADJACENT TO SEWERS).
- SEWERS TO BE LAID IN CLASS 'B' BEDDING (150mm GRANULAR BED AND SURROUND) WHERE DEPTH OF COVER TO TOP OF THE SEWER IS LESS THAN 1.2m IN HIGHWAYS AND VERGES OR LESS THAN 0.6m IN NON-VEHICULAR ACCESS AREAS THEN A CONCRETE SLAB SHOULD BE PROVIDED ABOVE GRANULAR BED AND SURROUND.
- BEDDING AND BACKFILL MATERIAL TO CONFORM TO THE REQUIREMENT OF WATER INDUSTRY SPECIFICATION 4-08-02 (TABLE A2).
- THE CHAMBER SIZE OF MANHOLES WITH MORE THAN ONE CONNECTION IN THEM MAY NEED TO BE INCREASED AN INCREMENT TO ACCOMMODATE THE CONNECTIONS AND BENES.
- ALL DRAINAGE TO BE CONSTRUCTED TO SEWERS FOR ADOPTION 6TH EDITION (PUBLIC) AND THE BUILDING REGULATIONS PART H (PRIVATE).

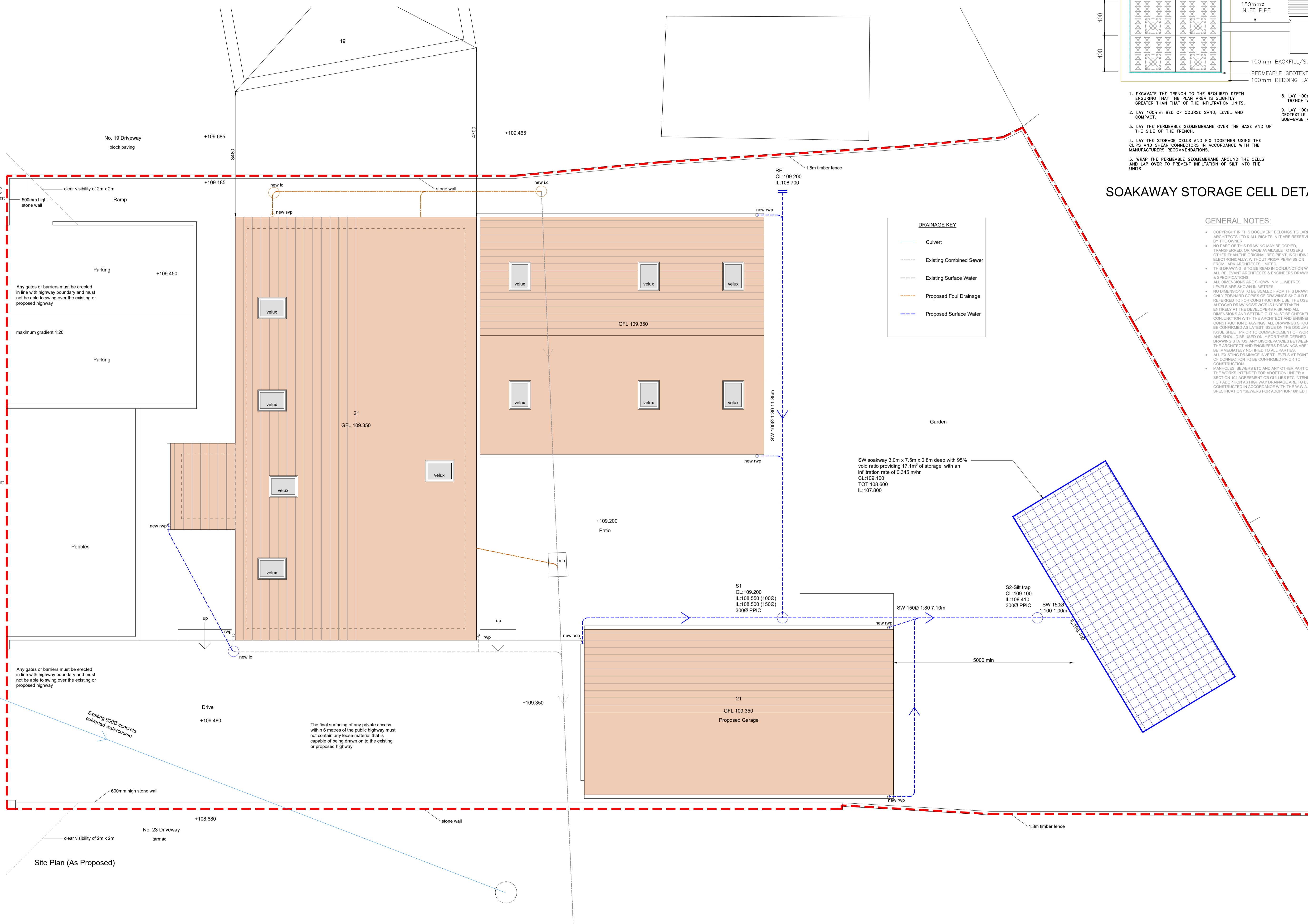
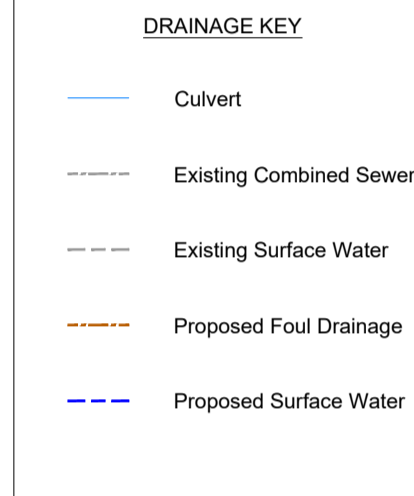

Site Plan (As Proposed)

Rev.	Date.	Notes



01535 430772
info@larkarchitects.co.uk www.larkarchitects.co.uk

client: Brian & Christie Cauvin

project: 21 Ash Grove, Sutton-In-Craven, Keighley, BD20 7QJ

drawing: Proposed Drainage Plan

status: Planning

job no: 1149	dwg no: 101	rev:
--------------	-------------	------

scale: 1:50 @ A1 drawn: C.J.M check: R.A.K
date: Oct 2022 © This drawing is copyright of LARK Architects Ltd.

LARK Architects Ltd
Unit 10 Crossings Court,
The Crossings Business Park,
Cross Hills, Keighley, BD20 7BW. RIBA Chartered Practice