

Notes:-

All dimensions and setting out to be verified prior to work commencing.
 All discrepancies to be notified to this office prior to work commencing.
 Do not scale off drawing - use figured dimensions only.

Rev.	Revision	Date
.	.	.

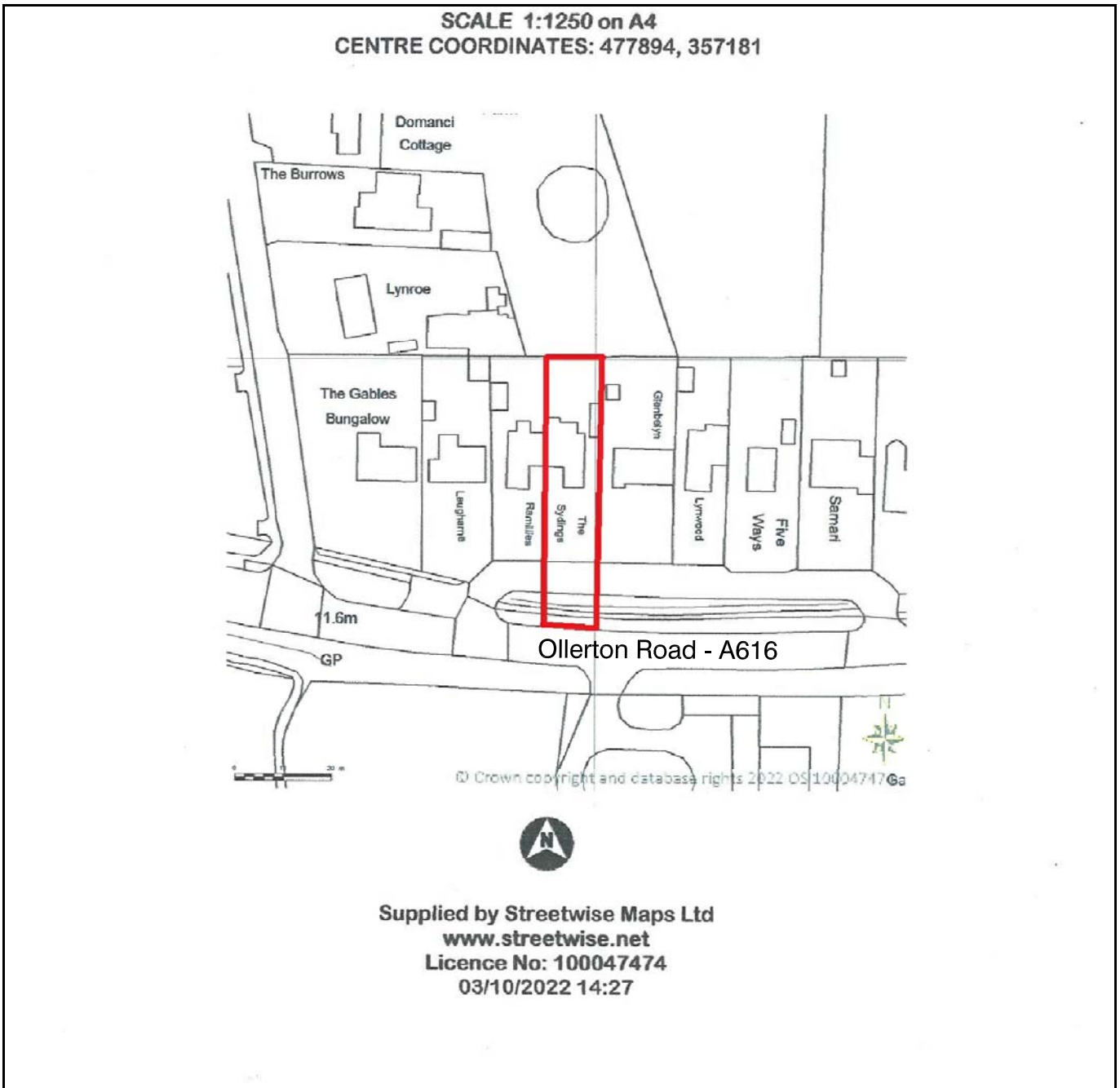

Proposed Extension and Alterations to The Sydngs, Little Carlton for Mr C Carman

architecture ■ design ■ planning

The Studio, Woodmans Cottage, Swinderby Road,
 Norton Disney, Lincoln, LN6 9QH
 t : 01522 869489 m : 07596 155845
 e : evolution4design@btinternet.com w : evolutiondesign.info

Planning drawing status.

OS Plan		drawing.
1:1250 @ A4	scale.	October 2022 date.
420 - C - 1.		drawing no.