

- General Notes:**
1. This drawing is to be read in conjunction with other consultants drawings.
  2. Check site conditions prior to commencement of work.
  3. Discrepancies must be reported directly to the Architect.
  4. Do not scale off drawing, use figured dimensions only, unless for planning purposes.
  5. This drawing may be issued in colour, and may be a non-standard paper size.

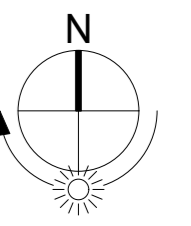

- Existing and Approved Buildings
- Proposed Arena and Field Barn

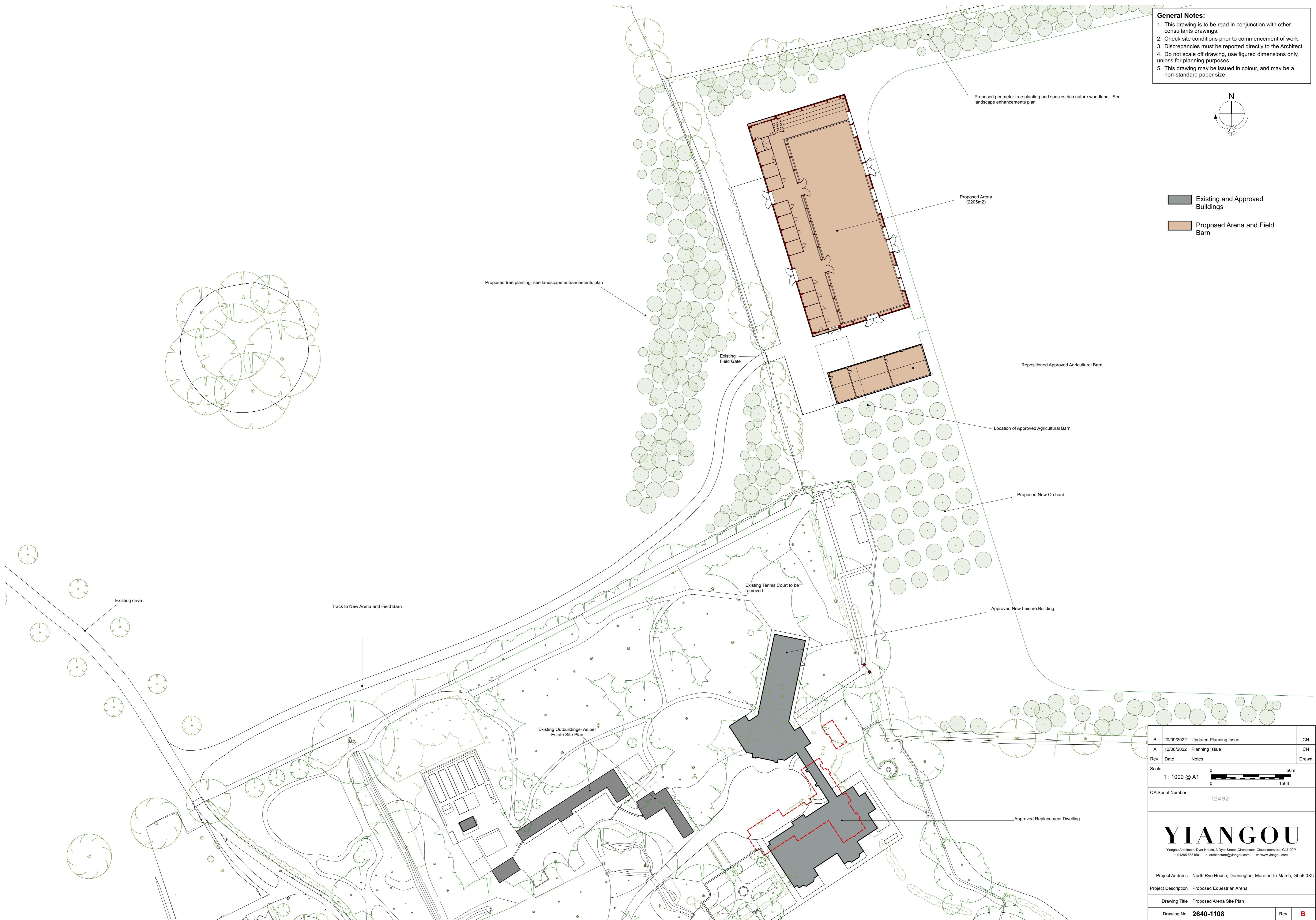

Rev	Date	Notes	Drawn
B	20/09/2022	Updated Planning Issue	CN
A	12/08/2022	Planning Issue	CN
Scale	1 : 1000 @ A1		
QA Serial Number	72492		
<h1>YIANGOU</h1> <p>Yiangou Architects, Dyer House, 3 Dyer Street, Cirencester, Gloucestershire, GL7 2PP          1 01295 888150 e architecture@yiangou.com w www.yiangou.com</p>			
Project Address	North Rye House, Donnington, Moreton-in-Marsh, GL56 0XU		
Project Description	Proposed Equestrian Arena		
Drawing Title	Proposed Arena Site Plan		
Drawing No.	2640-1108	Rev.	B