

CDM REGULATIONS

Safety, Health + Environmental Information

In addition to the hazards / risks typically associated with the types of work detailed on this drawing, please NOTE the following advisory statements. Notes may relate to CONSTRUCTION, MAINTENANCE + CLEANING, and / or DEMOLITION; however this list is not exhaustive.

rev	description	date	dr by	app by

It is assumed that all works are to be carried out by a competent contractor working, where appropriate to an approved method statement.

NOTES

This drawing is subject to copyright and must not be reproduced, stored or transmitted in any form without prior permission from Walker Dsp Architects LLP.

This drawing may also include Ordnance Survey or raster data reproduced under license.

All work shall be carried out in accordance with Local Authority, Statutory Authority and Health + Safety Regulations.

Cease all construction work immediately if any protected species is suspected to be present within an existing building or new development site. A qualified ecologist must be consulted to carry out the relevant survey and provide mitigation advice prior to (re)commencing construction.

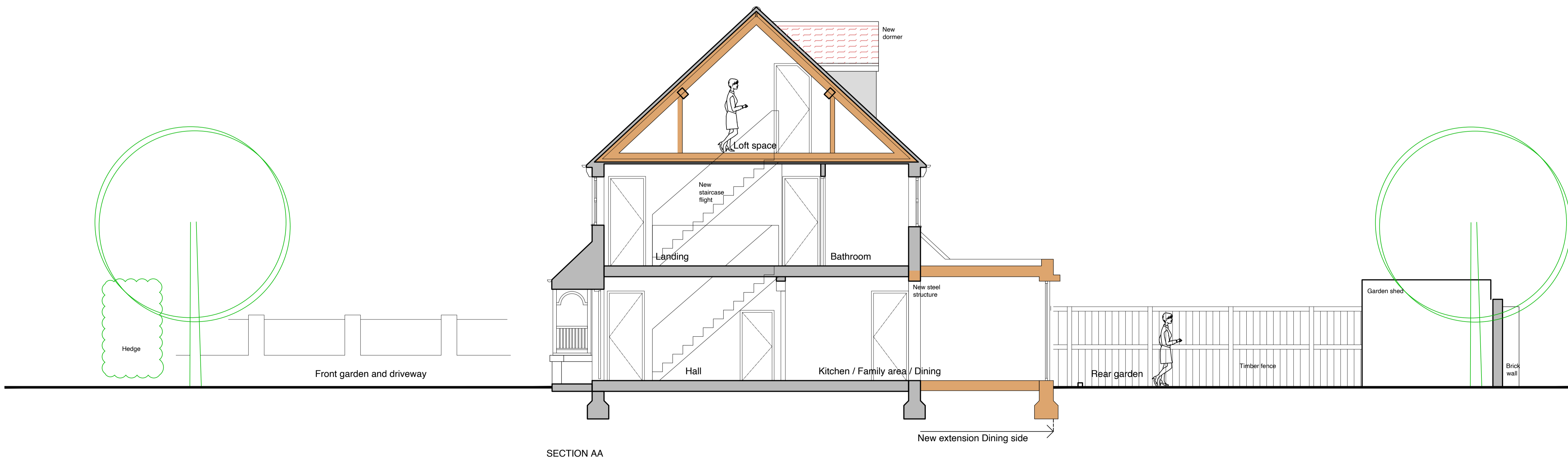

SECTION AA

rev	description	date	dr by	app by

status **Planning**

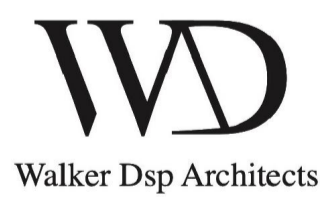

Walker Dsp Architects
42 Oxford Street
York, YO24 4AW
United Kingdom
Tel: +44(0)1904 659900
www.walkerdsp.com

client **Mr. & Mrs. Bell**

project **Refurbishment and rear extension
3 Lock House Lane
Earswick, York, YO32 9FT**

drawing title **Proposed section AA**

scale @ A1	project No	drawing No	rev
1:50	848	P27	D

This drawing is to read in conjunction with all related drawings. Do not scale from this drawing. All dimensions must be checked and verified on site before commencing any work or producing shop drawings. The originator should be notified immediately of any discrepancy. Walker Dsp Architects & logo are a Trademark registered in Great Britain and Northern Ireland. © Walker Dsp Architects 2020