





-  Existing planting
-  Application site
-  Additional land within applicants ownership
-  Demolitions

Notes
Do not scale from this drawing.
Check all dimensions on site prior to construction.

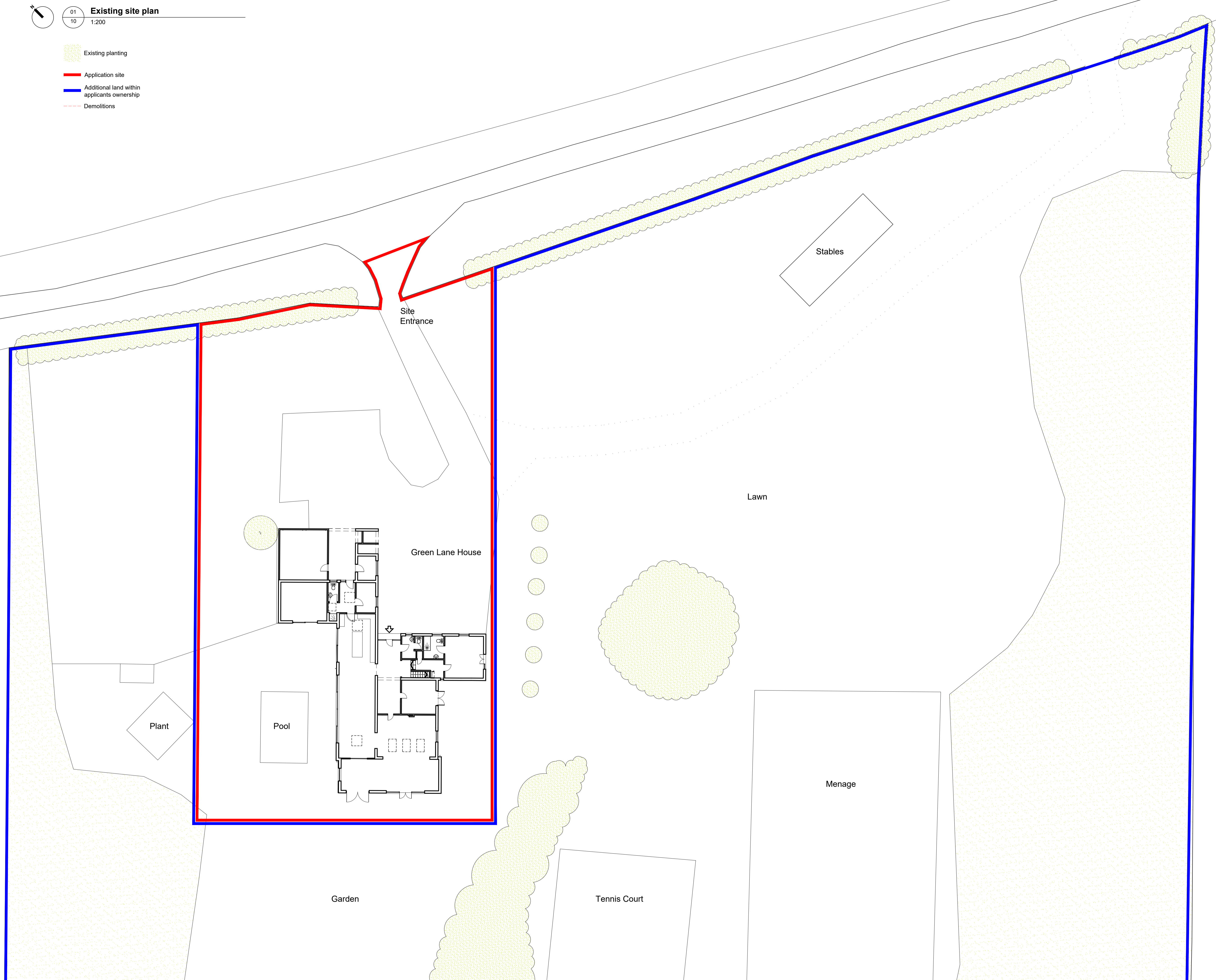

RevB 17.10.22 General revision
RevA 10.10.22 General revision

PLANNING APPLICATION

Lucas+Western Architects

Project
Green Lane House
Ixworth Thorpe
IP31 1QN

Drawing
Existing
Site Plan

Scale 1:200 @ A1
Date October 2022
Drawn JH
No. 2209.10 Rev. B

This drawing is copyright of Lucas+Western Architects, Ltd and may not be reproduced without the prior written consent.