

Left side Elevation

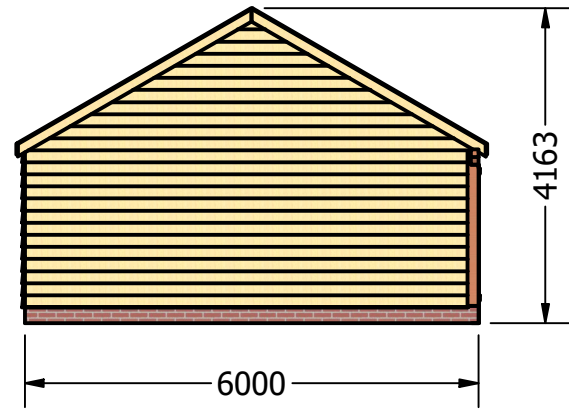

Front Elevation

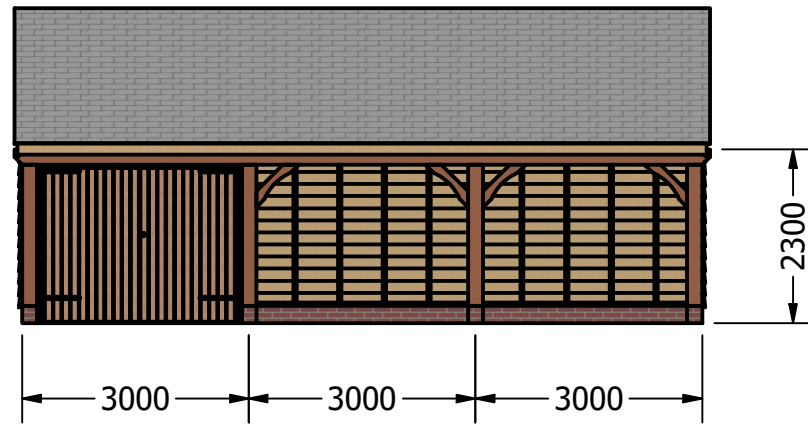

Right side Elevation

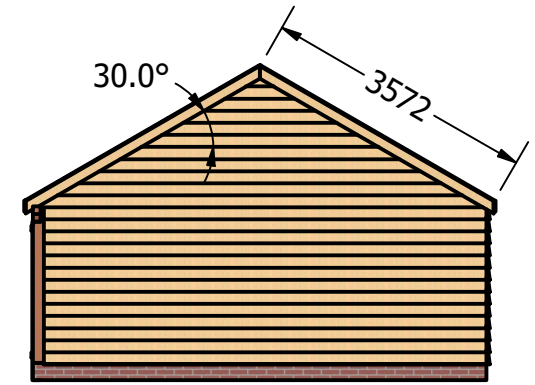

Roof Line

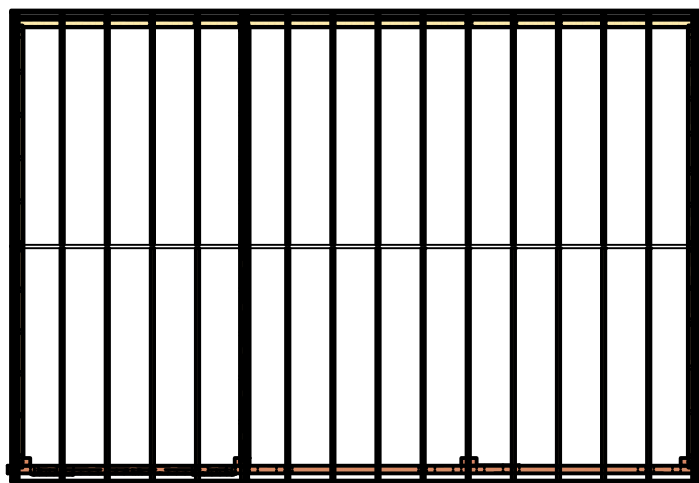

Rear Elevation

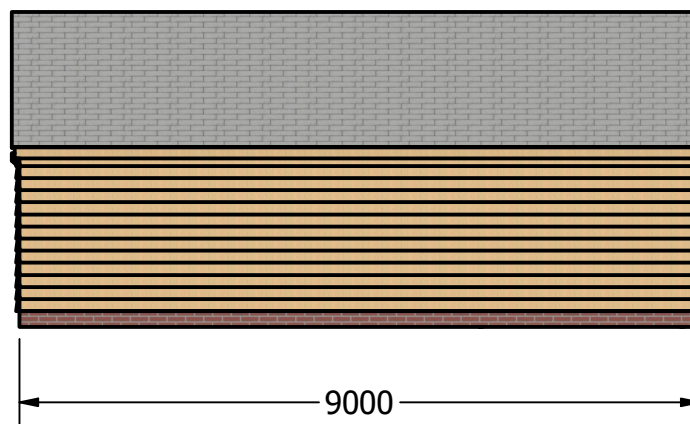

Floor Plan

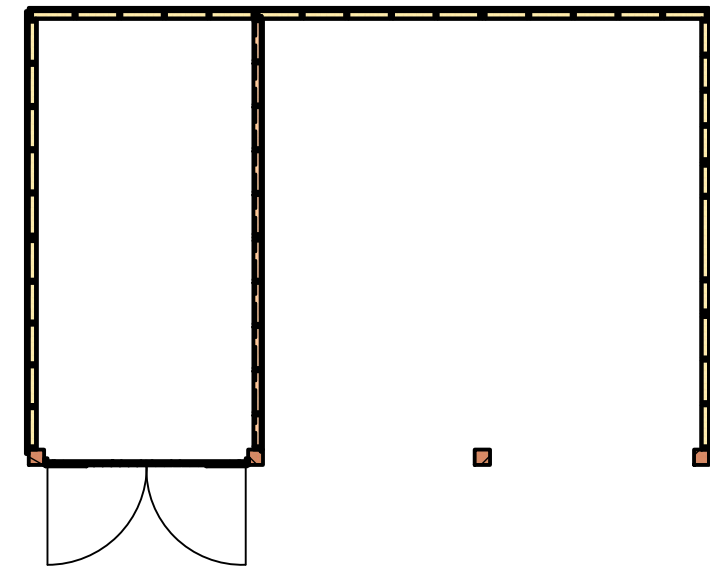

Specification:

Framing: EX100mm x 50mm PAR redwood

Cladding: EX 200mm x 20mm Sawn feather edge

Roof Structure: Apex Style: Hand cut roof using EX150mm x 50mm rafters, EX200mm x 50m ridge beam and EX150mm x 50mm ceiling ties

Roof Line: Timber Fascia, soffit and Barge boards fitted as required.
Black UPVC Guttering fitted to both sides complete with down pipes

Doors: 1 X 2700 X 2100 Double door set to front elevation - Hung on heavy duty ironmongery and secured with a throw-lock and pull handle

Internal: All studwork and roof frame left open.
1no. Full height internal walls to separate open and secure bays

Treatment: Exterior walls and frames dip treated with Light Brown wood protector and finished with Black Barn paint

Roofing works:

Description: Erect Scaffold. Roof existing tiles, batten and under felt.
Install 450mm DPC and PVC Bird coombe to roofline.
Cover roof with membrane, 25mm x 50mm pressure treated batten and finish with Slates. Cement bed verge and ridge tiles

DRAWN	Kamil.Brzeski	28/05/2021
CHECKED		
QA		
MFG		
APPROVED		

SCOTT TIMBER BUILDINGS		
TITLE		
SIZE	DWG NO	REV
A3	Mrs Hargrave - Proposed Elevations	
SCALE	SHEET 1 OF 1	
1 / 100		