

DO NOT SCALE FROM THIS DRAWING: ALL DIMENSIONS TO BE CHECKED ON SITE ANY ERRORS OR DISCREPANCIES TO BE REPORTED TO THE ARCHITECT IMMEDIATELY.

SITE INFORMATION SUPPLIED BY THIRD PARTIES CANNOT BE GUARANTEED FOR ACCURACY. ALL FEATURES AND DIMENSIONS ARE SUBJECT TO CONFIRMATION BY LEGAL SERVICE AND UTILITY DOCUMENTATION AND DETAILED TOPOGRAPHICAL SURVEY.

COPYRIGHT RETAINED BY HUGH MASSEY ARCHITECTS (HMA NE LTD)

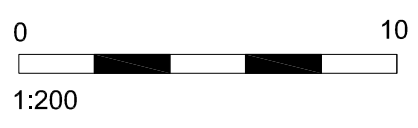
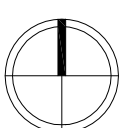
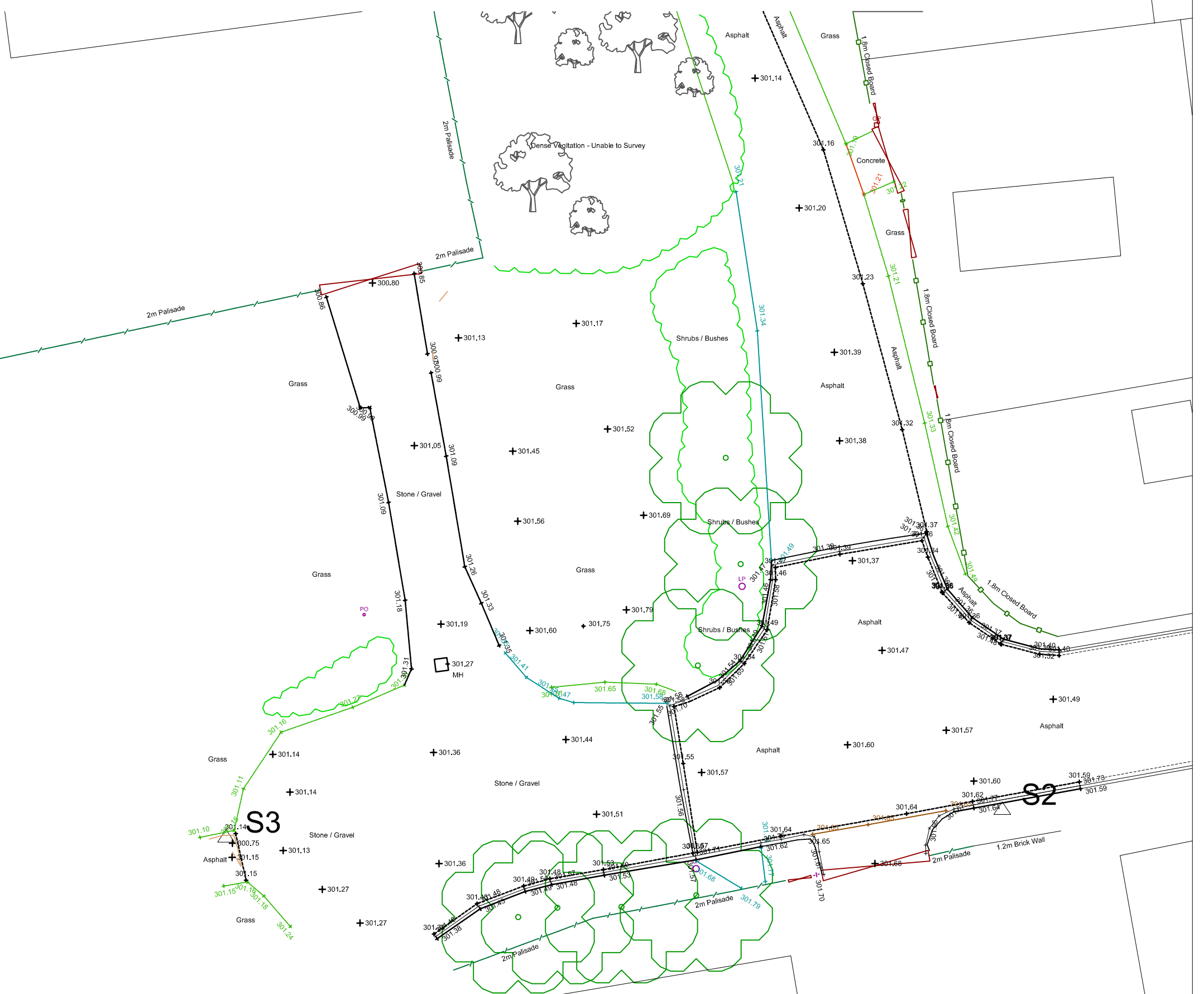

Dr Surgery

Hugh Massey Architects, Planning & Landscape Consultants

REVISIONS A: 131022.D0 Revised		PROJECT: Proposed Car Park Tow Law		designhaus, 205 Park Road, South Moor, Stanley, Co.Durham, DH9 7QE t: 01207 280095 f: 01207 280531 e: central.administration@hughmasseyarchitects.co.uk	
DRAWING: Existing Site Plan, Southern Section CLIENT: Tow Law Town Council		SCALE: 1:200 PAPER: A3		DRAWN: DO	
JOB NO: 1710	DRAWING NO: 04	REVISION: A	ORIGINATION DATE: 30-09-22	DRAWING STATUS: Existing	CHECKED: HM