



**East Devon  
Tree Care**

**ARBORICULTURAL METHOD STATEMENT FOR TREE PROTECTION  
THROUGHOUT CONSTRUCTION**

<b>Site Address</b>	Woolaway, 2 Exeter Road, Silverton, EX5 4HX
<b>Client</b>	Tarl Martin
<b>Local Authority</b>	Mid Devon District Council 01884 255255
<b>Prepared By</b>	Matthew Shute, FdSc Arboriculture, M.Arbor.A  East Devon Tree Care Ltd Blackhill House Woodbury, Exeter EX5 1HE
<b>Report Reference</b>	MART-211119.1 AMS at Woolaway
<b>Version No</b>	2
<b>Date Issued</b>	24.11.21

## CONTENTS

	<b>PAGE</b>
1. PHASE 1: PRE-CONSTRUCTION SITE PREPARATION	3
2. CONSTRUCTION AND DEMOLITION PRECAUTIONS	3 - 4
3. RESPONSIBILITIES	4

## APPENDICES

APPENDIX 1: TREE PROTECTION NOTICES

APPENDIX 2: TREE PROTECTION PLAN MART-211119.1 TPP at Woolaway



## 1. PHASE 1: PRE DEMOLITION AND CONSTRUCTION SITE PREPARATION

- 1.1. The Leyland Cypress recorded as T4 and the sycamores recorded as G1 will be felled.
- 1.2. Tree protection fences will be erected prior to the commencement of any construction works on the site. This fence will demarcate a construction exclusion zone, in which no construction machinery or materials will be stored. The fence will be constructed of 1000mm barrier mesh attached to wooden posts driven into the ground at 1.5m spacings. The position of the fencing will be no closer to any of the trees than the dimensions shown on the Tree Protection Plan- MART-211119.1 TPP. **Please see Appendix 2.**
- 1.3. The tree protection fences will remain in place until all construction work has been completed.
- 1.4. Tree protection notices as per **Appendix 1** shall be attached to the tree protection fence at 10m spacings.

## 2. CONSTRUCTION AND DEMOLITION PRECAUTIONS

### 2.1. CONSTRUCTION OF NEW DWELLING

- 2.1.1. No new services are to be installed within the root protection areas (RPAs) of any of the trees on the site.
- 2.1.2. A rise or reduction in soil level can have major implications on the longevity and health of the trees. Minor changes (up to 100mm) can be tolerated in some cases but is heavily dependent on tree species, condition, and growing environment. There will be no ground-level changes within the RPAs of any retained trees, without prior approval from Mid Devon District Council.
- 2.1.3. Site huts and toilets are to be located anywhere on the site outside of construction exclusion zones.
- 2.1.4. Materials that may contaminate the soil will not be discharged within 10m of any tree stem. When undertaking the mixing of materials, it is essential that any slope of the ground does not allow contaminants to run towards a tree root area. Water must be readily available on-site and will be used to flush spilt materials through the soil and avoid contamination to tree roots. At the time of any spillage, the main contractor will contact the site Arboriculturalist for advice.



2.1.5. No mixing or storage of materials will take place within the RPAs or up a slope where they may leak within 10m of any tree which is to be retained. Mixing of sand/cement and other wet products will be undertaken on the existing drive and not on the lawn to the south of the house where runoff can spill into root protection areas.

## 2.2. DEMOLITION OF EXISTING DWELLING

2.2.1. The demolition of the existing building will be inwards and within the footprint of the existing building. All plant used in the demolition of and subsequent removal of the existing building will be used strictly on the southern side of the existing property only. No plant will be permitted north of the existing building to avoid any potential conflict with trees on the site.

## 3. RESPONSIBILITIES

- 3.1. Tarl Martin will be responsible for the erection and maintenance of the tree protection fence and ensuring all subcontractors adhere to the general precautions outlined in this method statement.
- 3.2. Matthew Shute will make one initial scheduled site visit to confirm the correct position and type of tree protection fence that has been used. Matthew Shute will make a second site visit on completion of the project before the removal of the tree protection fence.





**PROTECTIVE FENCING. THIS  
FENCING MUST BE  
MAINTAINED IN ACCORDANCE  
WITH THE APPROVED PLANS  
AND DRAWINGS FOR THIS  
DEVELOPMENT.**



**TREE PROTECTION AREA  
KEEP OUT!**  
(TOWN & COUNTRY PLANNING ACT 1990)  
TREES ENCLOSED BY THIS FENCE ARE PROTECTED BY  
PLANNING CONDITIONS AND/OR ARE THE SUBJECTS OF A  
TREE PRESERVATION ORDER.  
CONTRAVENTION OF A TREE PRESERVATION ORDER MAY  
LEAD TO CRIMINAL PROSECUTION

**ANY INCURSION INTO THE PROTECTED AREA MUST BE  
WITH THE WRITTEN PERMISSION OF THE LOCAL  
PLANNING AUTHORITY**

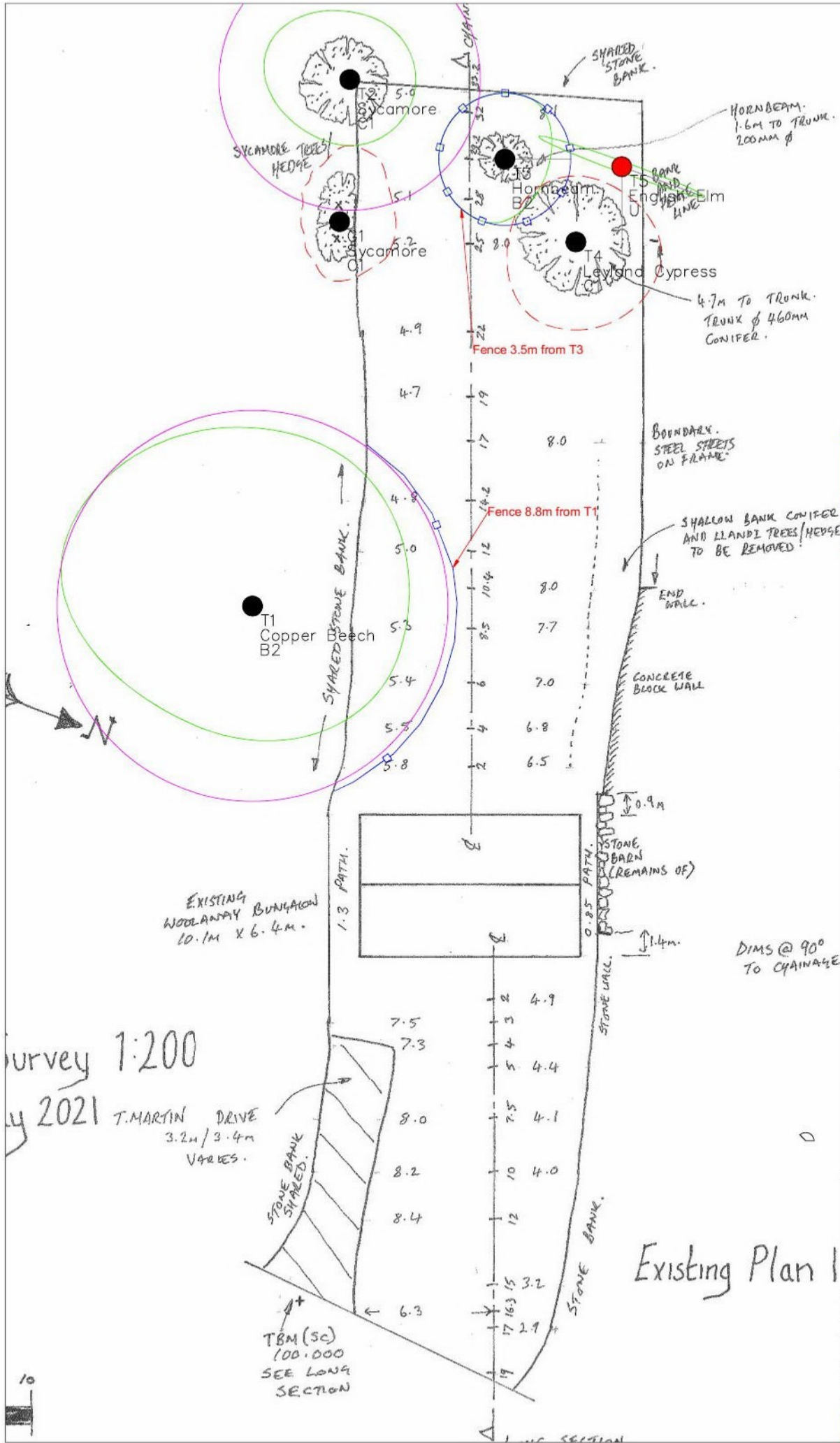

BlackhillHouse  
 Woodbury  
 Devon  
 EX5 1HE  
 Tel: 01395 279101  
 info@eastdevontreecare.co.uk

**Legend**

- Tree to be retained
- Tree to be removed
- Root Protection area of tree to be retained
- Light duty tree protection fence: Barrier mesh attached to wooden stakes at 1.5m spacings. Minimum distance from trees as shown on plan

- General Precautions**
- No access to the RPA's of the retained trees will be permitted before or during construction activity, without prior consent of the local planning authority. Protective fencing must remain in situ for the duration of the development works. During the course of the construction works, the tree protection fencing should not be moved nor should anyone enter the fenced area without first seeking advice from the site Arboriculturalist.
  - All services should be routed outside of the root protection area where possible. Where services must be installed within the RPA these must be installed using trenchless techniques and at a minimum depth of 600mm where possible.
  - No materials, site offices, liquids or fuels are to be stored within the protective fencing.
  - Ground levels within the RPA should not be lowered or raised without prior approval from the local planning authority.
  - Where existing vegetation is to be removed within the RPA, stumps should be ground and not removed with heavy machinery.
  - Care should be taken at all times when working adjacent to the protective fencing and all works involving mechanical swing arms should be supervised by a banksman to ensure that there is no contact with retained trees.
  - No fires are to be lit within 10m of the protective fencing.
  - No signs or wires are to be attached to any trees.
  - Areas must be identified well away from the fenced area of protected trees for concrete mixing areas, etc. In general these should be at least 10m from the trunks of the retained trees.
  - Any spillage of liquids or chemicals near trees must be contained as soon as possible to minimise any ground contamination. Further advice must then be sought from the site Arboriculturalist.

- Responsibilities**
- The main contractor shall be responsible for adhering to all tree protection measures.
  - Tree protection fences and ground protection must be installed prior to any construction activity on site. The main contractor will make daily checks to inspect the position and integrity of ground protection and tree protection fences. The Project Arboriculturalist will make scheduled site visits to inspect the position and integrity of tree protection fences. A log of these inspections will be made and retained for the duration of the project

Drawing Based Upon:	Proposed Plan: Existing Site Plan
Client:	Tari Martin
Project:	Replacement dwelling at Woolaway
Title:	TREE PROTECTION PLAN
Date:	24.11.21 Scale: 1:200 Original Paper Size: A3
Figure Number:	001 Rev: B
Status:	FINAL Do not scale from this drawing

Survey 1:200  
 July 2021 T. MARTIN DRIVE  
 3.2m / 3.4m  
 VARIES.

Existing Plan 1

