

Proposed Front Elevation 1:100 @ A1

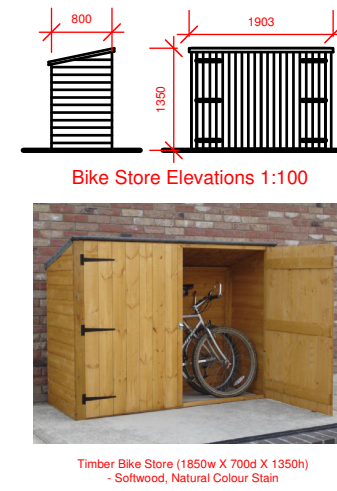

Bike Store Elevations 1:100
Timber Bike Store 1450mm x 700mm x 1500mm
Softwood, Natural Colour Stain

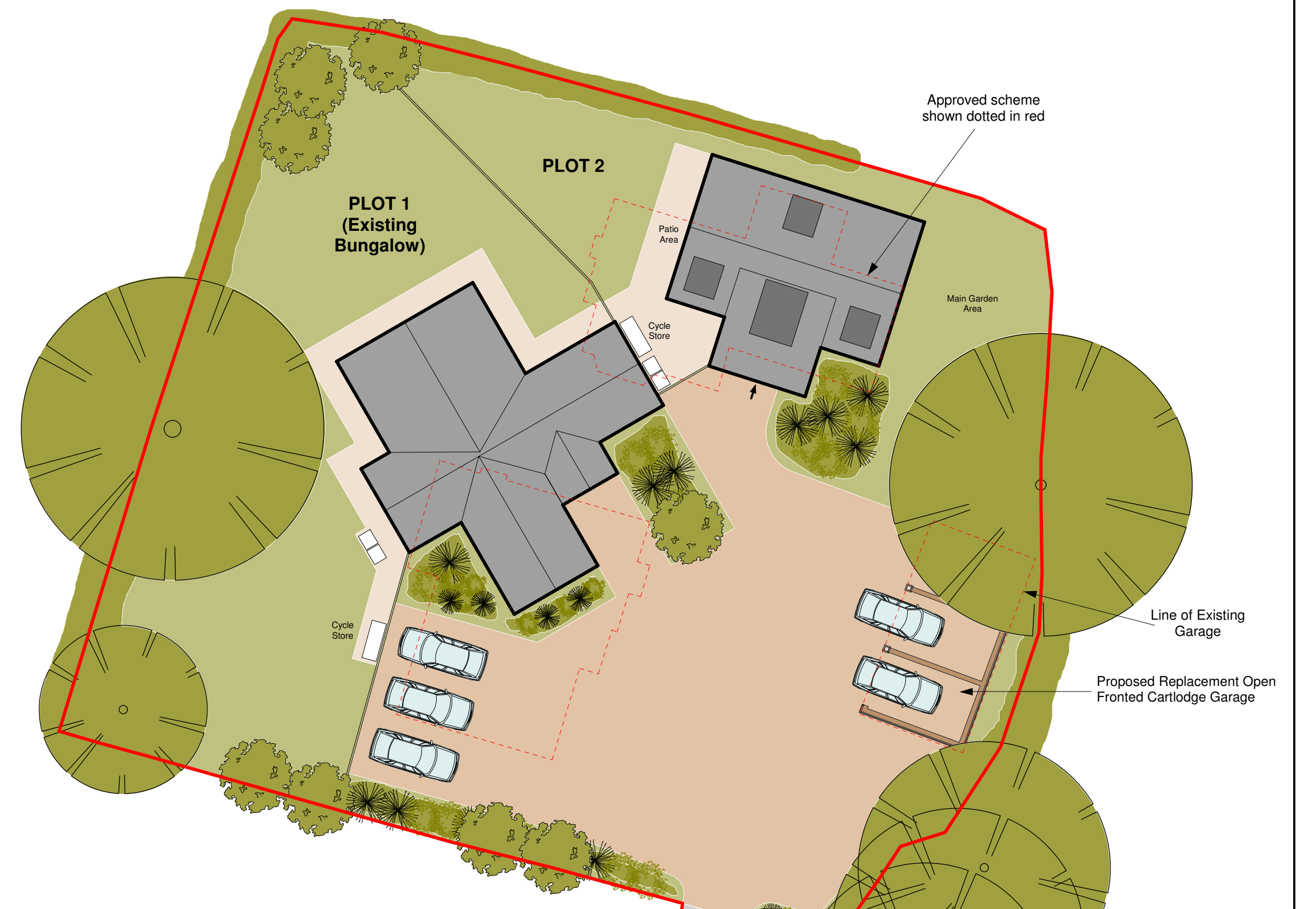

Proposed Site Plan 1:200 @ A1

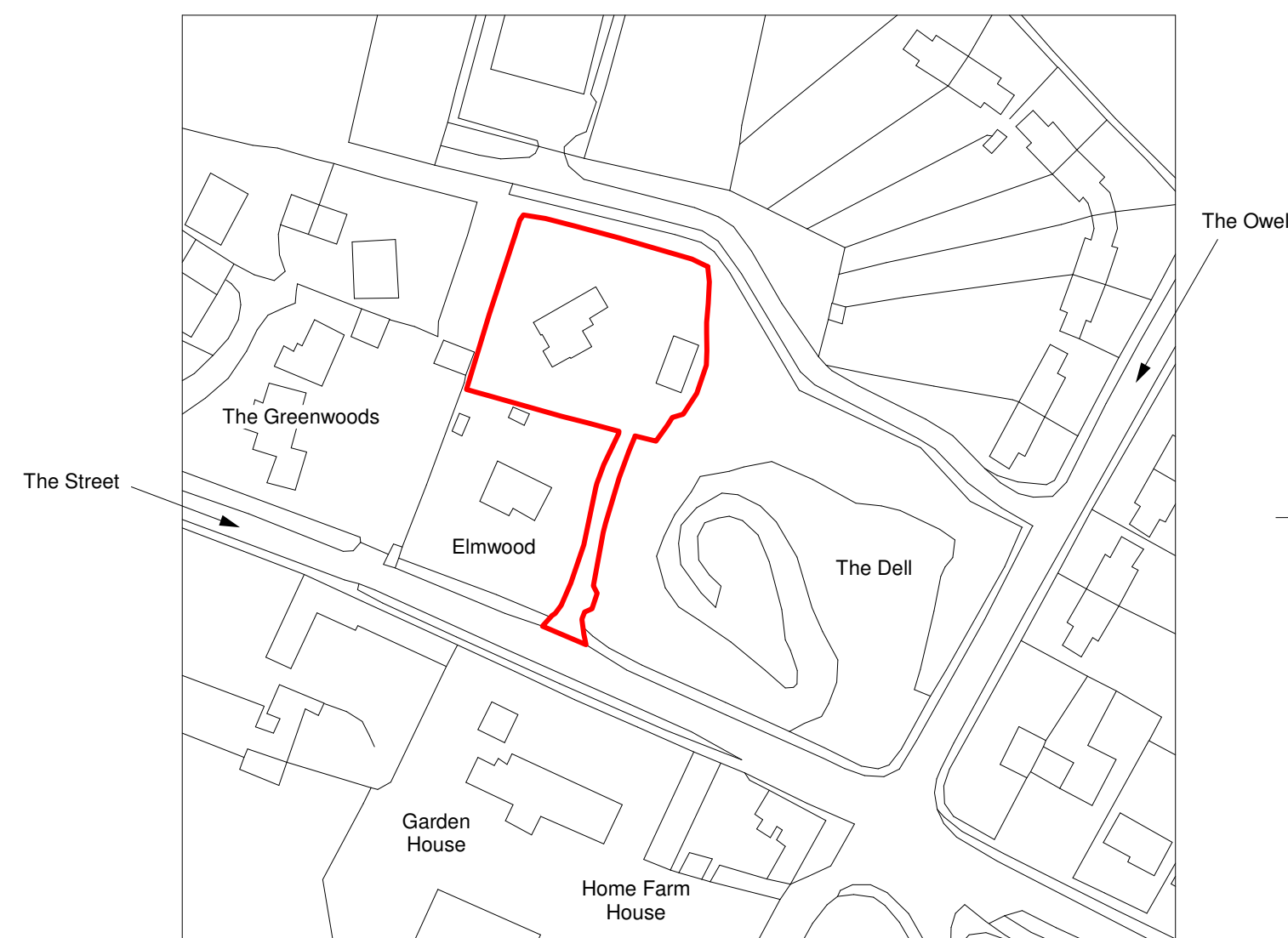

Location Plan 1:1250 @ A1

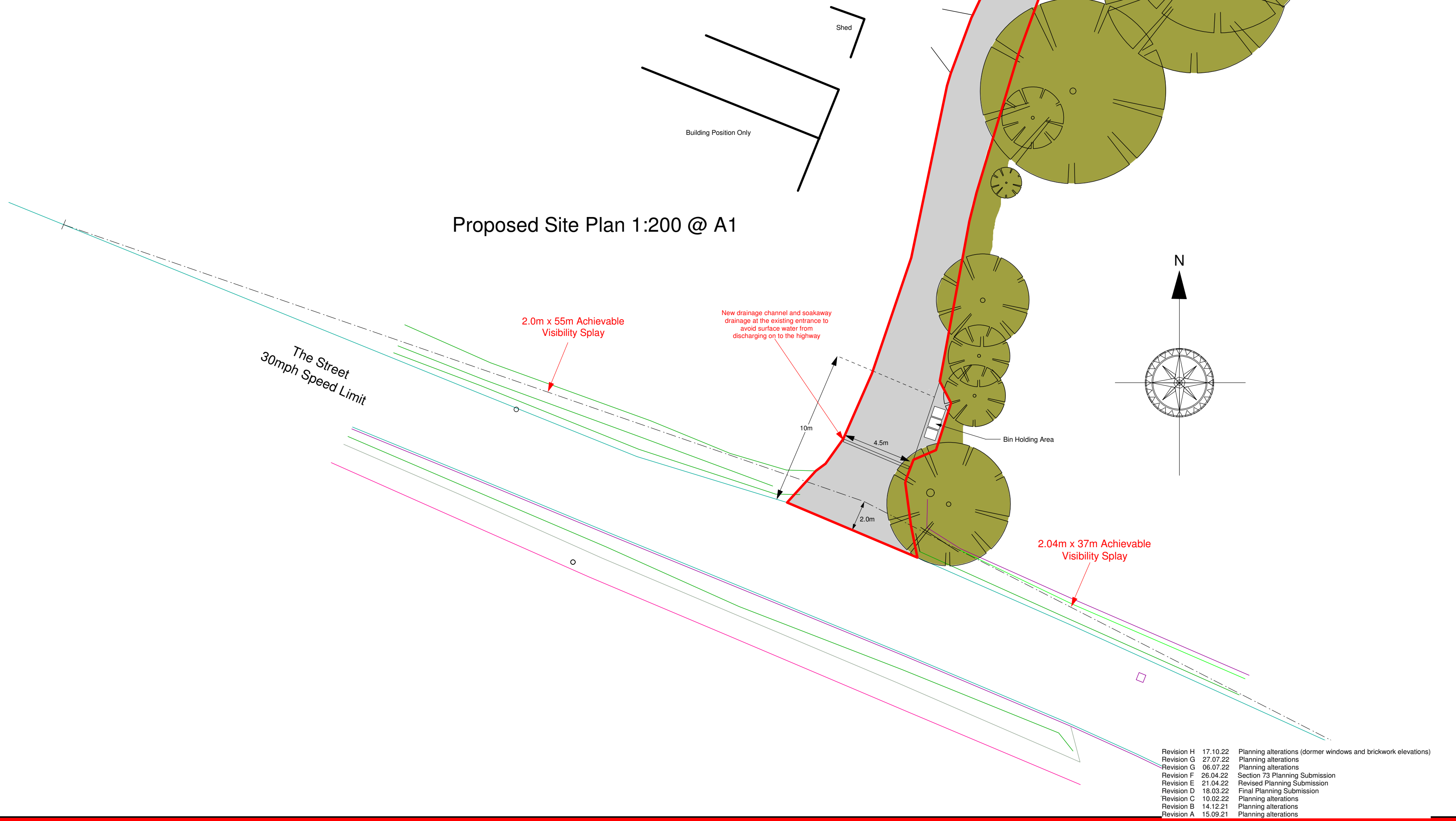

Revision H 17.10.22 Planning alterations (dormer windows and brickwork elevations)
 Revision G 27.07.22 Planning alterations
 Revision G 06.07.22 Planning alterations
 Revision F 26.04.22 Section 73 Planning Submission
 Revision E 21.04.22 Revised Planning Submission
 Revision D 18.03.22 Final Planning Submission
 Revision C 10.02.22 Planning alterations
 Revision B 14.12.21 Planning alterations
 Revision A 15.09.21 Planning alterations

Anglia Design
 architects . surveyors

mail@angliadesign.co.uk www.angliadesign.co.uk

London Office: 30 Robin House, Newcourt Street, St Johns Wood, London NW8 7AD
 tel: 020 7722 9558 fax: 0870 131 3804

Norwich Office: 11 Charing Cross, Norwich, Norfolk, NR2 4AX
 tel: 01603 696576 fax: 01603 764332

THE DELL, THE STREET, PAKENHAM, SUFFOLK, IP31 2JX.

PROPOSED SITE PLAN

**Proposed Residential Development at
 The Dell, The Street, Pakenham,
 Bury St. Edmunds, Suffolk, IP31 2JX.
 For Mr. G. Lebbon**
 Date: May 2021 Scale: 1:200 Dwg No. TL-4547-21-2H
Proposed Site Plan