

No dimensions are to be scaled from this drawing; all dimensions and sizes to be verified on site.

No structural information is to be taken from these drawings - refer to Structural Engineer's drawings.

Rev:	Description:	Date:
A	Revisions for Faculty App.	Feb 2022
B	Revisions for Faculty App.	Apr 2022
C	ASHP Enclosure Elevations inc.	Sept 2022

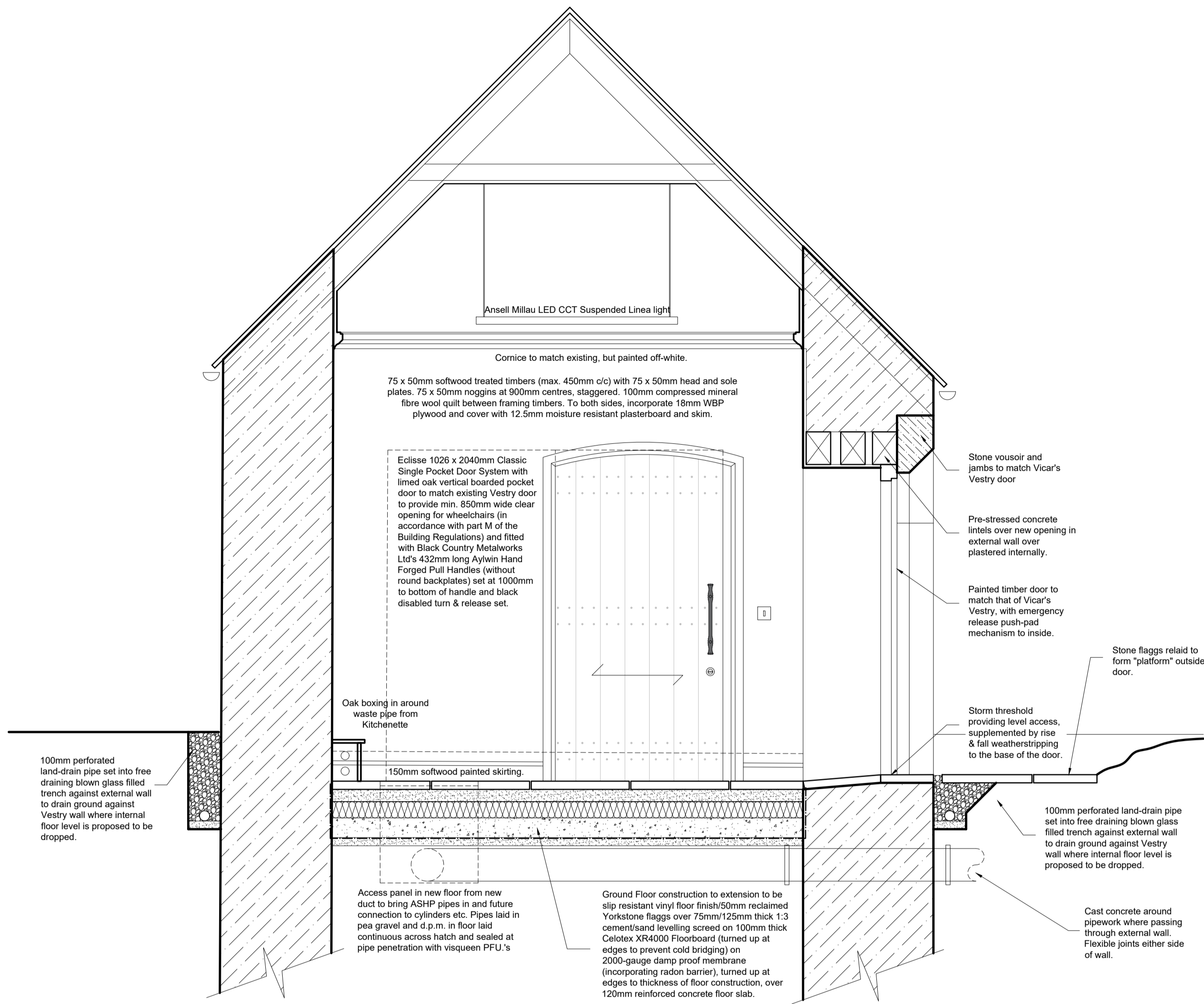

Proposed Alterations to Vestry - Elevation

(Scale 1:20)

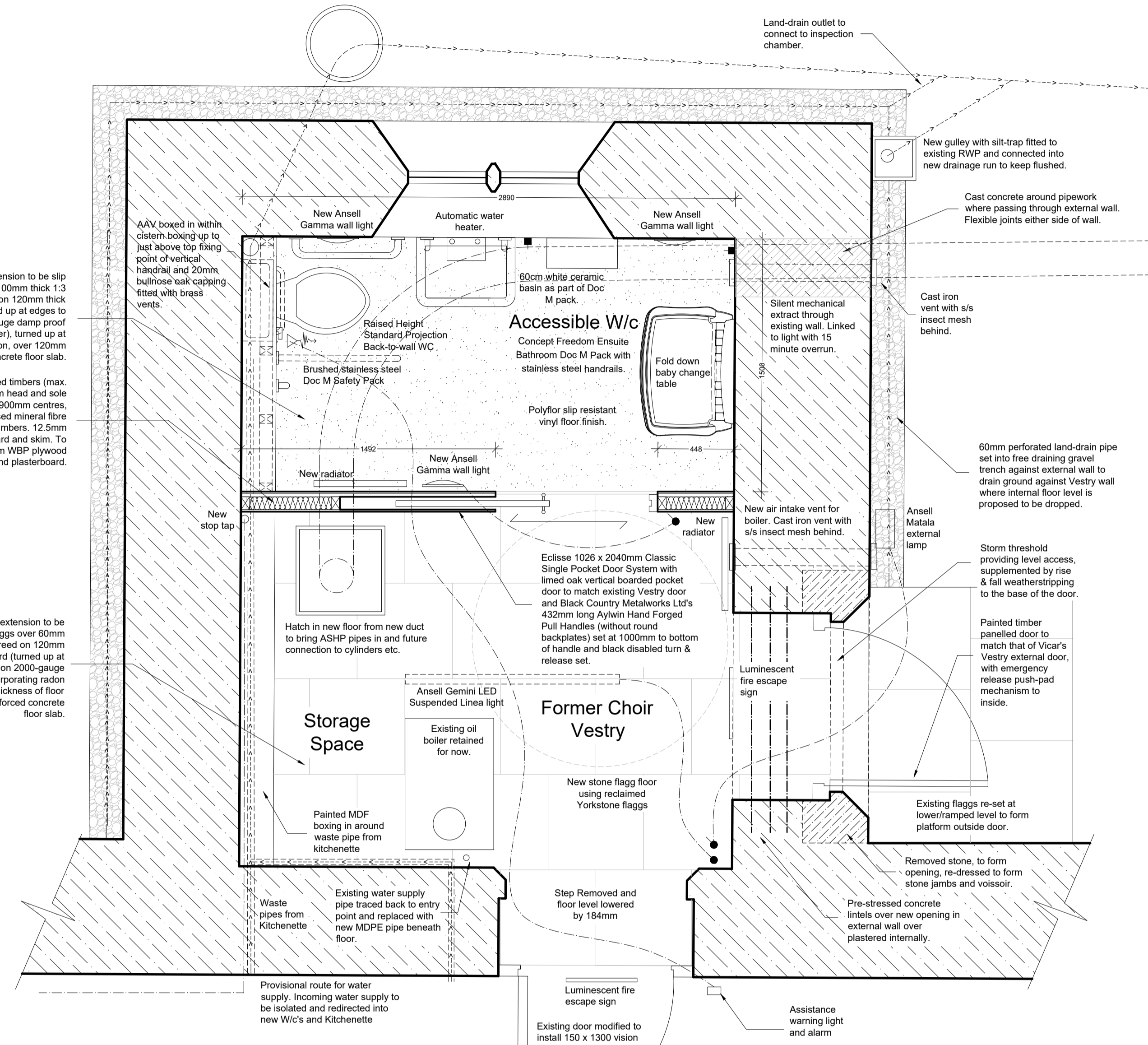

Proposed Alterations to Vestry - Plan

(Scale 1:20)

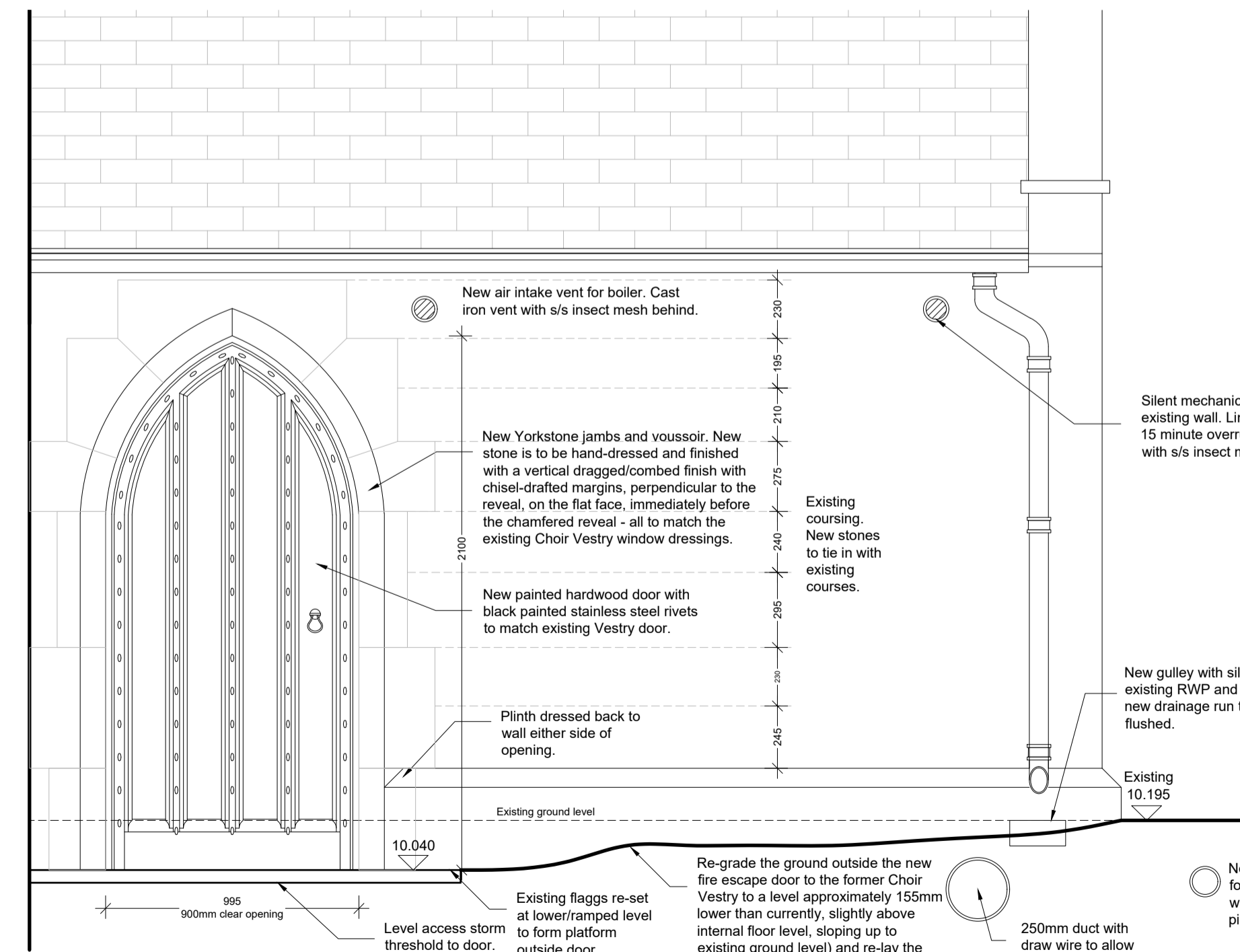

Proposed East Elevation of Former Choir Vestry

(Scale 1:20)

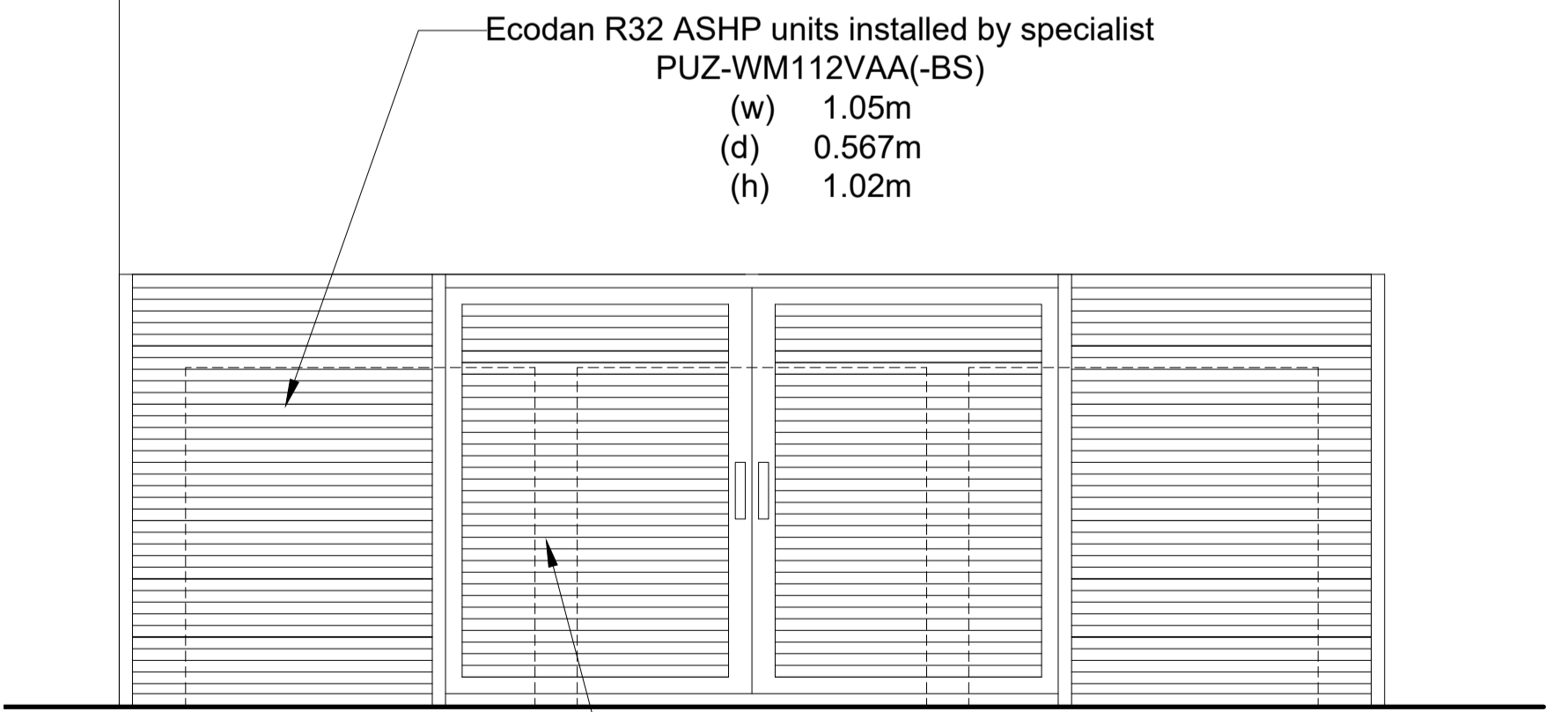

Proposed East Elevation of ASHP Unit Enclosure

(Scale 1:20)

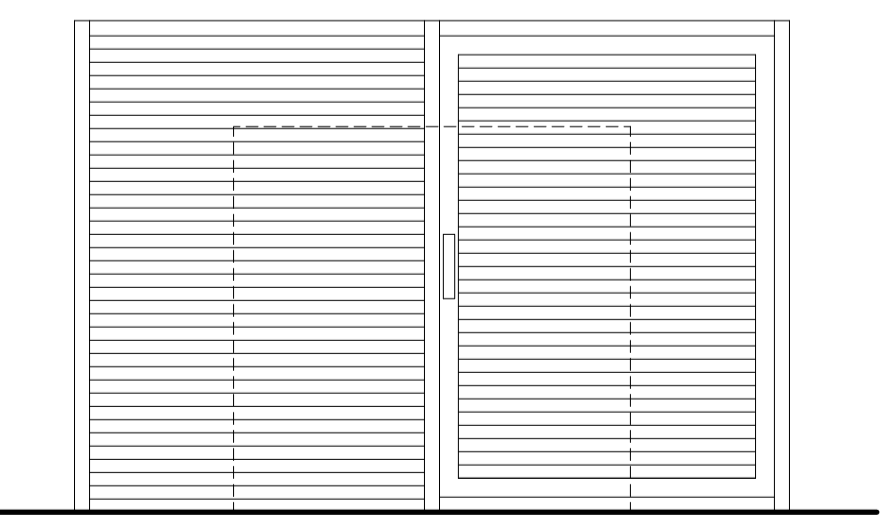

Proposed South Elevation of ASHP Unit Enclosure

(Scale 1:20)



T: 01433 440 466 E: info@tomcrooksarchitecture.co.uk

Client: PCC of St. Mary the Virgin Church, Hook

Job Title: Proposed Church Development Project at St. Mary's Church, Hook, Goole Phase 1

Drawing Title: Proposed Alterations to Vestry

Scale: 1:20 @ A1 Drawn By: TJC Date: Dec 2021

Job No: HGSM03 Drawing No: P/05 Revision No: C