

Lansdowne, Fosse Way, Somerset, Shepton Mallet, BA3 4RF

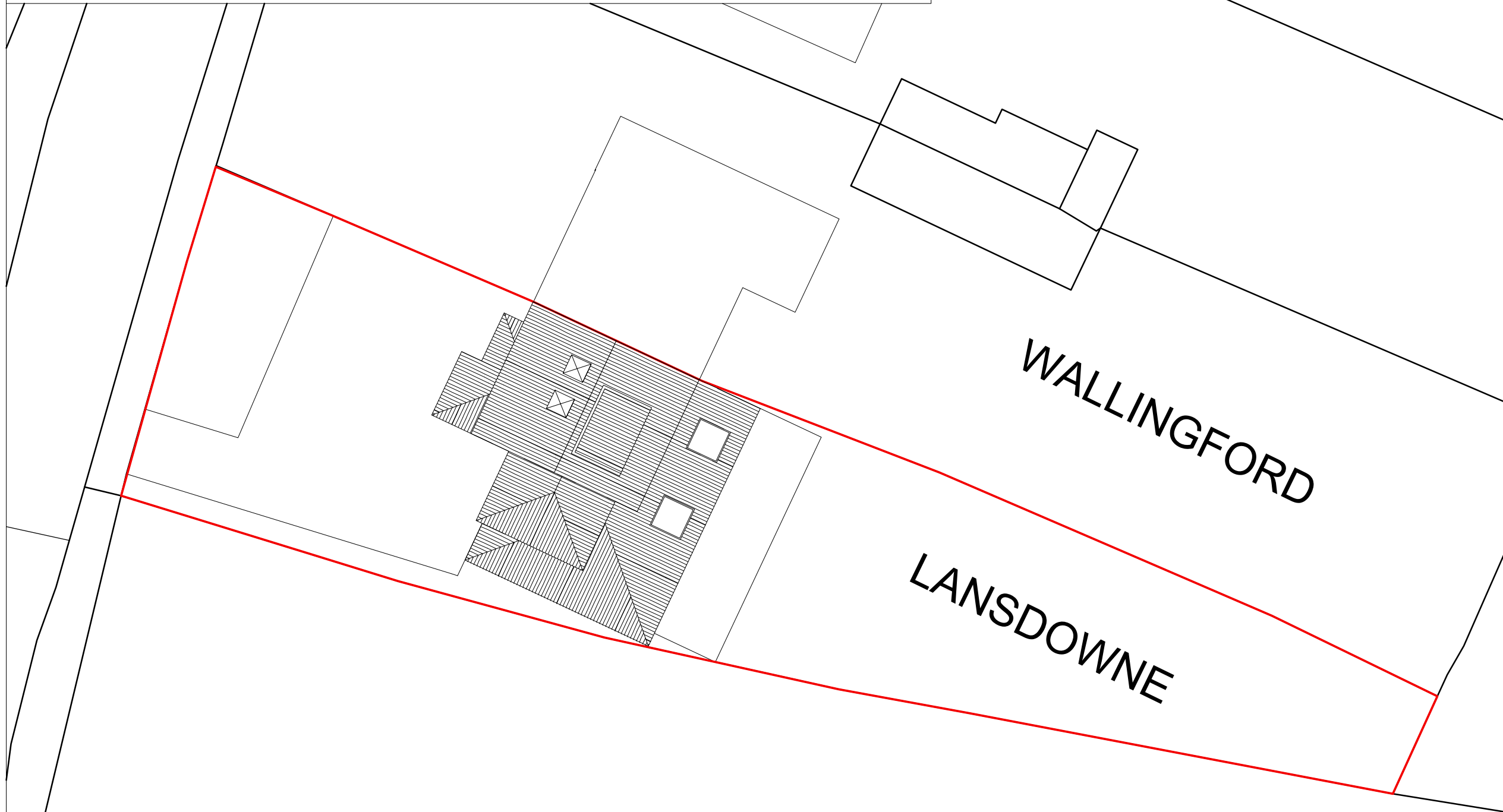

GENERAL NOTES

This drawing has been prepared based upon survey and other information supplied by others.

All dimensions and labels are to be checked on site by contractors and inconsistencies reported immediately to Plots and Plans Ltd prior to works being undertaken.

This drawing is to be read in conjunction with all other relevant Plots and Plans drawings, specifications, schedules and other consultants information, relating to the project or projects for which this drawing has been prepared.

This drawing does not constitute compliance with the Party Wall Act 1996 - responsibilities including notification under the Act are to be checked separately and clarified prior to works commencing.

Contractors are to ensure that all works under their responsibility or the responsibility of their sub-contractors are constructed and / or manufactured to comply with all relevant national and / or local authority statutory requirements and in accordance with local building control and codes of practice.

All proprietary products/systems shown on this drawing are to be installed in strict accordance with the manufacturers/suppliers recommendations and details.

These proposals must be inspected against all existing deeds to the property should this information not be provided to Plots and Plans Ltd, it is the client's responsibility to do so.

THIS DRAWING IS COPYRIGHT AND MUST NOT BE REPRODUCED WITHOUT PLOTS AND PLANS LTD PERMISSION

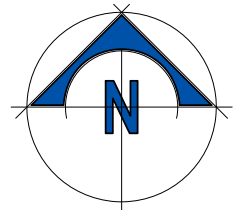

WORK STAGE STATUS

- EXISTING
- CONCEPT DESIGN
- DETAILED DESIGN
- PLANNING APPLICATION
- BUILDING REGULATIONS
- WORKING DRAWINGS

REV	DESCRIPTION	DATE

PROJECT STATUS

PLANNING APPLICATION

DRAWING No: LNW003 REVISION: -

CLIENT

MR N WAKERELL

PROJECT

Lansdowne, Fosse Way, Somerset, Shepton Mallet, BA3 4RF

DRAWING TITLE

PROPOSED SITE PLAN

DATE	SCALE	DRAWN	CHECKED	PAPER
13/07/2022	1:200	JB	-	A3

A3

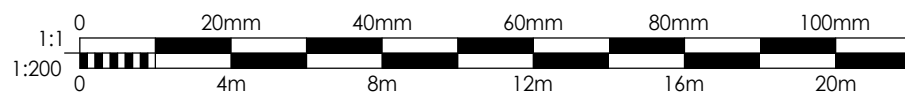

PLOTS AND PLANS LTD
 22 Beauchamp Avenue, Radstock
 OFFICE: 01225 251991
 MOBILE: 07817714353
 E. info@plotsandplansdesign.co.uk
 W. www.plotsandplansdesign.co.uk