

PROPOSED FIRST FLOOR PLAN
1:100 at A1

0 10m

EXISTING WALLS
PROPOSED WALLS
SHARED ACCESS
(Residential and Commercial Use)

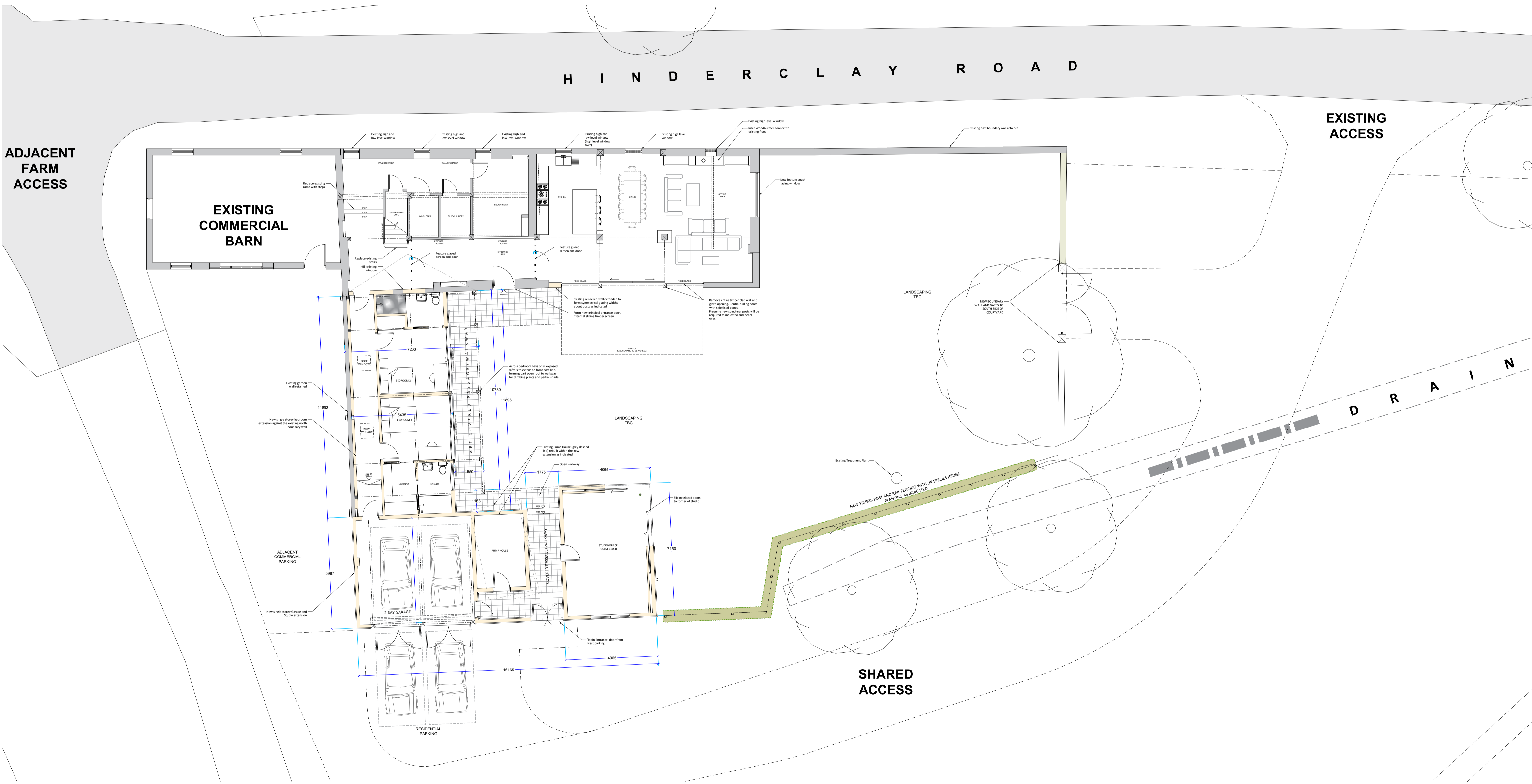

PROPOSED GROUND FLOOR PLAN
1:100 at A1

Tidswell Childs			
Tidswell Childs LLP Tel: 01930 443344			
Project: Barn Conversion from Commercial Use to Single Residential Dwelling, Millings barn, Hinderclay Road, Wattisfield, Steeple Gidding			
Client: M & C LYON	Drawn: JIC	Scale: 1:100 @ A1	Sheet: A1
Drawing Title: PROPOSED GROUND AND FIRST FLOOR PLANS	Date: JULY 2022	Revision: D	Revision Date: 05.09.22
Project Number: 22.020	Drawing Number: 006	Revision: D	Revision Date: 05.09.22