

Please note the area outlined in green with the proposed new dwelling is subject to a Pre-Planning Application and can be adjusted/ revised to follow NKDC Particular Planning Policy associated with new affordable self build homes?

**PLEASE READ IN TANDEM ALL APPS**

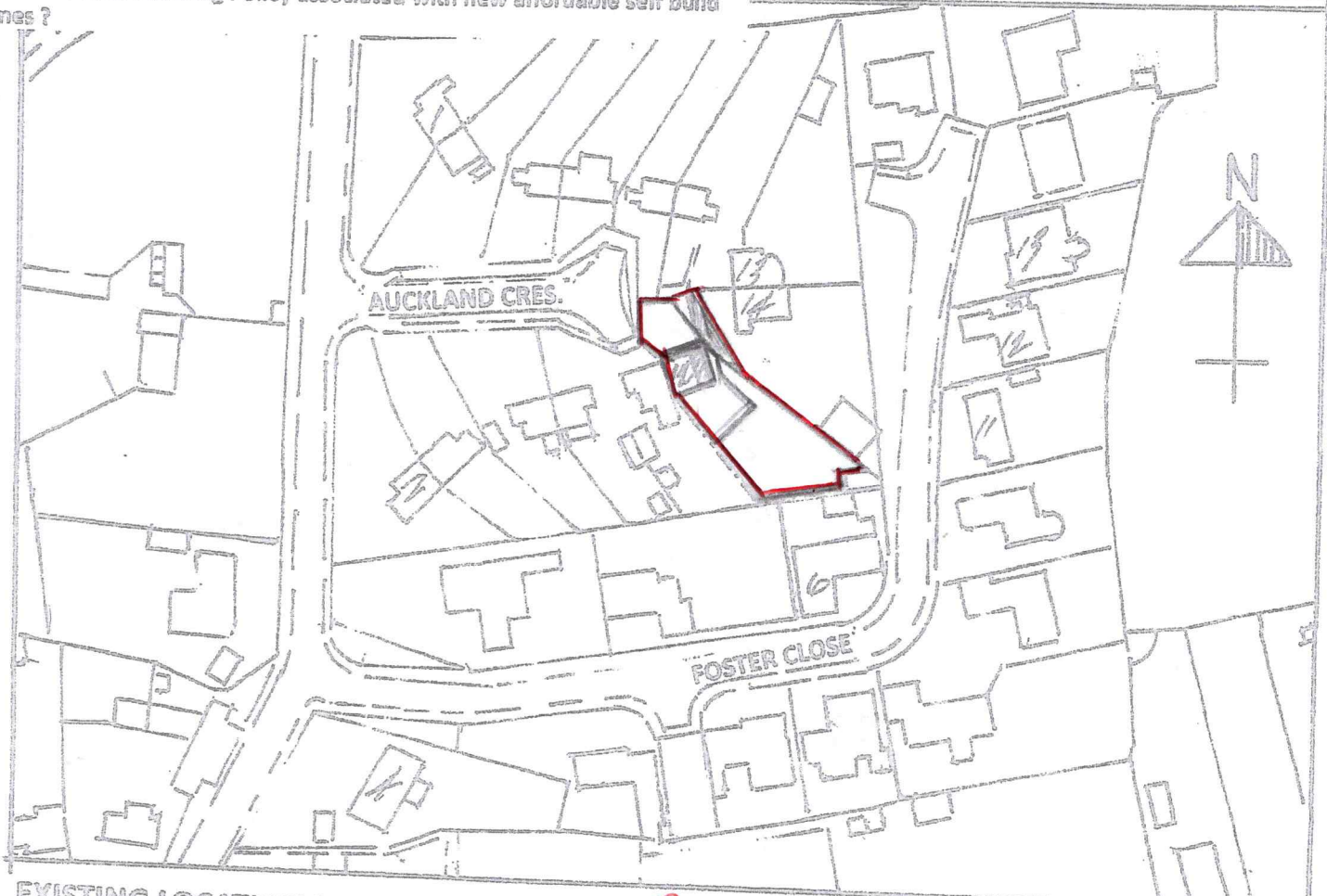

EXISTING LOCATION PLAN SCALE 1: 1250

**RED LINE SHOWN IN ACCORDANCE WITH NKDC LETTER 13.10.22 PARA. 1) REFERS**

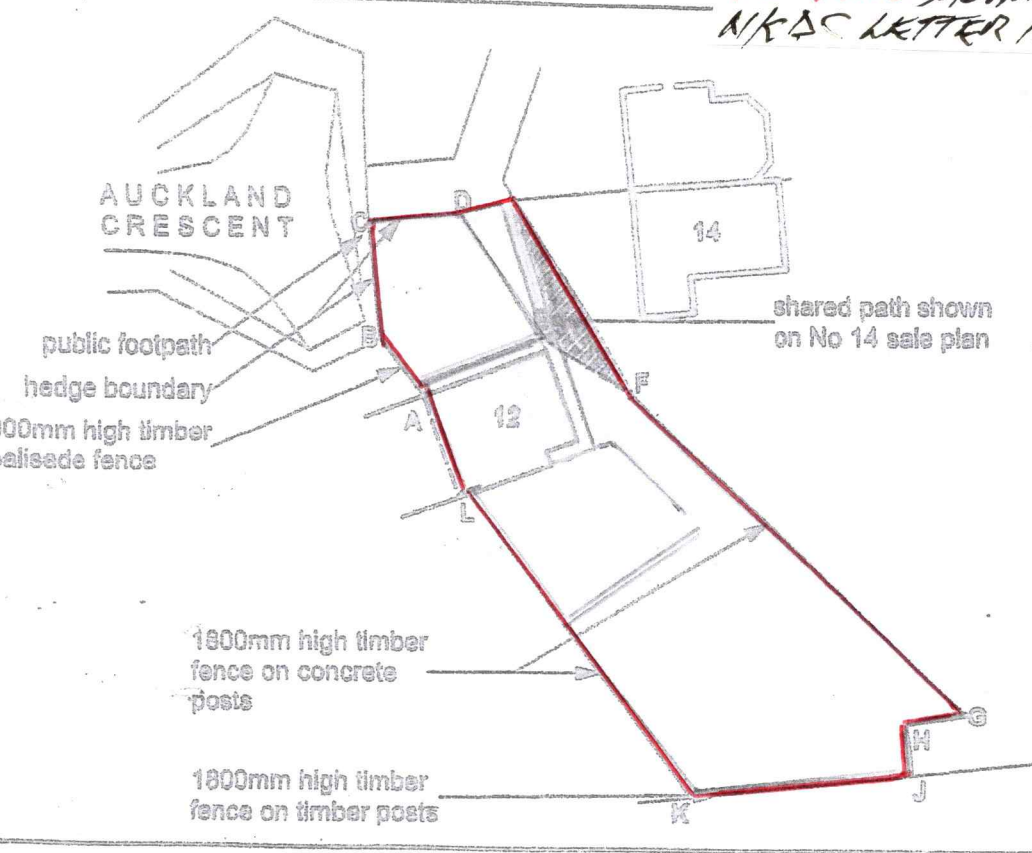

EXISTING BLOCK PLAN FROM TITLE DEEDS No. LL262189 SCALE 1: 500

- A - B 4700mm
- B - C 7800mm
- C - D 6300mm
- D - E 10800mm
- E - F 7400mm
- F - G 30950mm
- G - H 4200mm
- H - J 3450mm
- J - K 15200mm
- K - L 25300mm

Approximate Only

**Note:** Do not Scale from these Plans Drawings Always work to the initial Dimensions which are to be subject To the actual site setting out by the Builder and or Specialist Materials Designer Surveyor appointed by the Client prior to the works starting with Adjustments as necessary and at times At stages to Completion.

See Drg. No. L440/4 for colour Code hatching for shared rights over and joint responsibility!

**DATE 14.10.2022**  
**RED LINE**  
**LOCATION PLAN**  
**SCALE 1:1250**  
**Drg. No L440/LPA**  
**REF. 22/103/FUL.**

Please read all Drawings in Tandem No's L440/1, 2, 3

EXISTING LOCATION AND BLOCK PLAN For Miss E L PADDEN

AT 12 AUCKLAND CRESCENT, TIMBERLAND, LINCOLN, LNA 3RT