

Area not within clients ownership

Area not within clients ownership

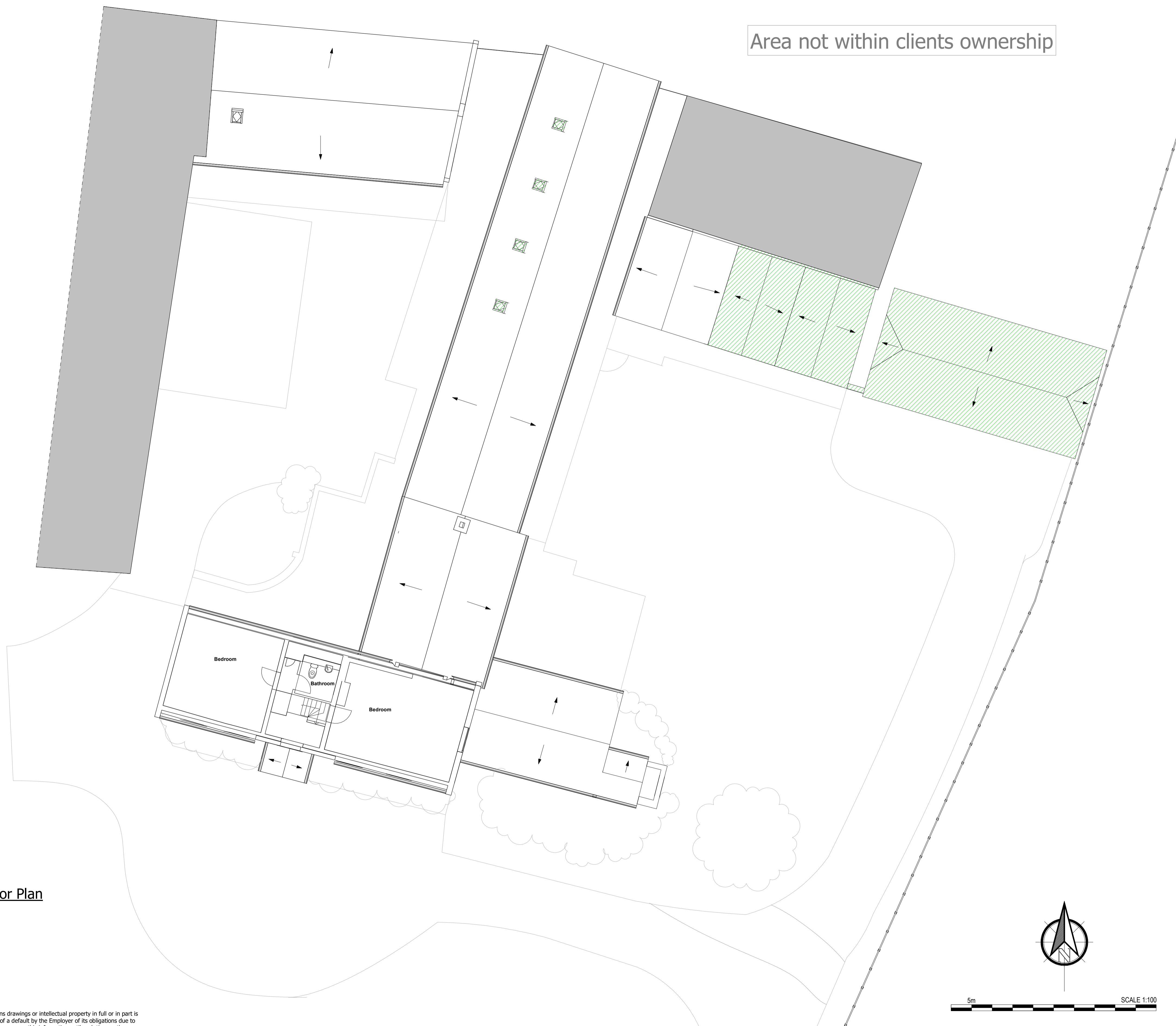

Proposed Second Floor Plan
1 : 100

Notes

1. If in doubt, ask the Project Lead.
2. Do not scale this drawing.
3. All dimensions are in millimetres unless stated otherwise.
4. This drawing is to be read in conjunction with all other relevant drawings and specifications.
5. All Proprietary items to be installed in strict compliance with manufacturers instructions and recommendations.
6. All windows are shown indicatively

Key

- Existing Buildings not in Client's ownership shown indicatively, not to full extent
- Hedge/shrub shown indicatively
- Area of Proposed Works as part of application

P02	Issue for Planning	CP	05.10.22
P01	First issue for information	CP	11.08.22
Rev	Amendments	Rev'd By	Date

Client

Mr & Mrs Dickson

Project
Low Farm Renovation
Moor Lane
Syerston
Title
Proposed Second Floor Plan

Project	Originator	Volume	Level	Type	Role	Number
220051 - WDK - ZZ - 02 - DR - A - 04013						

Internal Project Reference
220051

Suitability | Suitable For
S2 - Suitable for Information

Scale	Created	Revision
A1 @ 1:100	18.07.22	P02

Project Lead	Drawn	CP	Checked	DF
CP				
	Reviewed	DF	Approved	DF
			for Issue	

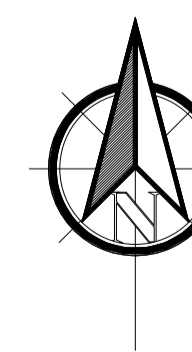

© 2018 WALDECK

1. These drawings are copyright and the property of Waldeck Associates Ltd. Copying of the designs drawings or intellectual property in full or in part is not permitted without the written consent of a Director of Waldeck Associates Ltd. In the event of a default by the Employer of its obligations due to Waldeck Associates Ltd neither it or its Assignees or Beneficiaries are permitted or licensed to use or copy this information until such time as the Employer has remedied its default and the Consultant gives written consent to reinstatement of its permission or licence to use its materials.
2. The initial feasibility pre-contract designs specification, cost plans, bill of quantities, feasibility studies and all other documents or media whether electronic or hard copy are indicative only and could be subject to changes in statute or other rules and regulations and changes in the Employer's requirements and will be subject to design development until such time as Waldeck's Services are engaged under a formal written appointment that pays for an appropriate fee at commercial rates. Use of these documents or media shall be entirely at the risk of the person using it. No reliance on these documents shall be permitted and full copyright is retained by Waldeck. Waldeck accepts no responsibility for reliance on these documents or media and it is assumed that the Contractor or Developer or Client has made sufficient provision for design development risk where a full design has not been commissioned. No waiver of this endorsement shall be permitted except in writing and signed by a Director of Waldeck as recorded at Companies House.
3. "Waldeck" is a Trading Style of Waldeck Associates Ltd registered in England and Wales Company N° 3450319.

