

NOTE: Do not scale dimensions from this drawing. If in doubt refer to JS Design.

This drawing remains the copyright of the JS Design Partnership alone all materials specified must be used in accordance with the manufacturers recommendations and all relevant current codes of practice.

Rev:	Description:	Date:
A	North point added.	23.09.22

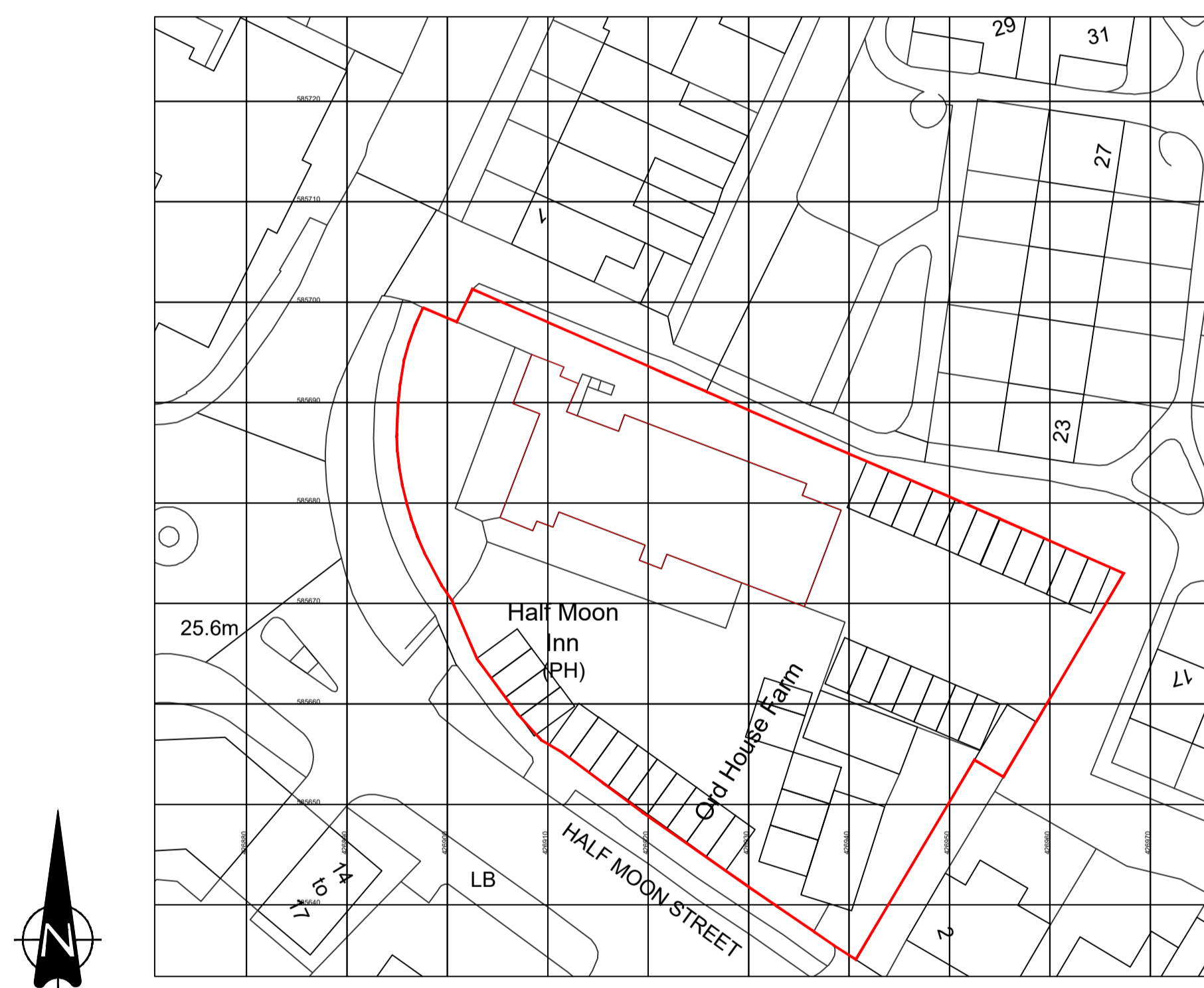

EXISTING BLOCK PLAN
SCALE - 1:500

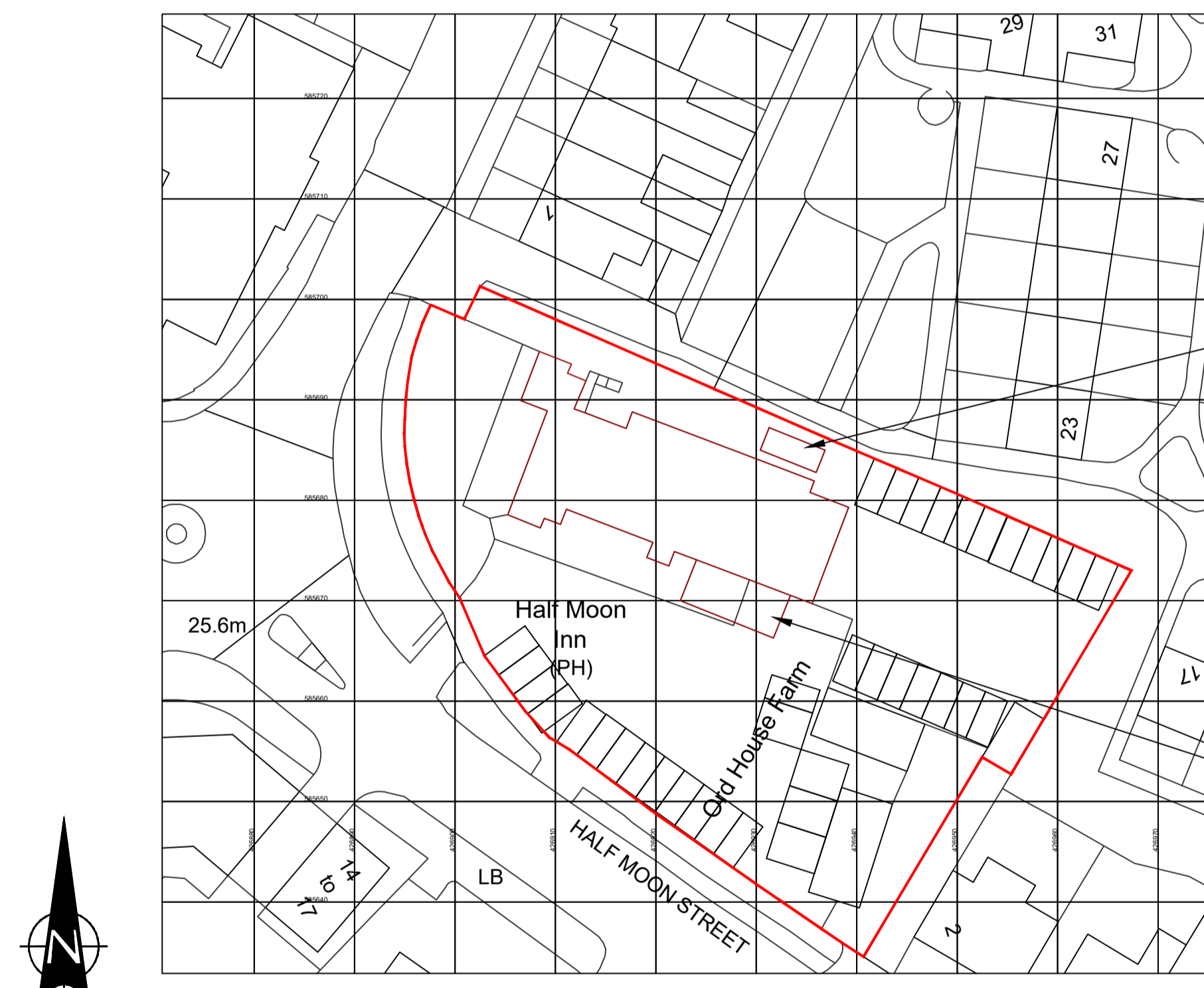

PROPOSED BLOCK PLAN
SCALE - 1:500

Proposed rear kitchen container
(Area: 14.3 m²)

Proposed front terrace extension
(Area: 43 m²)

CDM 2015:
Under the CDM regulations there are no significant design risks.

JS DESIGN
PARTNERSHIP LLP

T: 01274 53022
E: info@jsdesignpartnership.co.uk
Unit 5, Peel House, 2 Taunton Street, Shipley Bradford, BD18 3NA.
jsdesignpartnership is a limited liability partnership registered no 00382211

Client:
STAR PUBS & BARS

Project:
**THE HALF MOON INN
STAKEFORD
CHOPPINGTON
NE62 5TT**

Title:
EXISTING & PROPOSED BLOCK PLAN

Drawing No:	Rev:	Date:	Drawn By:	Checked:	Scale @ A1
9021-05	A	05.09.22	HM	SA	1:500