



KEY

-  Existing walls
-  New walls

NOTES

- Plan section cut at 1200mm above current floor level in loft
- Existing roof trusses to be removed and structural solution to loft renovation to be resolved by structural engineer
- Building to be assessed by a structural engineer before any construction work begins.

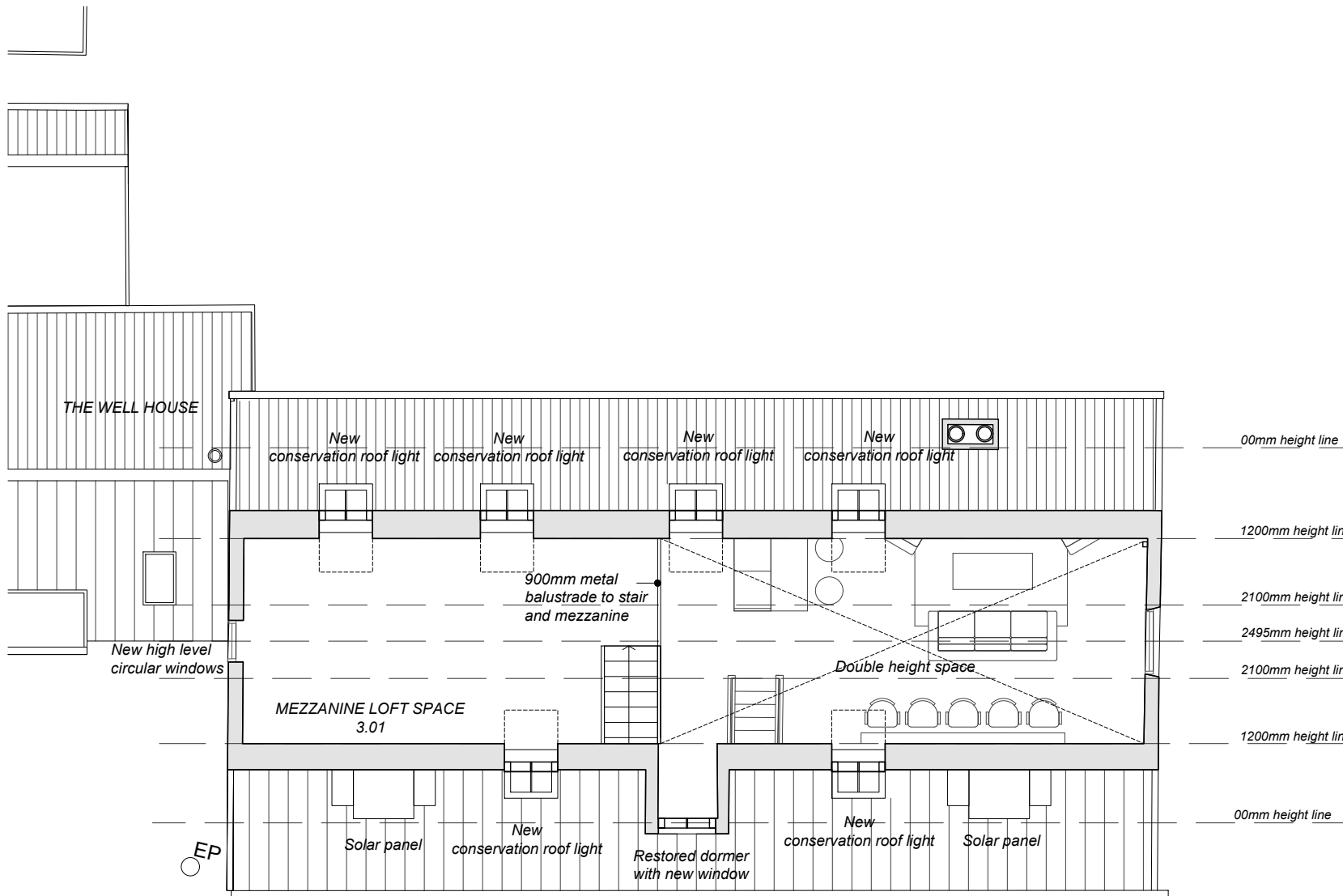

NEW LOFT PLAN
PROPOSED CONDITIONS

1:100
@A4



Drawing: New loft plan
Scale: 1:100 @ A4

Project: The Maltings
Client: Coonar-Hughes
Stage: Planning Application

Drawn by: SD
Checked by: SD
Issue date: 13.10.2022

Notes:
This drawing is copyrighted.
Drawing not to be used for construction
All dimensions to be checked on site
Drawings based on survey ASC.21.084A

DOWLEY
SAM@DOWLEYCOARC.COM
+44 7846 382 005

Dwg: 1.06
Rev: 04