



**KEY**

-  Existing walls
-  New walls

**NOTES**

- Plan section cut at 1200mm above current floor level in loft
- Existing roof trusses to be removed and structural solution to loft renovation to be resolved by structural engineer
- Building to be assessed by a structural engineer before any construction work begins.

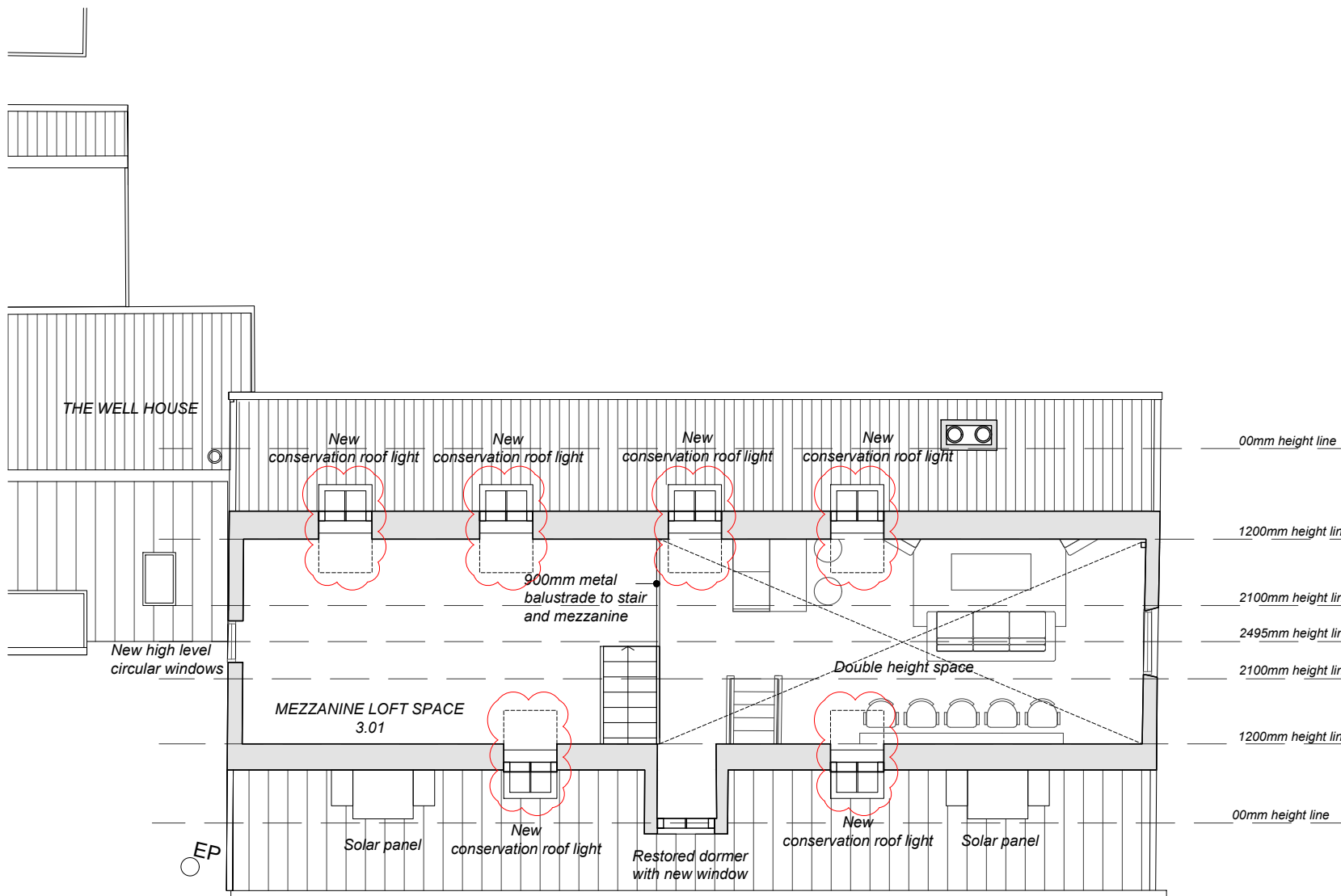

**NEW LOFT PLAN**  
PROPOSED CONDITIONS

**1:100**  
@A4

Drawing: New loft plan  
Scale: 1:100 @ A4

Project: The Maltings  
Client: Coonar-Hughes  
Stage: Planning Application

Drawn by: SD  
Checked by: SD  
Issue date: 09.27.2022

Notes:  
This drawing is copyrighted.  
Drawing not to be used for construction  
All dimensions to be checked on site  
Drawings based on survey ASC.21.084A

**DOWLEY**  
SAM@DOWLEYCOARC.COM  
+44 7846 382 005

**Dwg: 1.06**  
**Rev: 03**