

Existing Site Plan (scale 1:250)

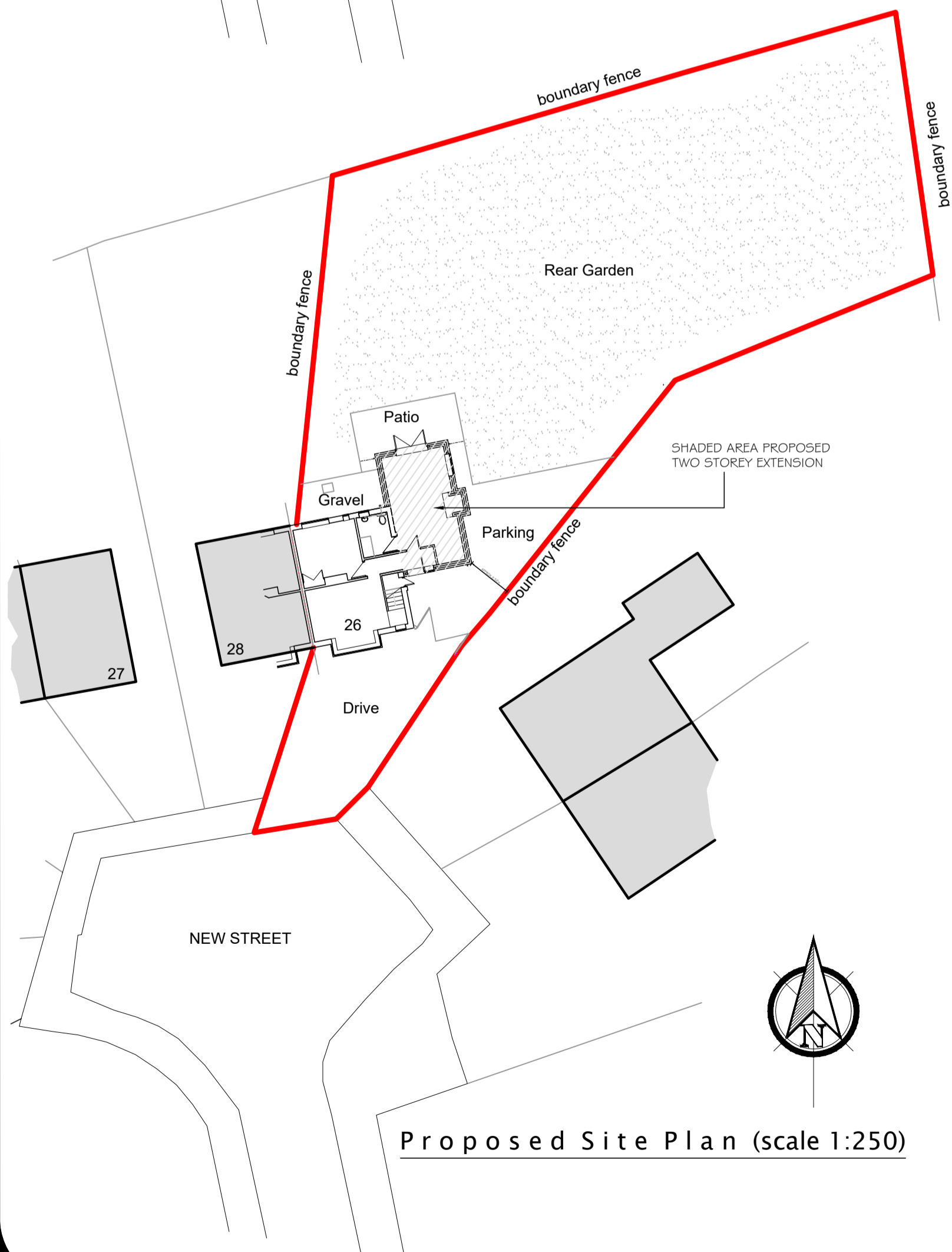

Existing Visuals (n.t.s)



Proposed Site Plan (scale 1:250)



Proposed Visuals (n.t.s)

Revision	Amendment	Date

Client:

Project:
Proposed Extensions and Alterations
26 New Street
Osbourne
Lincolnshire

Dwg Title:
Existing and Proposed Site plan and Visuals

Dwg No. 222990-04

Scale: 1:250
Date: 09/22

Rick Smith Design
Architectural Design Consultancy

Ardent House, 18 Eastgate
Sleaford, Lincolnshire NG34 7DP
Tel: 01529 414363 or 07786 838788
e-mail: rick@ricksmithdesign.com