

Notes

- The copyright of this drawing is the property of Ian H Bix Associates Ltd and must not be copied without their consent.
- Measurements to be checked on site by the Contractors prior to commencement of works and any discrepancies brought to the attention of the Designer.

Public sewer, position based on Anglian Water map.

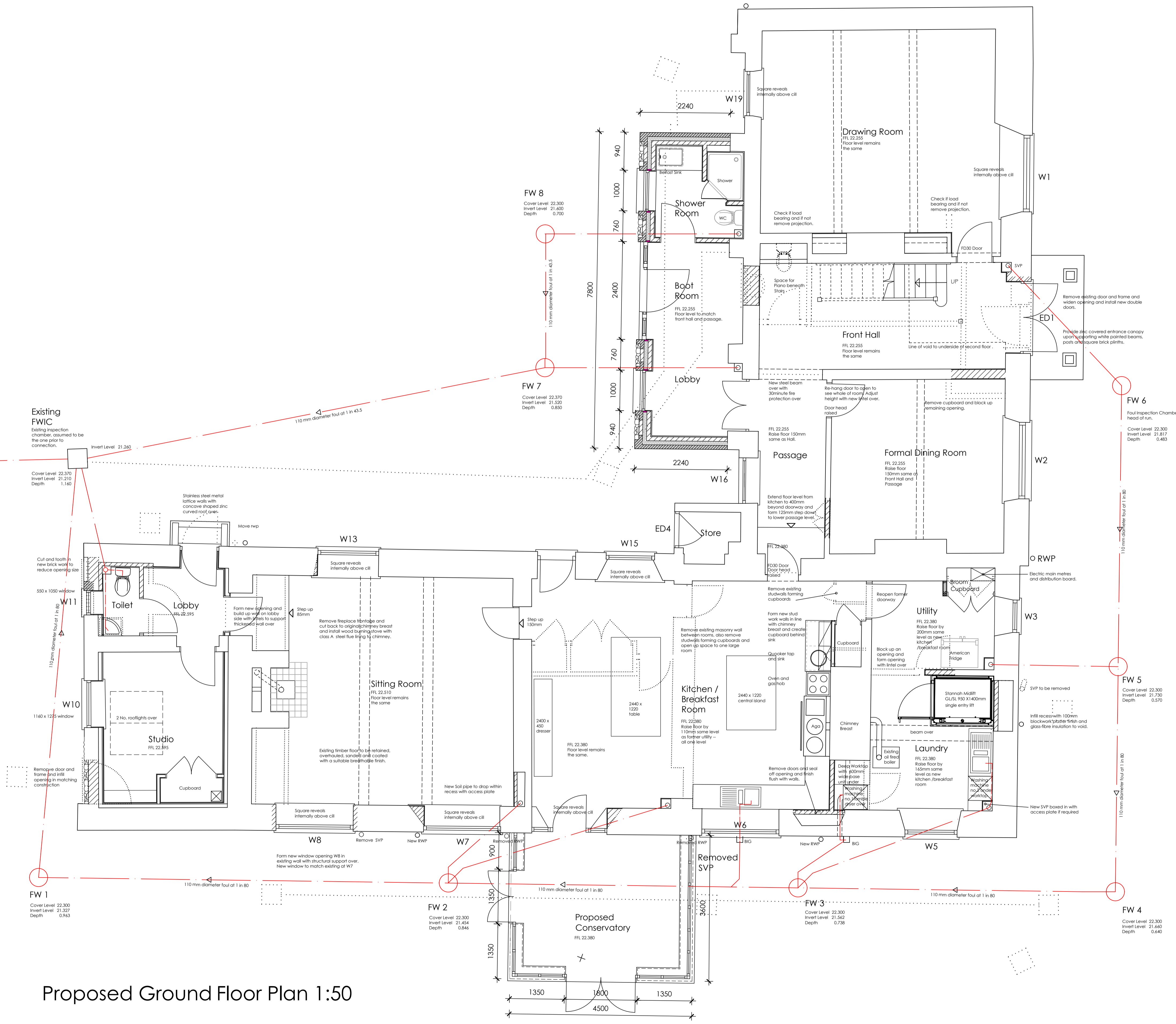

Revisions	
A	26/09/22 Above ground and below ground foul drainage proposals added. Garden Room changed to Conservatory with amended room sizes. Stairs amended. Fireplaces added with wood burning stove and flues.
B	16/09/22 Amendments made as requested by client. Lift door swing handed. Utility and Laundry made open plan with two washing machines in later, doors re-sited, sinks and shelves added. Reveals to windows squared off. Kitchen area amended to show island, sink, re-sited table. Fridge Freezer & dresser added. Boot-Room windows and doors amended & roof lights removed. End room to north renamed Drawing Room.
C	10/10/22 American fridge added and opening to Laundry Room increased. Door to Utility repositioned. Quooker tap and sink added and oven position moved next to aga. Gun cupboard and safe moved into Study. Step from Kitchen to Passage increased. Where both sides of existing windows are angled, revert back to angles. Levels amended.
D	24/10/22 Quooker tap and cupboards moved in line with aga and oven. Large cupboard created behind.
E	03/11/22 Shower Room amended.

IAN · H · BIX
Associates Ltd
M · C · I · A · T
ARCHITECTURAL AND
BUILDING CONSULTANTS
SANDPIPER HOUSE, LEETE WAY, WEST WINCH
KING'S LYNN, NORFOLK PE33 0ST
TEL: 01553 844077 FAX: 01553 844078
EMAIL: mail@ianhbx.co.uk WEB: www.ianhbx.co.uk

Project
**Proposed Extension
Manor House
Burnham Road
South Creake**

Drawing Title
Proposed Ground Floor Plan

Scale 1:50 @ A1
Date July 2022
Drawn IHB

Drawing No.
2486-12E

Proposed Ground Floor Plan 1:50