

450 x600 white control box fixed to rear of wall

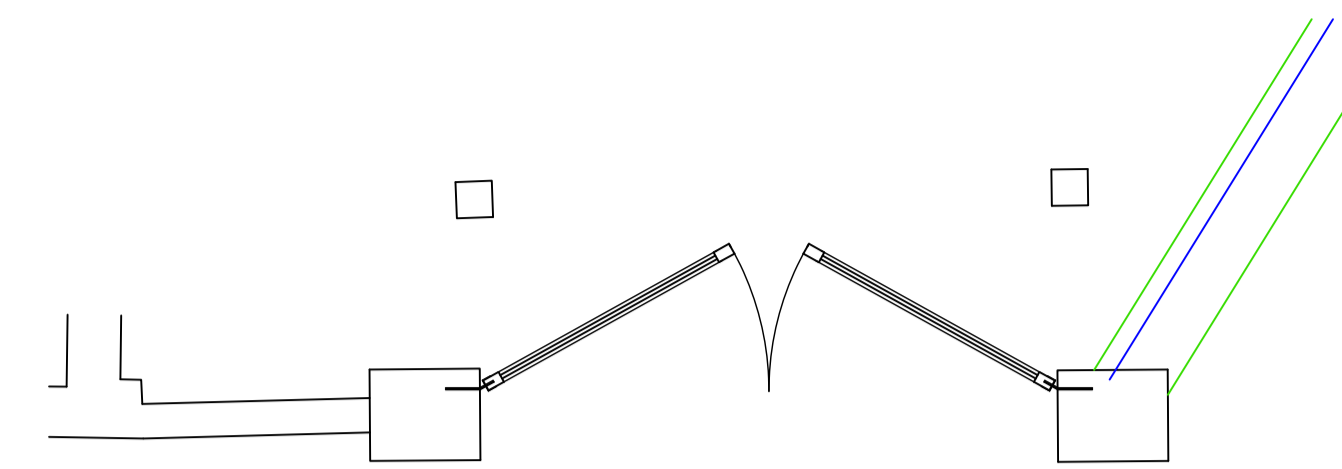
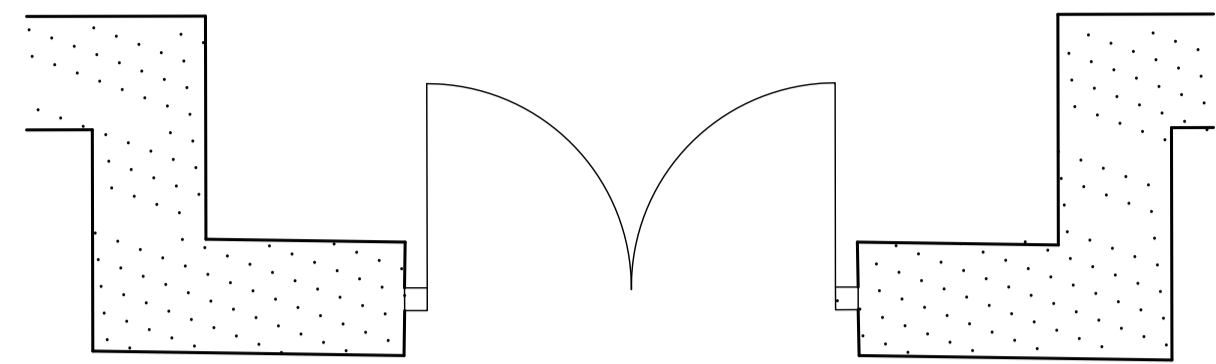
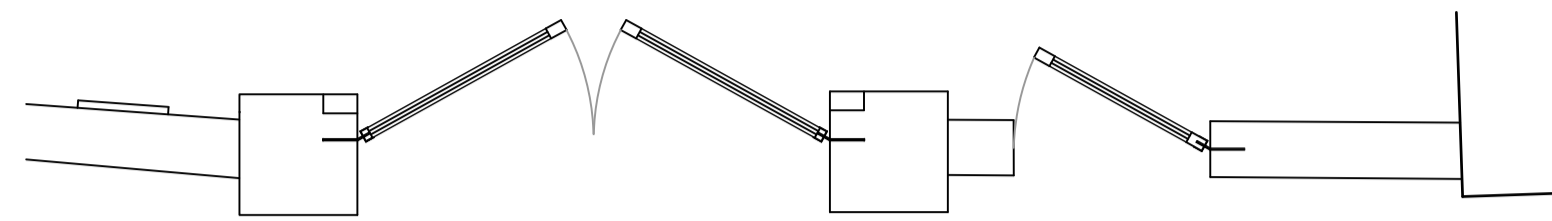

Notes

1. The copyright of this drawing is the property of Ian H Bix Associates Ltd and must not be copied without their consent.
2. Measurements to be checked on site by the Contractors prior to commencement of works and any discrepancies brought to the attention of the Designer.

Repair and re-point existing brick piers each side

Black painted wrought iron gates, double to main entrance and single to pedestrian entrance

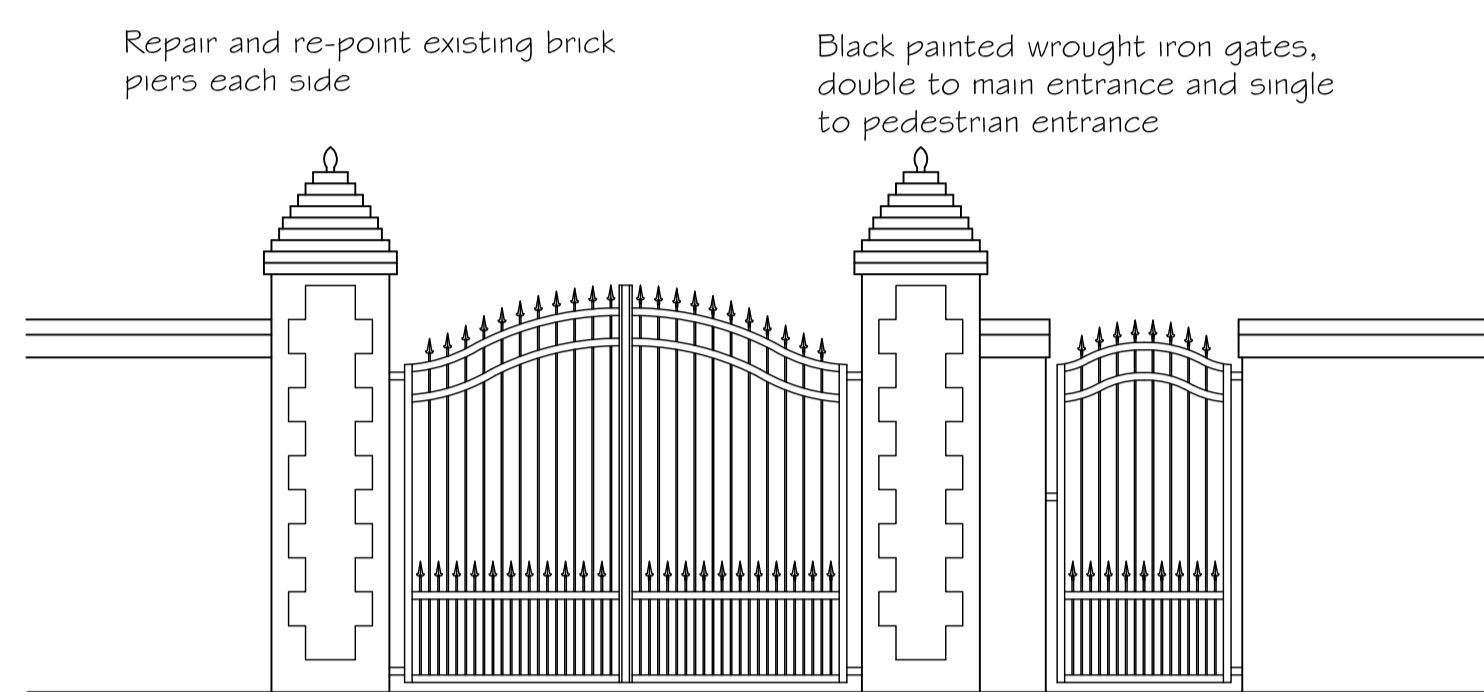

Main Entrance to be electronically operated to open and shut automatically.

Proposed Opening Gates 1:50
(Entrance to Parking & Turning Area at Front Of House)

North View from Access Drive

Timber boarded opening gates between hedges to garden area.

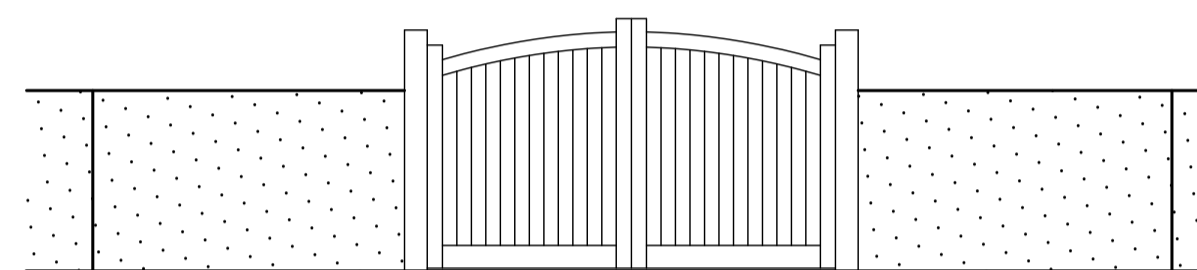

Proposed Gates & Hedge 1:50
(From House Parking & Turning Area to Rear Garden)

South View from Garden

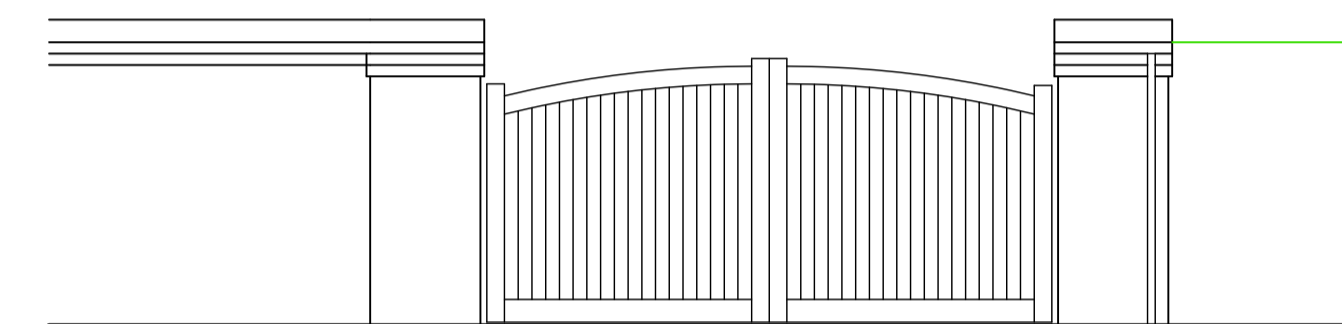

Proposed Automatic Opening Gates 1:50
(To Exit from rear of House through Wall Between Party and The Old Stables)

North view from Right Of Way

Revisions		
A	24.10.22	Notes added to proposals.

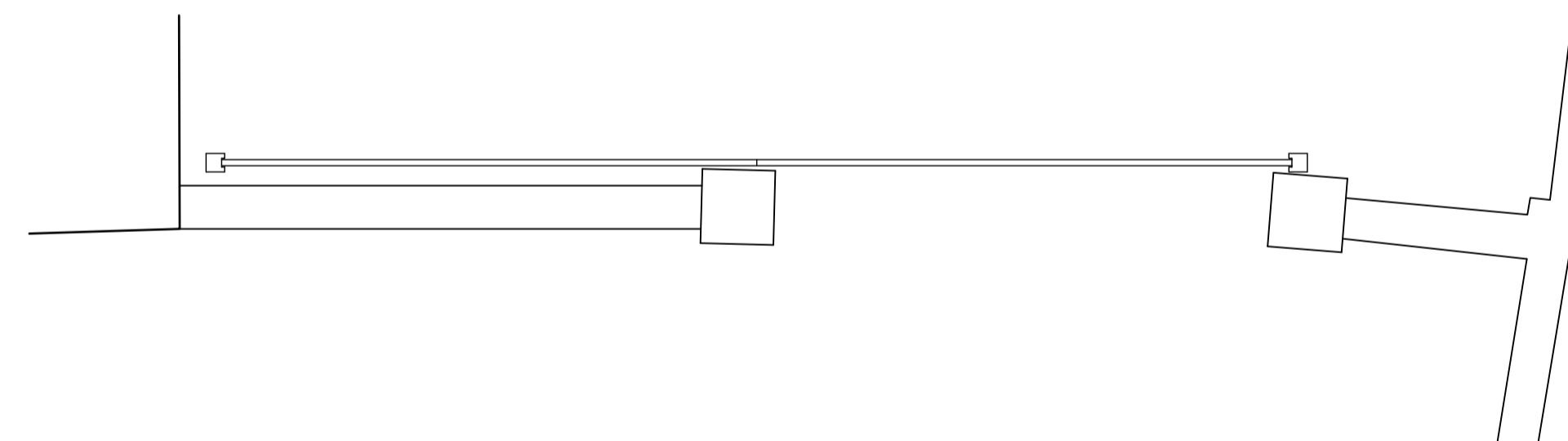
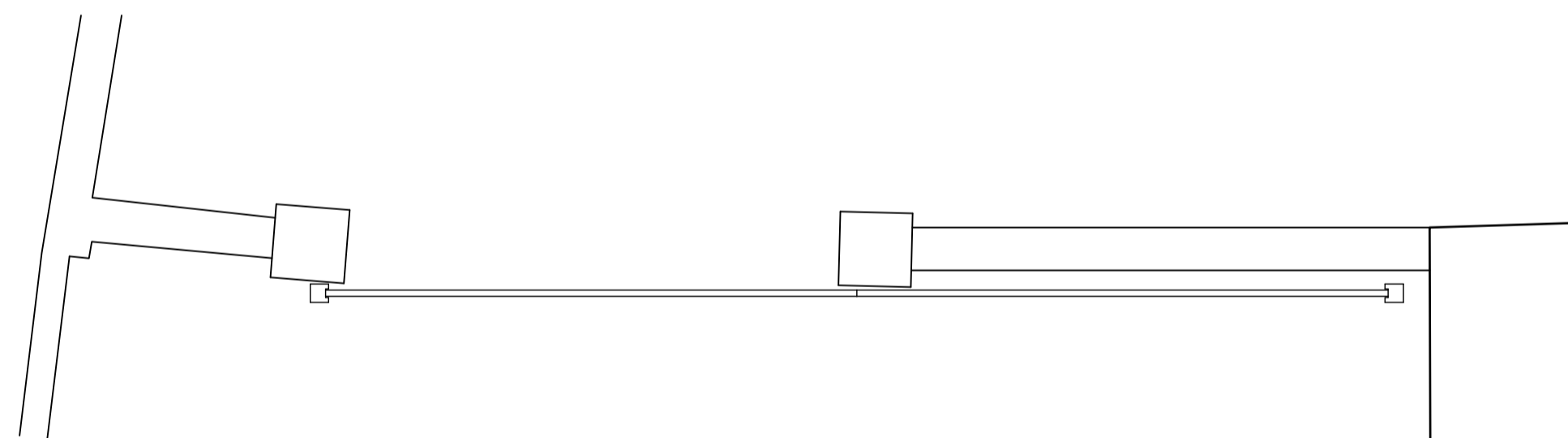

450 x600 white control box fixed to rear of wall

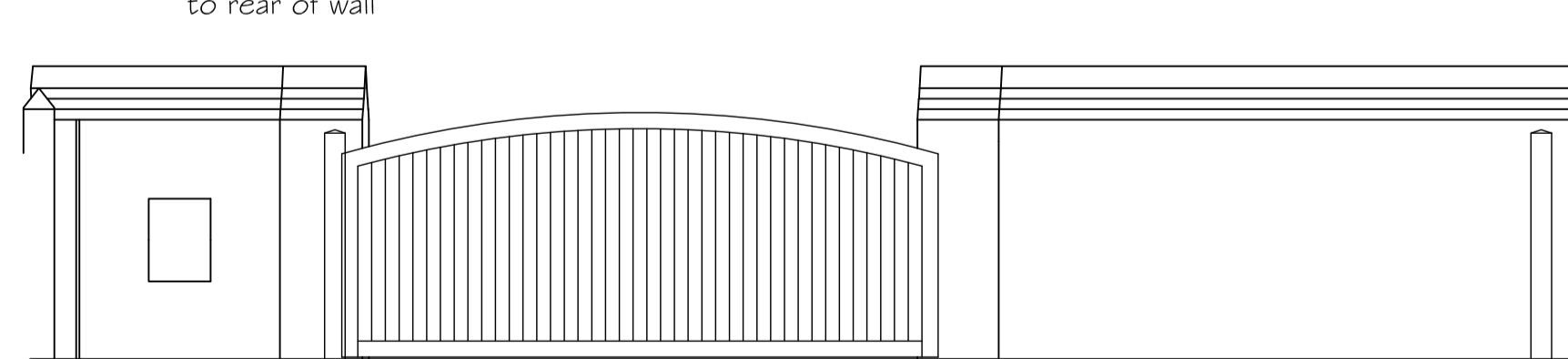

Timber boarded sliding gate operated electronically to open automatically.

Proposed Automatic Sliding Gate 1:50
(Gate between Access drive and Rear of House)

West View from Rear of House

Timber boarded sliding gate operated electronically to open automatically.

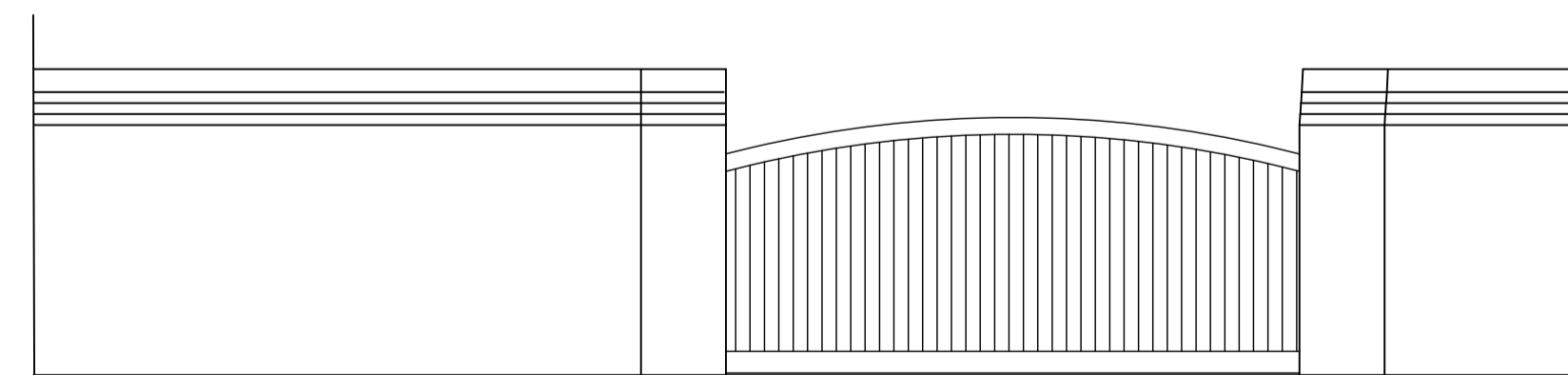

Proposed Automatic Sliding Gate 1:50

East View from Access Drive

IAN · H · BIX
Associates Ltd
M · C · F · A · T
ARCHITECTURAL AND
BUILDING CONSULTANTS
SANDPIPER HOUSE, LEETE WAY, WEST WINCH
KING'S LYNN, NORFOLK PE33 0ST
TEL: 01553 844077 FAX: 01553 844078
EMAIL: mail@ianbix.co.uk WEB: www.ianbix.co.uk

Project
**Proposed Extension
Manor House
Burnham Road
South Creake**

Drawing Title
**Plans and Elevations
of Gates as Proposed**

Scale 1:50 @ A1
Date July 2022
Drawn IHB / JAF

Drawing No. **2486-11A**