

GENERAL DRAWING NOTES

© This drawing is not to be shown to any Third Party unless agreed by The Design Social.

This drawing shows 'design intent' only. It is the responsibility of the appointed contractor to finalise development, using specialists approved by The Design Social, & produce detailed working drawings.

ALL working drawings to be approved by The Design Social prior to manufacture.

**Proposed GF Notes**

- Property perimeter outlined in red.
- Access road to Burton Old Road.
- Existing garage to be converted into habitable study room.
- New window to replace existing garage door.
- Proposed two storey extension to front of property. Extension to be of insulated cavity brick & block construction.
- New double garage door.
- New external door into proposed garage.
- New enlarged window into sitting room.
- Wall at removed bay window to be made good, with insulated cavity construction.
- Proposed single storey extension to rear of property. Extension to be of insulated cavity brick & block construction.
- New sliding folding doors, to rear of proposed extension.
- New internal door into proposed study room.
- New structural opening to enlarge dining room, kitchen & lounge into one open plan space.
- Existing kitchen entrance to be walled up & new stud walls constructed to form proposed pantry.

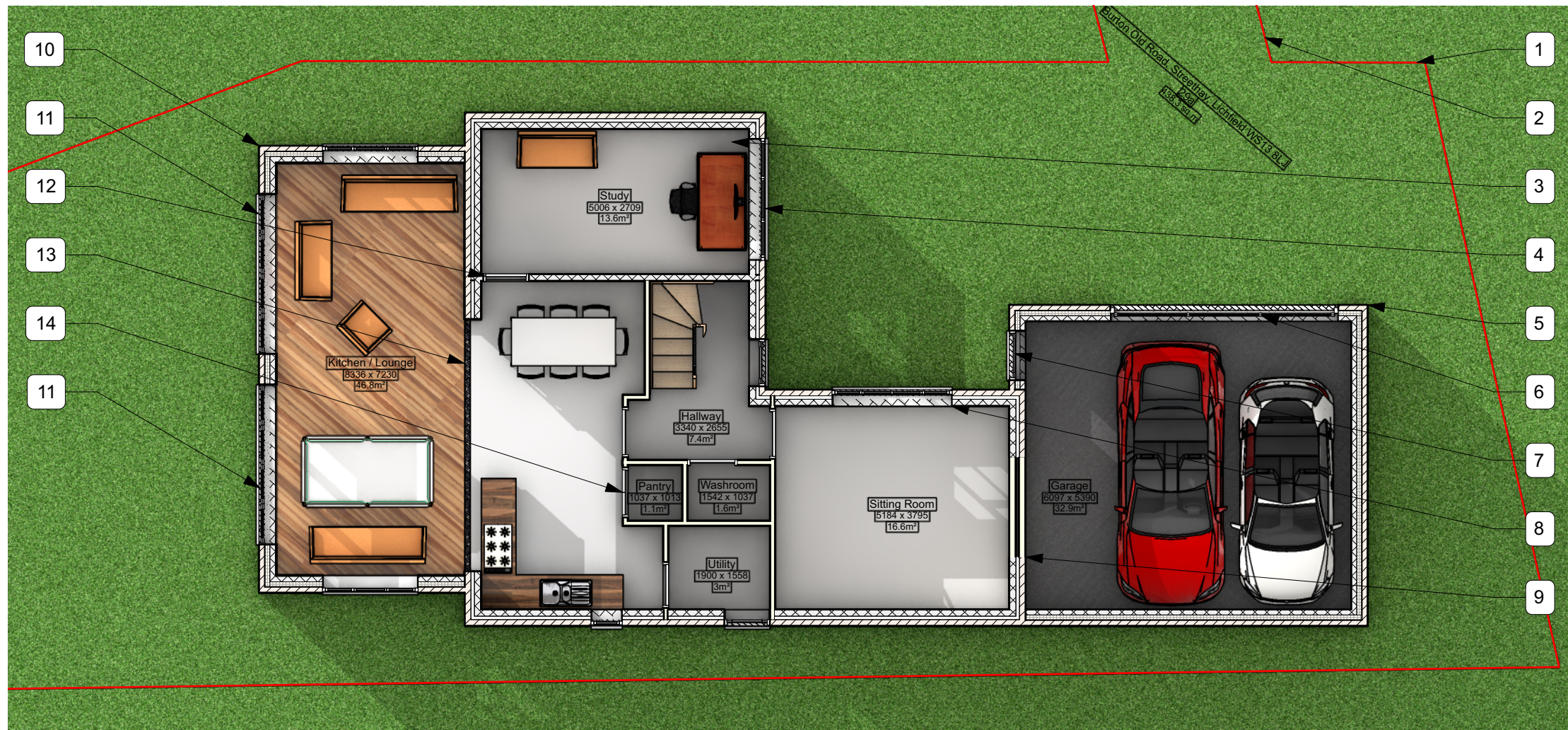

1 Ground Floor - Proposed  
 Scale: 1:100

REV.	DATE	NOTES	REV. BY

Daniel Amarteifio				
29A Burton Old Road, Streethay, Lichfield WS13 8LJ				
Proposed Ground Floor Plan				
AUTHOR	B.R.	DATE	26/10/2022	APPROVED
				D.A.
SCALE	AS NOTED @ A3		READ WITH	0248 (A) GA 001
DRAWING No.	0248	(A)	GA	007
Project No.	Type	Area	Number	Rev
DRAWING STATUS: For Approval				