

Drawn By: RB	Project start date:
Checked By: JMF	Date: JUNE 2022
Drawing Scales: 1:200 @ A1	
Drawing Status: PLANNING	

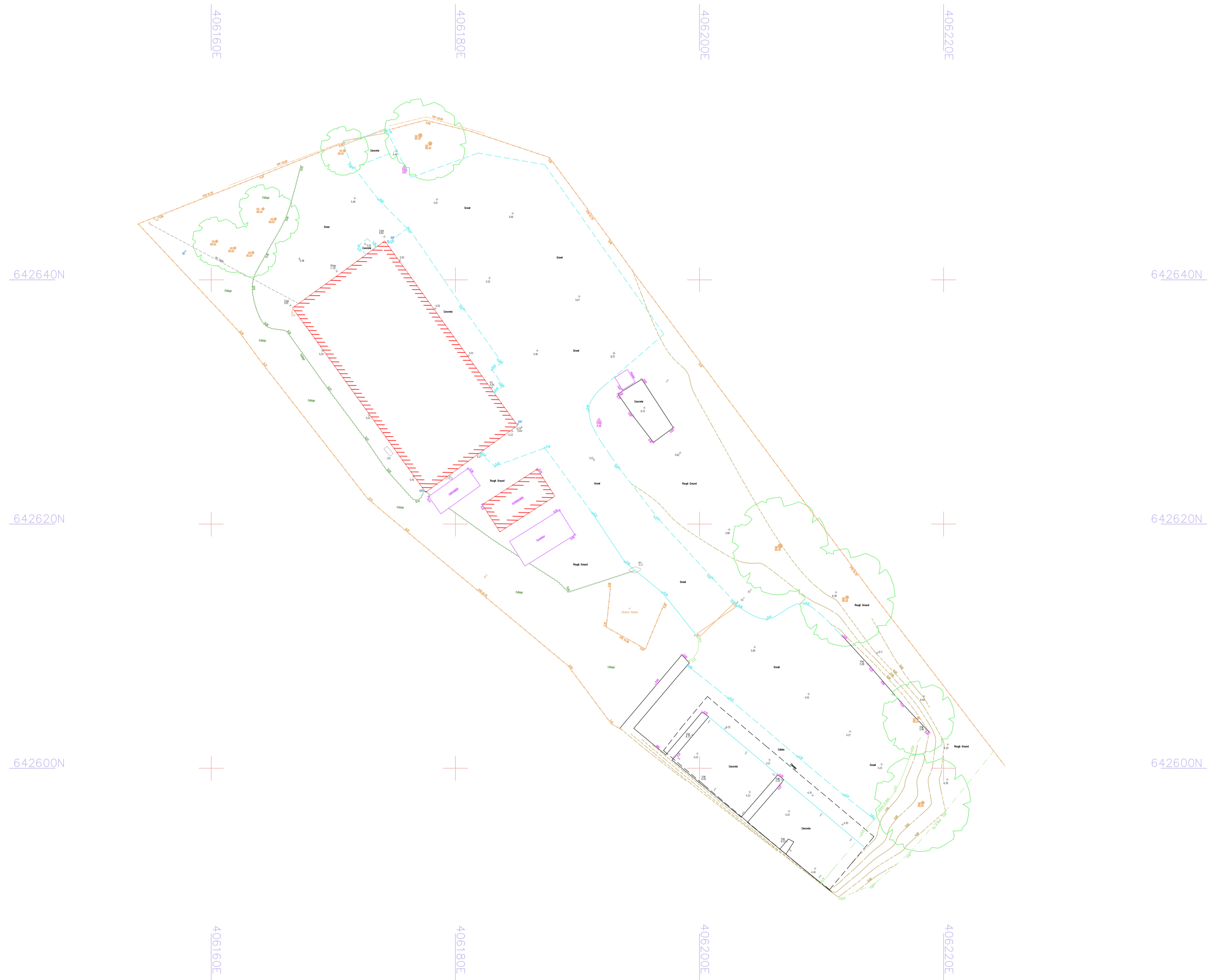

Project Description:	
Project Address: Lindisfame National Nature Reserve Berwick-upon-Tweed	
Client: -	
firth	Firth Associates Limited Old Bank Studio 43 Woodlands Road Lytham Saint Annes FY8 1DA T (01253) 734036 E info@firtharchitects.com www.firtharchitects.com
RIBA 	arb  <small>Architects Registration Board</small>
Drawing Title: Existing Topographical Survey	
Drawing Number: 7185 - 01	Revision -

