

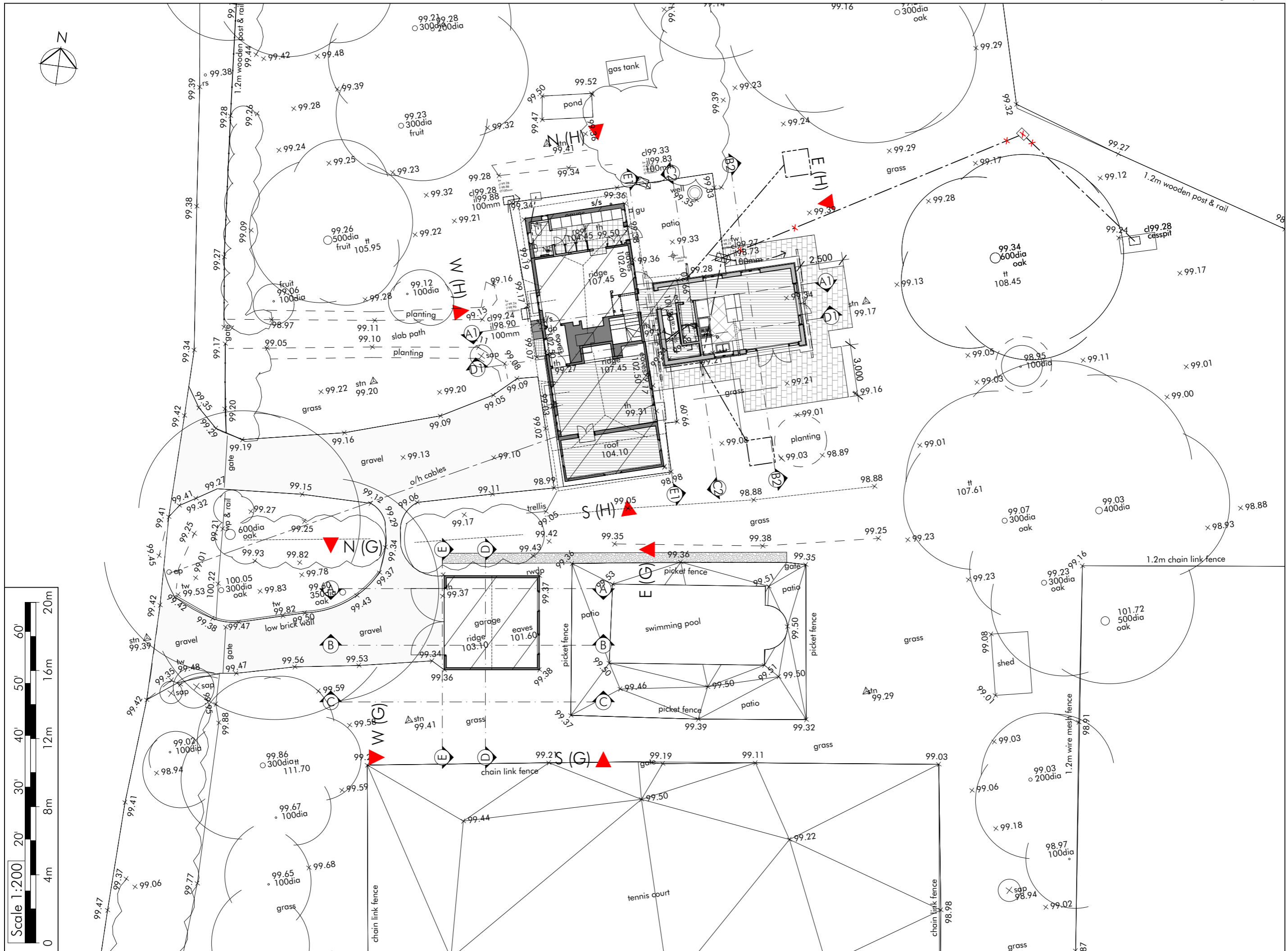

Do not scale from this drawing - All dimensions are to be checked on site and any discrepancies are to be reported to the architect before construction commences. If in doubt ask. © This design remains the property of Brook Morton Architecture and may not be copied without written authorisation.



Existing Site Plan

1:200

 <b>BR O O R T O N</b> A R C H I T E C T U R E	Client 29 b Stoney Lane Winchester SO22 6DP M : 07881 911806 nicholas@brookmorton.com www.brookmorton.com	Project Alistair Wood Oak Cottage, Ecchinswell, Newbury RG20 4UA	Initial issue 15th November 2022
	Scales 1:200 at A3	Drawing No. BMA331/PL02A	SK/PL/BR/CON