

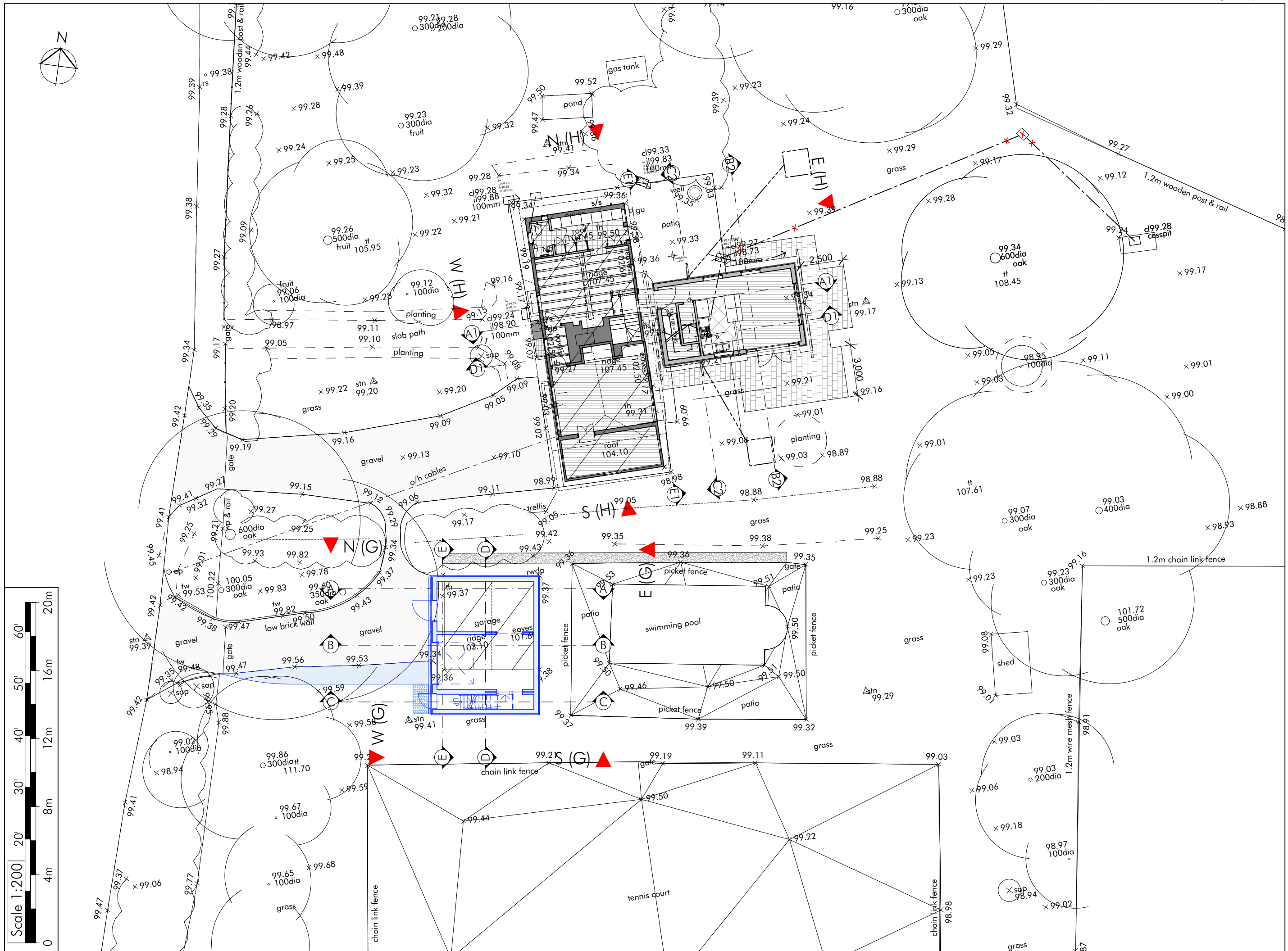

Do not scale from this drawing - All dimensions are to be checked on site and any discrepancies are to be reported to the architect before construction commences. If in doubt ask. © This design remains the property of Brook Morton Architecture and may not be copied without written authorisation.



Proposed Site Plan

1:200

 BR O O R T O N A R C H I T E C T U R E	Client 29 b Stoney Lane Winchester SO22 6DP M : 07881 911806 nicholas@brookmorton.com www.brookmorton.com	Project Alistair Wood Oak Cottage, Ecchinswell, Newbury RG20 4UA	Initial issue 15th November 2022
	Proposed site layout	Scales 1:200 at A3	Drawing No. BMA331/PL06A