



Plate 11: View of Field 2 and its southwestern boundary, from the southeast



Plate 12: View of Field 2 and its southwestern boundary, from the northwest



Plate 13: View of Field 2 and its northwestern boundary, from the northeast



Plate 14: View of the boundary between Field 3 and Field 1, from the southeast



Plate 15: View of the boundary between Field 3 and Field 4, from the southeast



Plate 16: View of Field 3 and its northwestern boundary, from the northeast



Plate 17: View of Field 4 and its southeastern boundary, from the southwest



Plate 18: View of the overgrown trackway to the southeast of Field 4, from the west



Plate 19: View of Field 4 and its northeastern boundary, from the northwest



Plate 20: View of Field 4 and its northwestern boundary, from the northeast



Plate 21: View across Field 4, and the slightly raised area, from the northwest



Plate 22: View of Field 5 and its northwestern boundary, from the southwest



Plate 23: View of Field 5 and its northeastern boundary, from the southeast



Plate 24: View of Field 5 and its northeastern boundary, from the northwest



Plate 25: View of Field 5 and its northeastern boundary, from the southeast



Plate 26: View of Field 5 and its southeastern boundary, from the southwest



Plate 27: View of the boundary between Field 5 and Field 6, from the southeast



Plate 28: View of the boundary between Field 5 and Field 6, from the northwest



Plate 29: View of Field 5 and its southwestern boundary, from the southeast



Plate 30: View of Field 6 and its northwestern boundary, from the east



Plate 31: View of Field 6 and its northwestern boundary, from the south



Plate 32: View of Field 6 and its southwestern boundary, from the northwest



Plate 33: View of Field 6 and its southeastern boundary, from the southwest



Plate 34: View of the Grade I Listed Church of All Saints (Asset 5), from the east



Plate 35: View of the Grade II Listed Walsoken Parish War Memorial (Asset 12), from the southeast



Plate 36: View towards the Site from the churchyard of All Saints Church (Asset 5), from the west



Plate 37: View towards the A47 from the northwestern boundary of the Site, from the east



Plate 38: View towards the Site from near to the Grade II Listed Mill House (Asset 1), from the northeast



Plate 39: View of the Grade II Listed Marshland Smeeth and Fen War Memorial (Asset 2), from the north



Plate 40: View towards the Site from near to the Grade II Listed Marshland Smeeth and Fen War Memorial (Asset 2), from the southeast



Plate 41: View towards the Site from near to the Grade II Listed Old Post Office (Asset 7), from the northwest



Plate 42: View towards the Site from near to the Grade II Listed Trinity House (Asset 8), from the northeast



Plate 43: View towards the Site from near to the Grade II Banyer Hall (Asset 9), from the southwest



Plate 44: View towards the Site from near to the Grade II Listed Austin House (Asset 10), from the west

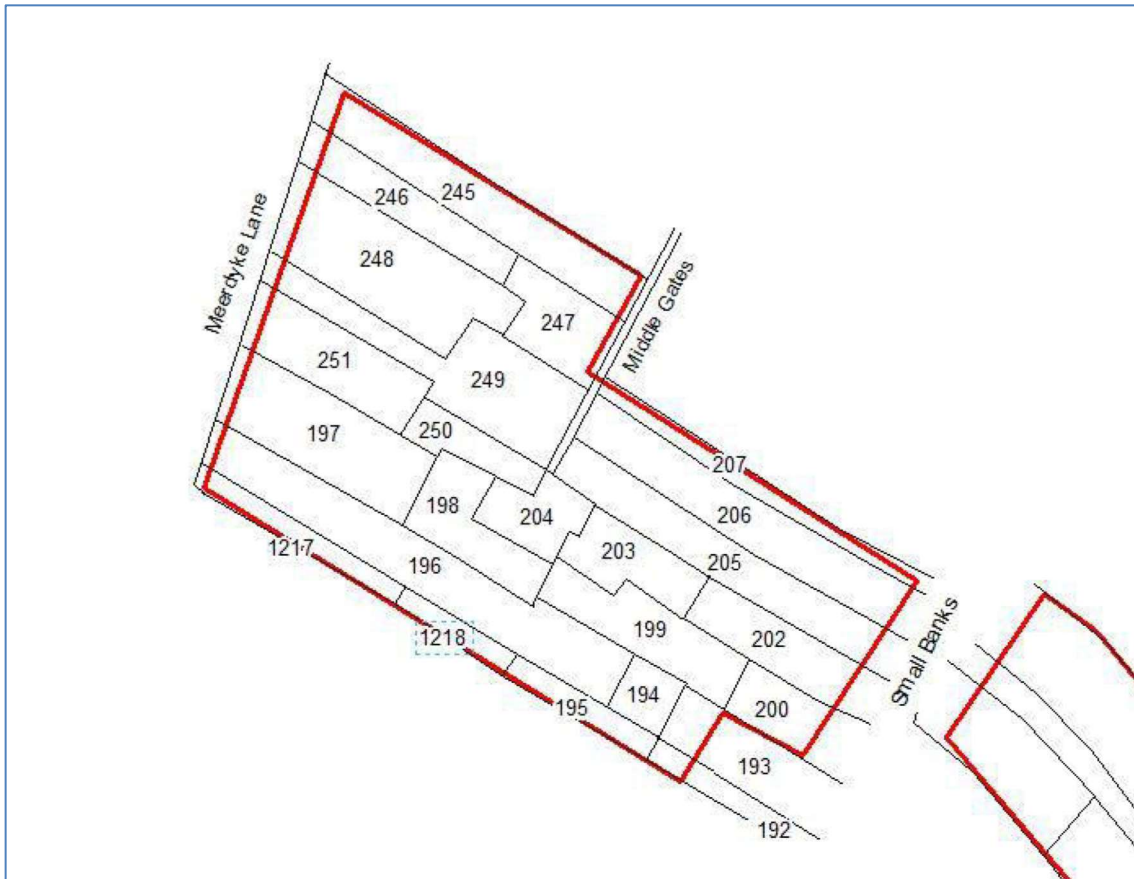

Plate 45: Sketch drawing of the tithe map field plots in the western part of the Site

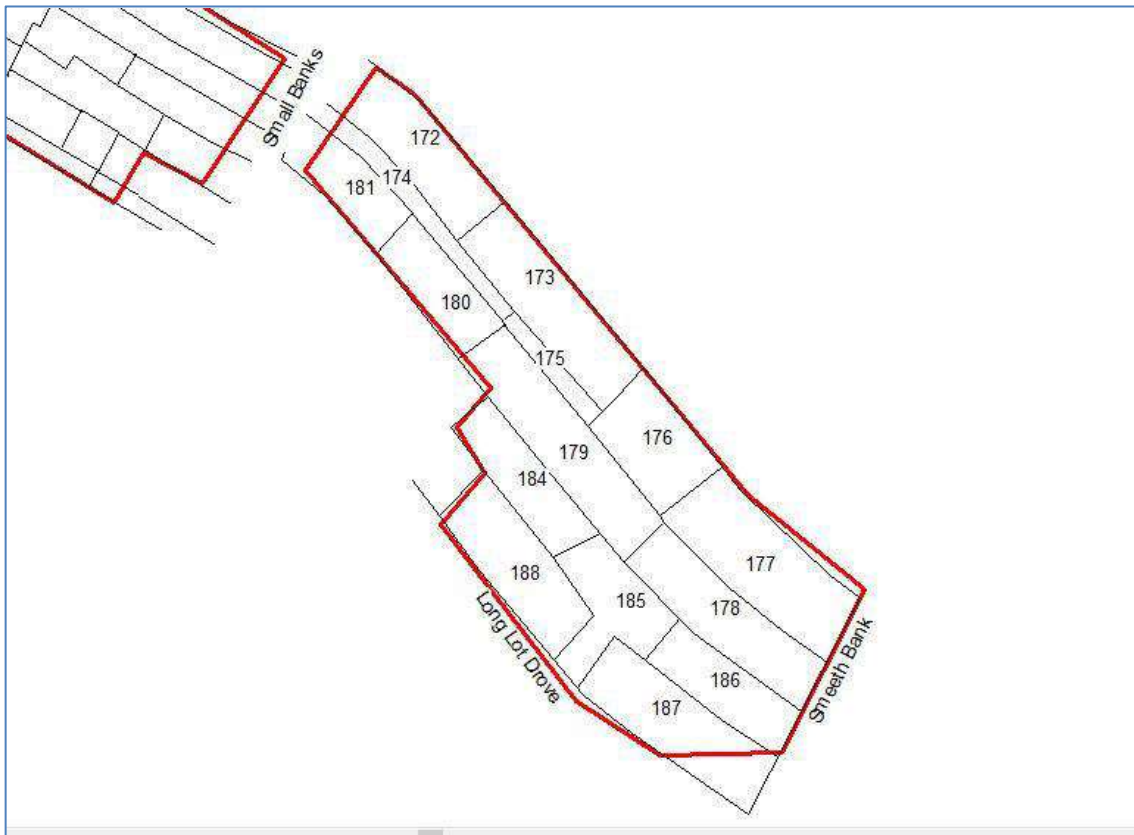

Plate 46: Sketch drawing of the tithe map field plots in the eastern part of the Site



Appendix 1: Asset Gazetteer

Asset Number	1
Asset Name	Mill House, Fen Road
Type of Asset	Listed Building
Listing No./NRHE Number	1305435
HER Number	
Status	Listed Building: Grade II
Easting	550264
Northing	311790
Parish	West Walton
Council	Norfolk
Description	<p>WEST WALTON FEN ROAD TF 51 SW 3/69 Mill House II Tower Mill, converted to house. Mid C18 of 3 storeys, reduced to 2 in 1815 and a further 2 storeys added. Brick. Circular with pronounced batter at third floor. Late C20 bungalow abuts to south. C20 casements to cardinal points on each floor. Saw toothed cornice below C20 crenellated parapet. Tie plates above upper windows in form of letters and numerals : JD 1815 (John Dobbs).</p> <p>Listing NGR: TF5026411790</p>

Asset Number	2
Asset Name	Marshland Smeeth and Fen War Memorial
Type of Asset	Listed Building
Listing No./NRHE Number	1444678
HER Number	
Status	Listed Building: Grade II
Easting	552033
Northing	309329
Parish	Marshland St. James
Council	Norfolk
Description	<p>Summary</p> <p>First World War memorial, with later additions for the Second World War. Erected in the 1920s. Architect unknown.</p> <p>Reasons for Designation</p> <p>Marshland Smeeth and Fen War Memorial, which stands at the entrance to Marshland St James cemetery, is listed at Grade II for the following principal reasons: * Historic interest: as an eloquent witness to the tragic impact of world events on this local community, and the sacrifice it has made in the conflicts of the C20; * Design: a simple Latin cross on a tapering four-sided plinth.</p> <p>History</p> <p>The aftermath of the First World War saw the biggest single wave of public commemoration ever with tens of thousands of memorials erected across England. This was the result of both the huge impact on communities of the loss of three quarters of a million British lives, and also the official policy of not repatriating the dead which meant that the memorials provided the main focus of the grief felt at this great loss. One such memorial was raised at Marshland St James in the 1920s as a permanent testament to the sacrifice made by the members of the</p>

Marshland Smeeth and Fen area who lost their lives in the First World War.

Details

First World War memorial, with later additions for the Second World War. Erected in the 1920s. Architect unknown.

MATERIALS: Carved from grey granite.

DESCRIPTION: Marshland Smeeth and Fen War Memorial is prominently situated at the entrance to the cemetery in Marshland St James and facing the road. It comprises a polished grey granite Latin cross on a tapering four-sided plinth with granite foot, and four-stepped concrete base below. This is bounded by concrete posts connected by chains. The plinth bears the inscriptions in incised and painted lettering.

The inscription on the western face reads ERECTED BY THE / INHABITANTS OF / MARSHLAND SMEETH & FEN / IN GRATEFUL MEMORY / OF THEIR FRIENDS WHO LAID DOWN / THEIR LIVES IN THE GREAT WAR / 1914-1918 / (NAMES) // ETERNAL REST GRANT THEM O LORD / AND MAY LIGHT PERPETUAL SHINE UPON THEM / LEST WE FORGET. The northern face is inscribed ALSO / IN MEMORY OF THE / MEN OF / MARSHLAND ST JAMES / (NAMES) / WHO LAID DOWN THEIR LIVES / IN THE WORLD WAR / 1939 – 1945

This List entry has been amended to add sources for War Memorials Online and the War Memorials Register. These sources were not used in the compilation of this List entry but are added here as a guide for further reading, 23 November 2017.

Sources

Websites

Information on war memorials from the Roll of Honour database, accessed 2 February 2017 from <http://www.roll-of-honour.com/Norfolk/MarshlandSmeethMemorial.html>

War Memorials Online, accessed 23 November 2017 from <https://www.warmemorialsonline.org.uk/memorial/253708>

War Memorials Register, accessed 6 June 2017 from <http://www.iwm.org.uk/memorials/item/memorial/40404>

Asset Number	3
Asset Name	CROSS BASE 3 METRES SOUTH OF CHURCH OF ALL SAINTS
Type of Asset	Listed Building
Listing No./NRHE Number	1077673
HER Number	
Status	Listed Building: Grade II
Easting	547721
Northing	310528
Parish	Walsoken
Council	Norfolk
Description	WALSOKEN CHURCH ROAD TF 41 SE 2/65 Cross Base 3m South of Church of All Saints G.V. II Cross base. Medieval. Ashlar. Square plinth upon which stands truncated shaft of square section with chamfered corners. Listing NGR: TF4772110528

Asset Number	4
Asset Name	MEMORIAL 3 METRES SOUTH OF CHANCEL OF CHURCH OF ALL SAINTS
Type of Asset	Listed Building
Listing No./NRHE Number	1077674
HER Number	
Status	Listed Building: Grade II
Easting	547736
Northing	310532
Parish	Walsoken
Council	Norfolk
Description	<p>WALSOKEN CHURCH ROAD TF 41 SE 2/68 Memorial 3m South of Chancel of Church of All Saints G.V. II Headstone. 1738. Limestone. Rectangular with covered set-back top. Pair of Ionic columns support moulded entablature and frame bowed circular inscription panel. Below this a fielded predela panel. Above entablature a relief carving of reclining woman with long hair, draperies and a skull.</p> <p>Listing NGR: TF4773610532</p>

Asset Number	5
Asset Name	CHURCH OF ALL SAINTS
Type of Asset	Listed Building
Listing No./NRHE Number	1171765
HER Number	
Status	Listed Building: Grade I
Easting	547720
Northing	310544
Parish	Walsoken
Council	Norfolk
Description	<p>WALSOKEN CHURCH ROAD TF 41 SE 2/64 Church of All Saints 11.8.51 G.V. I Parish church. Nave and chancel late C12, west tower mid C13, aisles remodelled C14, further alterations C15. Rendered or cemented ashlar and lead roofs. 4 stage tower with polygonal clasping buttresses standing on low base course. First stage with arcade of blind pointed arches on columns with waterholding bases and moulded capitals, undercut arch mouldings. Round arched west door with complex and deeply undercut arch mouldings supported on 3 orders of shafts with stiff-leaf capitals, all much restored in C19. Second stage have trefoil-headed arcade. To west the centre 2 arches are pierced as windows, also one similar light to south. Third stage with polygonal shafts rising full height with pointed blind arched recesses between shafts. To north, south and west one pointed lancet illuminates ringing chamber. To east original nave roof line remains. Belfry and spire C14. 2-light ogeed belfry windows with hood mould. Crenellated parapet with polygonal angle turrets extending from clasping buttresses. Hexagonal spire with concave gabled lucarnes in one tier. 5-light south aisle west window with stepped lights beneath depressed 4-centred arch. Diagonal buttress at corner. Aisle windows to flank are 3 or 4-light square-headed with ogeed lights, restored or renewed C19. Priests door has 5 trefoiled lights over it, also with square hood; doorway of one order of shafts below wave moulded arch of c.1340. C14 gabled south porch with angle buttresses and stilted arch. North and south clerestory of 7 3-light C15 panel tracery windows below basket arches. To west of south clerestory one punched encircled quatrefoil in square surround. Crenellated parapet, that to north rebuilt in brick. Principal merlons of parapet carry crocketed finials. Bellcote over east</p>

nave gable with ogee opening. North nave aisle pierced by 4 3-light ogeed windows with depressed arches. To west of arched north doorway are 2 2-light reticulated windows. C13 corbel table beneath eaves reused when aisle constructed. C15 south chancel chapel in 3 bays. One 4-light and one 3-light window to western 2 bays. 2 storey eastern chapel added 1536 lit by 2 2-light cusped square-headed windows to ground floor sharing a common hood mould and one 3-light cusped square-headed window to upper floor. Eastern wall of this chapel pierced by similar windows with that to first floor elaborated into tracery head below depressed arch. Stepped buttresses flank 5-light C15 Perpendicular east chancel window. Paired shafts survive from early C13 to right and left, each with stiff-leaf capitals. Against east wall of north chancel chapel a C20 brick boiler house. 3 north windows of this chapel cusped under depressed arches. Interior. 7 bay arcade of late C12 with alternating circular and octagonal piers each with square abaci above scalloped capitals. Eastern responds have waterleaf capitals, now c.1200. Round arches carry zig-zag mouldings and have hood moulds. Pointed chancel arch with paired columns to west with 8 annulated rings. Capitals struggle for coherent identity between scalloped, waterleaf or crocket. Northern responds cut for insertion of late C15 4-centred rood stair doorway. Chancel arch with 3 orders of zigzag, billet and roll mouldings. Tower arch is fully C13 : pointed, on keeled columns with subsidiary keeled colonnettes to east and west, crocket capitals and deeply undercut arch. Tower windows shafted on interior. C15 nave roof. Hammerbeams on arched braces drop on wall posts to corbels. The wall posts have canopied niches containing painted figures of Kings and Prophets. Painted angels terminate hammerbeams. Cambered tie beams sit on hammerbeams and are moulded, as are one tier butt purlins and ridge piece. South aisle roof of principals on arched braces with wall posts dropping to corbels. Carved figures stand in canopied niches on wall posts. Rafters with roll moulded edges and 2 tiers moulded butt purlins. North aisle roof much altered. Plain tie beams supported on straight braces with wall posts. Purlin carried on 3 braces from each tie and C19 ladder bracing runs full length between purlin and tie beams. Over tower arch a carved timber representation of throned King Solomon, and to right and left wall paintings depict 2 women and child (Judgement of Solomon). Probably C17, as is carved timber figure of King David with harp over chancel arch. Fine octagonal 7 sacraments font dated 1544 on base. The sacraments are on bowl within cusped niches, the additional scene is the Crucifixion. On stem are figures of 8 saints. 8 C15 poppyhead bench ends in nave with figures in ogee niches. At east ends of aisles are arches leading to chancel chapels approached through parclose screens. C16 south screen of 2 bays right and left of 4-centred opening. Elaborate closely panelled tracery in head, each bay of which is subdivided. North parclose screen of 4 bays right and left of square central opening. Dado restored, ogeed tracery in heads of lights. Chancel. 2 bay arcade on central circular piers and octagonal responds. Eastern capitals are of waterleaf type, central piers carry scalloped capitals as does south-west respond. North-west respond with crocket capitals. Round arches with double order of zig-zag. 4 blocked clerestory windows each side, all round-headed, the eastern windows taller. Dado marked by billet moulding which rises over low round-headed door to north. In south wall a blocked C13 arch pierced by a blocked C14 stilted doorway. East window flanked by double annulated shafting with stiff-leaf capitals. Chancel roof of moulded butt purlins on moulded arched braces, otherwise all renewed. C19 parclose screens between chancel and north and south chapels. Extensively restored C16 choir stalls with heads as hand rests. Late C15 south chapel roof : alternating large and small moulded arched braces on wall posts support moulded principals. Larger principals decorated with carved ribbon trail and have figures against their wall posts. 2 tiers moulded and pierced butt purlins and ridge piece.

Listing NGR: TF4772010544

Asset Number	6
Asset Name	MEMORIAL TO JAMES AND SUSANNA GIBSON 10 METRES SOUTH OF NAVE OF CHURCH OF ALL
Type of Asset	Listed Building
Listing No./NRHE Number	1171816
HER Number	
Status	Listed Building: Grade II

Easting	547706
Northing	310524
Parish	Walsoken
Council	Norfolk
Description	<p>WALSOKEN CHURCH ROAD TF 41 SE 2/67 Memorial to James and Susanna Gibson IOM South of Nave of Church of All Saints G.V. II Headstone. 1767. Limestone. Rectangular with covered set-back top. Pair of Ionic capitals support moulded entablature and frame bowed oval inscription panel. In spandrels below inscription panel a carved hourglass, crossed bones and a skull. Above the panel 2 trumpets and crown in each spandrel. Below covered head a winged cherub.</p> <p>Listing NGR: TF4770610524</p>

Asset Number	7
Asset Name	OLD POST OFFICE
Type of Asset	Listed Building
Listing No./NRHE Number	1171829
HER Number	
Status	Listed Building: Grade II
Easting	549250
Northing	313049
Parish	West Walton
Council	Norfolk
Description	<p>WEST WALTON ST. PAUL'S ROAD TF 41 SE 2/71 Old Post Office II House. Early C18. Brick with thatched roof. T plan. One storey and dormer attic in symmetrical arrangement. C20 central door flanked by one renewed sash window left and right with glazing bars. 2 gabled dormers with C20 casements in gabled roof. Internal gable end stacks. Gabled cross wing to rear with C19 sashes with glazing bars to north and south. C20 window to rear. One bay single storeyed extension to south with thatched gabled roof.</p> <p>Listing NGR: TF4925013049</p>

Asset Number	8
Asset Name	TRINITY HALL
Type of Asset	Listed Building
Listing No./NRHE Number	1264136
HER Number	
Status	Listed Building: Grade II
Easting	552450
Northing	311474
Parish	Walpole Highway
Council	Norfolk
Description	WALPOLE ST. PETER TRINITY ROAD TF 51 SW

11/71 Trinity Hall

- II

House, c.1600, re-roofed 1880, restored and altered 1950. Brick with slate roof. Half H plan. 2 storeys. West facade of 3 central bays flanked by single bay projecting cross gables. Roll moulded set-off at first floor to whole facade. Gabled 1950 porch. One casement right and left and 3 to first floor, all iron casements of 1950. One window each floor to gable ends, casements as before. Gable heads on moulded brick kneelers. Gabled roofs, the main range with ridge stack right of centre. Cross wings project to rear, both with tumbling in heads. 2 ridge stacks to south wing, one to north wing. Fenestration and details C20. Enough internal evidence exists to show house originally a through passage plan. Solar winder stairwell survives in north wing, the stairs renewed. Jewel stopped spine beam and joists in lounge.

Listing NGR: TF5245011474

Asset Number	9
Asset Name	BANYER HALL
Type of Asset	Listed Building
Listing No./NRHE Number	1305587
HER Number	
Status	Listed Building: Grade II
Easting	549683
Northing	307937
Parish	Emneth
Council	Norfolk
Description	EMNETH LADY'S DROVE TF 40 NE 5/29 Banyer Hall 4.10.83 II House. Mid C17, restored 1985. Brick with plain tiled roofs. H plan. 1½ storeys. East facade of 3 bays between projecting gabled cross wings. Central C20 door flanked by one window right and left, all under segmental skewback arches. Single C20 window over door. 2 symmetrically placed through-eaves dormers with flat tops and C20 fenestration. Gabled roof with central square ridge stack carrying 4 square flues, the plinth repointed. North cross wing articulated by flat brick string courses at first floor and eaves level which continue into returns. One C20 window each floor. On south front C20 door left of centre and 3 C20 casements beneath gauged skewback arches. 4 flat-topped dormers with C20 details, 3 of which descend through eaves. Dentil eaves cornice. Gabled roof with internal gable end stacks. Outshut to rear of this wing pierced by C20 fenestration, as is rear of main range. Interior retains ovolo moulded spine beams and 2 inglenook fireplaces. South range originally service wing : 2 arched timber doorways survive within timber studded wall. Roof largely replaced 1985.

Listing NGR: TF4968307937

Asset Number	10
Asset Name	AUSTIN HOUSE
Type of Asset	Listed Building
Listing No./NRHE Number	1342384
HER Number	
Status	Listed Building: Grade II
