

— Application Site Boundary
— Adjacent Land in Client's Ownership

0m 10m 20m 30m 40m 50m

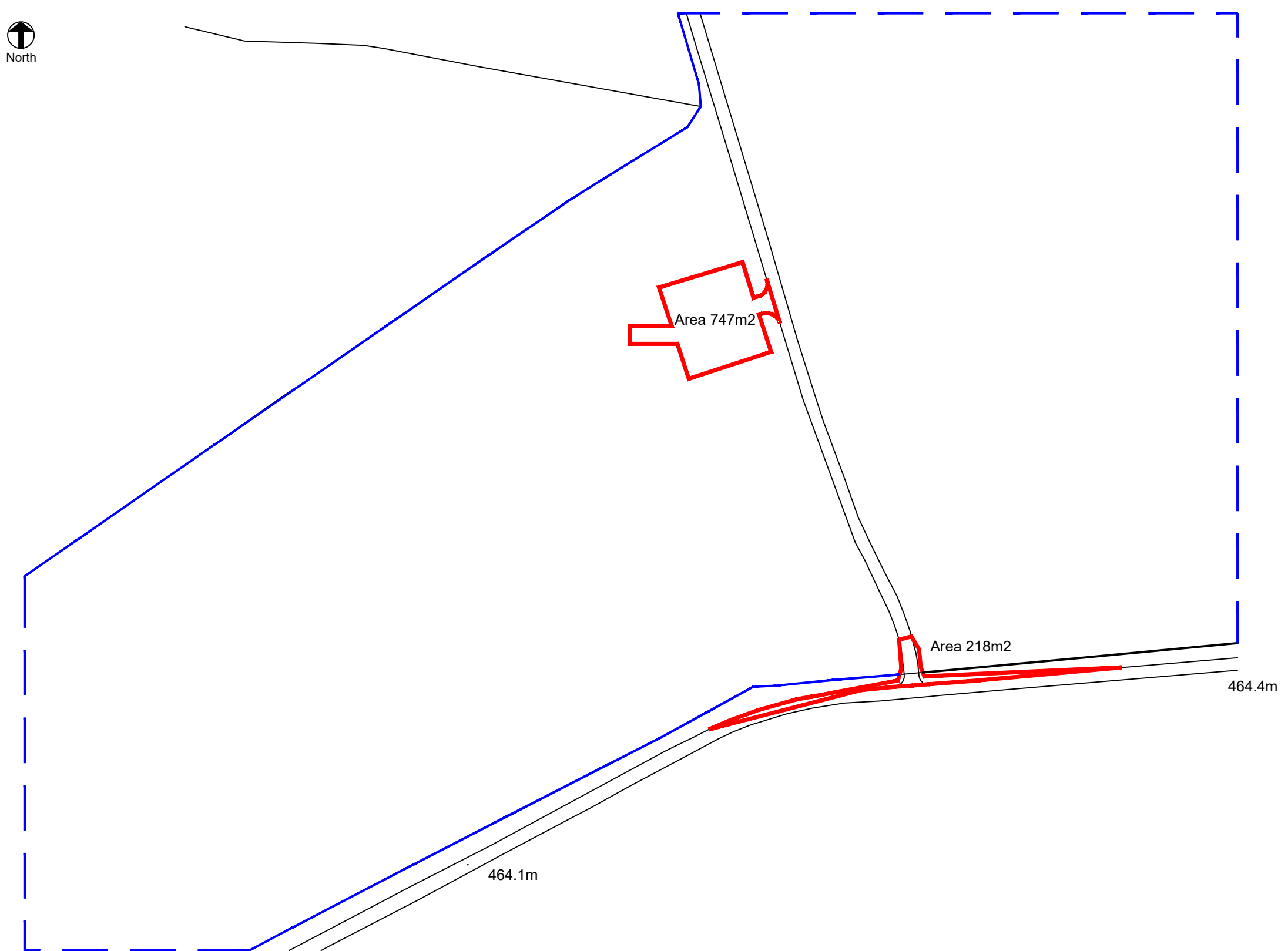

Ordnance Survey, (c) Crown Copyright 2022. All rights reserved. Licence number 100022432

THIS DRAWING IS TO BE READ IN CONJUNCTION WITH ALL RELATED DRAWINGS. ALL DIMENSIONS MUST BE CHECKED AND VERIFIED ON SITE BEFORE COMMENCING ANY WORK OR PRODUCING SHOP DRAWINGS. THE ORIGINATOR SHOULD BE NOTIFIED IMMEDIATELY OF ANY DISCREPANCY. THIS DRAWING IS COPYRIGHT AND REMAINS THE PROPERTY ROGER PARRY & PARTNERS.

Rev	Description	Date	By
-	-	year/mm/dd	--



Residential - Agricultural - Commercial

Project	Proposed Temporary Rural Enterprise Dwelling		
Drawing Title	Location Plan		
Location	Land at SY16 4PH (Grid ref E 316949, N 286993)		
Client	Paula Jones		
Scale	1:1250 @ A3		
Drawing No	76850 / GD / 001	Rev	-
Drawn By	NB	Date	2022/09/15

HOGSTOW HALL, MINSTERLEY
SHREWSBURY, SHROPSHIRE. SY5 0HZ
 Tel: 01743 791336 Fax: 01743 792770
 E-mail: mail@rogerparry.net
 Web address: www.rogerparry.net
Roger Parry & Partners LLP partnership no. OC312203
 Registered Office Hogstow Hall, Minsterley, Shrewsbury, SY5 0HZ
 Registered in England and Wales.
 A list of members of the LLP is available at the above address.