

SECTION AA Master Bedroom

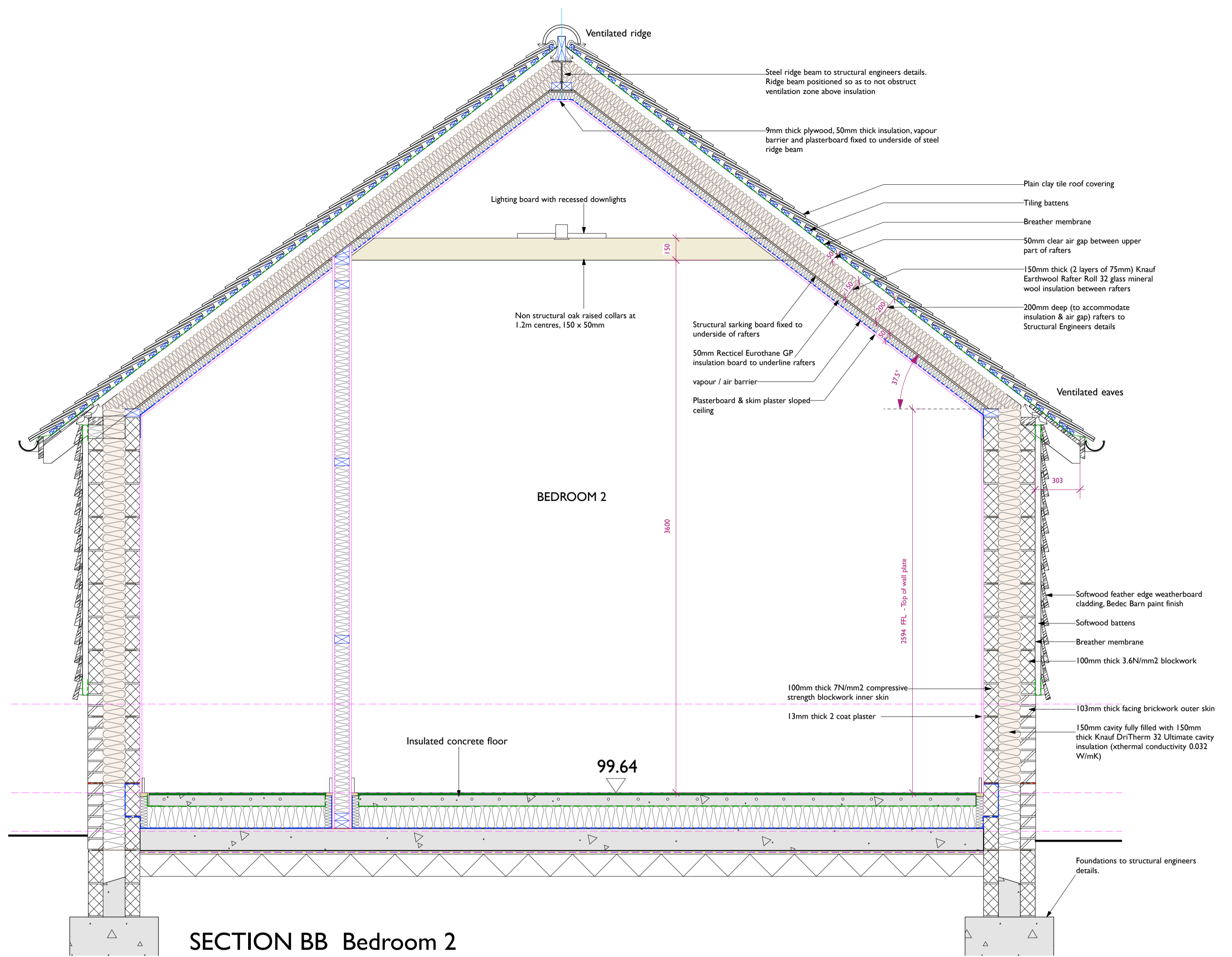

SECTION BB Bedroom 2

General Notes

- This drawing is to be read in conjunction with other engineers, designers, subcontractors and specialists drawings and any associated specifications and details. Any discrepancies are to be reported to the CA/client or relevant project manager before proceeding with the works.
- All workmanship and materials are to be carried out in accordance with current British Standards, Codes of Practice and good building practice.
- All work to be to the satisfaction of the Building Control checking authority.
- Do not scale this drawing. All dimensions to be as noted. Contractor to check all dimensions on site before carry out works.
- Where existing elements are exposed or investigated during the building works and are found to be not as assumed then contractor to confirm and notify CA/design team/client as applicable before proceeding with works.
- The contractor is responsible for site health & safety including taking all necessary precautions to ensure stability of both existing and proposed structures at all times during construction. Contractor to contact structural engineer immediately where any doubts arise on site.
- All services/utilities are to be located and protected as necessary by the contractor prior to the commencement of the works.
- This drawing is for the private and confidential use of the client for whom it was undertaken and it should not be reproduced in whole or in part or relied upon by third parties for any use without the express written authority of Beech Architects Limited.

RESIDUAL RISK TO HEALTH & SAFETY

Whilst we have made every attempt to design out risk associated with our design some risks may remain. Significant residual risks relating to our design are detailed below with our assessment of how these may be managed. The contractor remains responsible for identifying and managing risk associated with construction processes and site safety and these risks should be identified within the contractor's Construction Health & Safety Plan all operations carried out in accordance with HSE requirements, Current Code of Practice and compliance with CDY 2015 regulations.

Numbered triangles further highlight specific locations where residual risks remain:

- Access equipment for cleaning and maintenance will be required and works undertaken by qualified and competent person.
- The risks associated with working at height should be reduced by using appropriate scaffold, platforms, mobile elevating equipment, safety nets or fall arrest systems as deemed appropriate by the contractors review and assessment of the construction methodology & process.
- The locations of all existing services and utilities must be confirmed prior to commencement of the works.
- The engineer must be contacted immediately where unsure or concern raised regarding the stability of any structure.

NOTES:
ALL DIMENSIONS TO BE CHECKED ON SITE.
SUBJECT TO AND TO BE READ IN CONJUNCTION WITH STRUCTURAL ENGINEERS DETAILS
MC IS TO ENSURE THAT ALL DEMOLITIONS ARE CARRIED OUT IN STRICT COMPLIANCE WITH ALL CURRENT APPLICABLE HSE GUIDANCE INCLUDING REFURBISHMENT / DEMOLITION ASBESTOS SURVEY.
NOTE: BUILDING REGULATIONS CONSTRUCTION NOTES (INCLUDING DRAINAGE AND EXTERNAL WORKS) REFER TO DRAWING WD10

NEW GARDEN WALL TO COURTYARD

EXTERNAL WORKS
NEW GARDEN WALL TO COURTYARD Height: 1688mm (5' 6") high above ground level (comprised of 21 courses + coping). Thickness: 215mm Bricks: Michelmersh Hampshire Red Stock Multi. F2/S2 Grade, type TBC. Bond: English bond. Joints: Bucket handle Structural design including foundations & pier spacing / position all to Structural Engineers details. Special bricks to sites: LPL 10 Iststock Plinth stretcher & LPL 9 Iststock Plinth Header. Movement joints to Structural Engineers details. Max 6m centres, and max 3m from end of wall and max 3m from change of direction. Nom. 10mm Movement joint adj; pier to continue up through coping level and down to footing level. Wall ties with de-bonding sleeves installed to tie panels together. Compressible joint filler and low modulus silicone sealant to faces to match brick colour. Coping: Half round red clay brickwork to match F2/S2 Grade. Mortar mix: 3:1 (Sand:Cement) class II as NIBC table 6. Use Snowcrete white cement mortar, to imitate lime mortar. Foundations to Structural Engineers details.

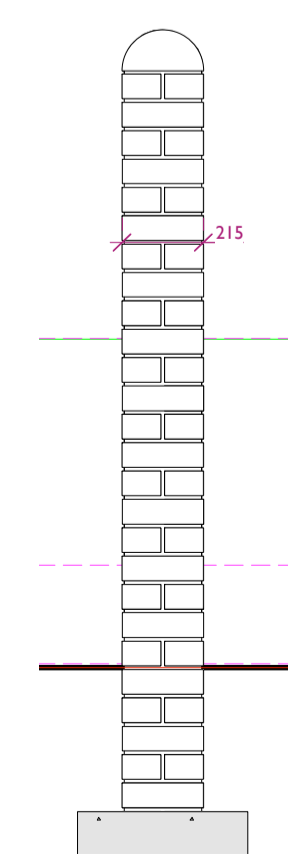
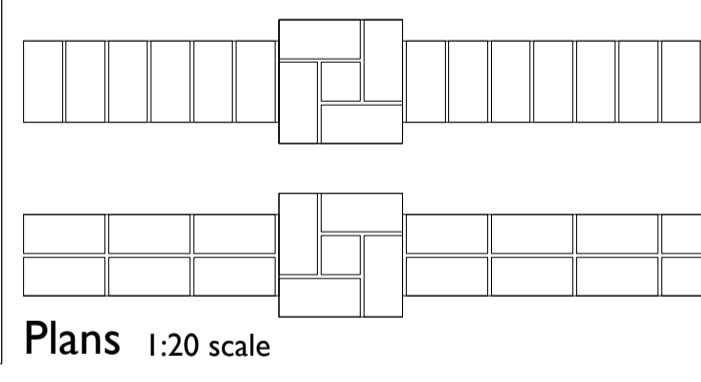

Wall Sections 1:20 scale

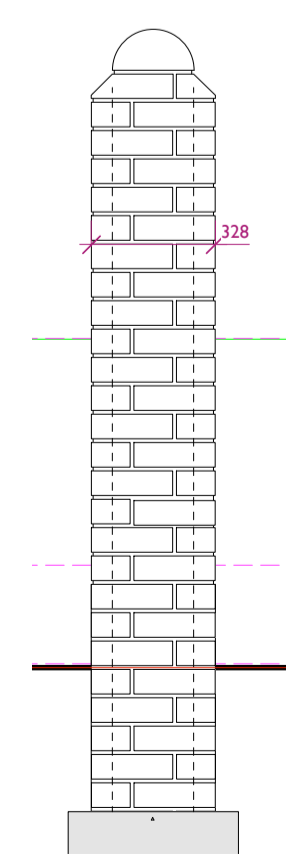

Pier

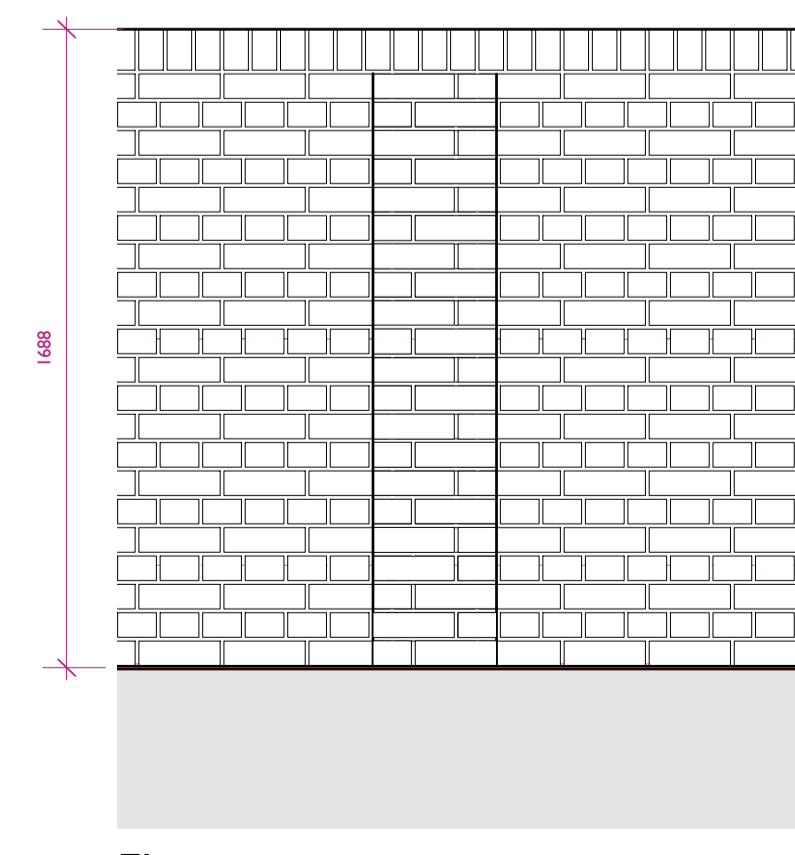

Elevation

P4	15 Sep22	Updated to suit Structural Engineers details - ridge beam added.
P3	8 Sep22	Updated to suit Structural Engineers details.
P2	5 Aug 22	Courtyard wall height amended.
Rev P1	1 Aug 22	Preliminary Issue

Beech ARCHITECTS
 Church Farm Barn
 The Street
 Thornodon
 Suffolk
 IP23 7JR
 www.beecharchitects.com
 enquiries@beecharchitects.com
 t 01379 678442

CLIENT
 Mr & Mrs Macklin

PROJECT
 Peacocks Barn
 Farley Green
 Suffolk
 CB8 8PX

DRAWING SECTIONS Sheet 2			
SCALE 1:20 @ A1	DATE MAR 2021	DRAWN BY	CHECKED
DRAWING NUMBER WD08	JOB NUMBER 564	STATUS Not For Construction	REV P4

This drawing is copyright and remains the property of Beech Architects Ltd. Original size A1. Scale shown will be incorrect if reproduced in any other format. All dimensions to be checked on site.