

The Old Bakery

Residential Garden.

Meadow Cottage

Roseley Barn  
Residential Garden.

The White Cottage

Corner Cottage

Garden store.  
Tree house.  
Circa 4m High.

Greenhouse.

**ENERGY EFFICIENCY :**

Energy Efficiency Savings over current Building Regulations.

Air Source Heat Pumps,  
Solar Panels,  
High insulated fabric of the dwellings.  
Electric Vehicle Charging Points.

Retained Paddock.

Circa 2 Acres.

Proposed Ecological Area.  
Circa 0.12 Hec. / 0.29 Acres.

Existing Electric overhead cables to be taken underground.

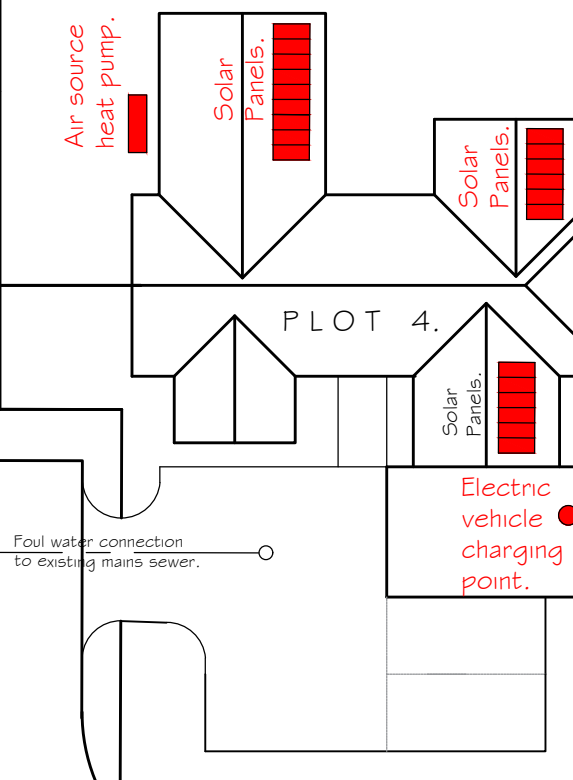
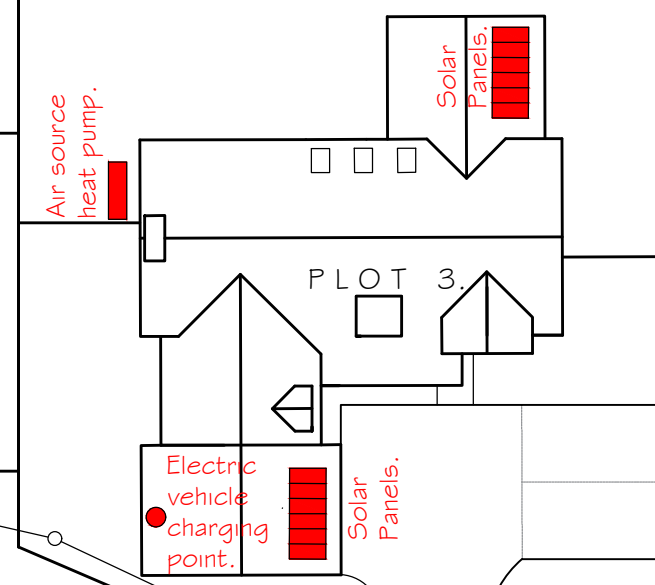
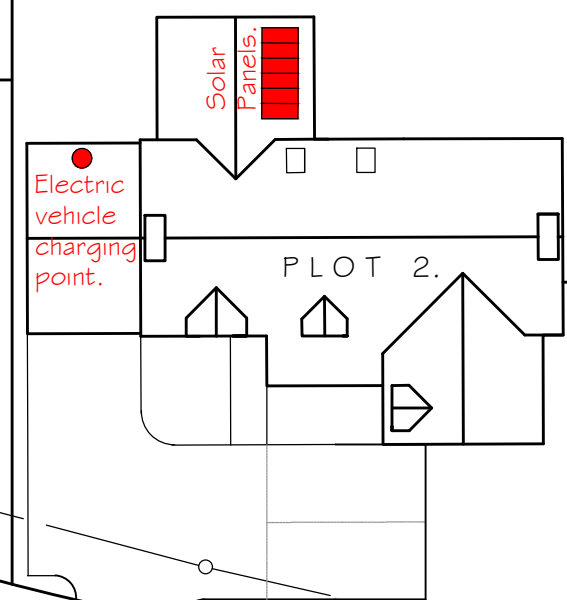
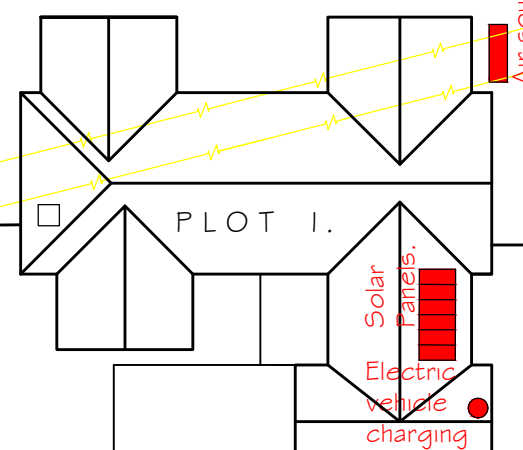

Footpath connection from application site to village centre / facilities.

William the Conqueror

CORNELLS LANE.

Residential Garden.

**INFRASTRUCTURE LAYOUT.**

Residential Garden.

Weft House

Footpath Connections.

REVISION	Rev. A. Revised Scheme July 22. To suit clients reqmts.
PROJECT	Proposed erection of 4No. Dwellings Land to the North of Cornells Lane, Widdington, Saffron Walden, Essex.
DESCRIPTION	Infrastructure Layout
CLIENT	Dr and Mrs. M. Tee.
DATE	Jan. 2021 1 / 250
<p>The Clarke Smith Partnership Architectural &amp; Planning Consultants 1, Chuck A Bush Farm Barn, Royston Road, Whittlesford, Cambridgeshire CB22 4NW. Tel 01223 830989</p>	
Drawing	P 5004 - 16 Rev A.

Pond

Definitive route of public footpath (currently unavailable over highway land).  
Potential indicative link between footpath and steps to Cornells Lane.