

© The content of this drawing is subject to the Copyright, Designs and Patents Act 1988. Reproduction of any part of this drawing is not permitted without written consent from Snug Architects Ltd.

OS (c) Crown Copyright 2022. All rights reserved. Licence No. 100022432. Snug Architects Landmark OS Paper Map Copying Licence No: LAN1000247

Do not scale from this drawing for construction purposes.

All dimensions must be checked by the contractor before commencing work on site.

Unless otherwise noted, boundaries have not been surveyed. The recipient of this drawing should satisfy themselves of their precise location before commencing work on site.

Any discrepancies are to be brought to the attention of Snug Architects Ltd.

If in doubt, ask.

Notes

- Demolished
- Existing

Note:  
Exact scope to be considered in connection with demolition plans and schedule of works

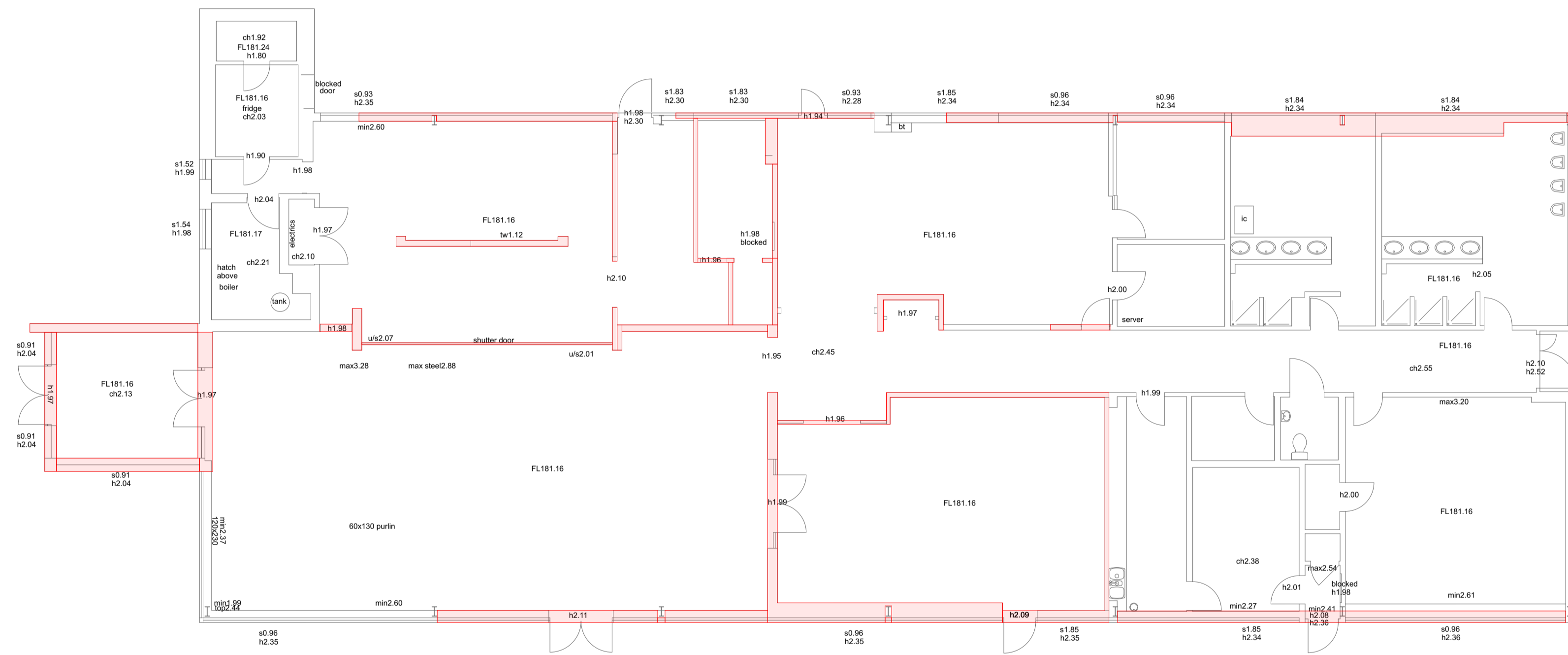

1 Existing Floor Plan - Demolition  
Scale 1:100

Rev	Date	Description	DB/CB
-----	------	-------------	-------



project  
Lasham Gliding Clubhouse  
The Avenue  
Alton  
GU34 5SS

status  
**Planning**

drawing title  
Existing Floor Plan - Demolition

drawn	checked	date	scale
BM	MW	11 2022	1:100 @ A1

Drawing Code						
Project	Originator	Vol	Lev	Type	Role	Number
P1108	SNUG	XX	XX	DR	A	0011 - 0

59 Rumbridge Street, info@snugarchitects.co.uk  
Totton, Southampton, www.snugarchitects.co.uk  
Hampshire SO40 9DR 02382 029500

